

PRELIMINARY GRADING AND EROSION & SEDIMENT CONTROL PLANS

FLUVANNA COUNTY PUBLIC LIBRARY

FLUVANNA COUNTY, VIRGINIA

Received
FEB 21 2007
Fluvanna County

APPROVED
FEB 21 2007
Fluvanna County
Planning Department

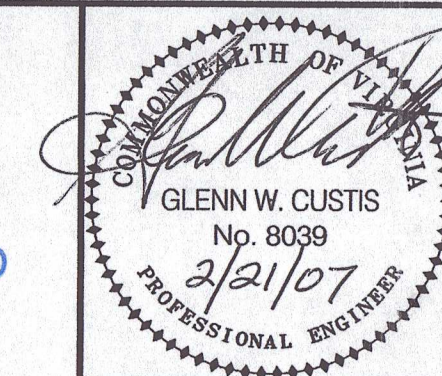

Glenn W. Custis

Draper Aden Associates
Engineering & Surveying & Environmental Services
Blacksburg, VA
Richmond, VA
Hampton Roads, VA
Charlottesville, VA
700 Harris Street, Suite E
Charlottesville, VA 22909
434-295-0700 Fax: 434-295-2105
www.daad.com

DRAWING LIST

SHT. NO.	DESCRIPTION
C0.1.....	TITLE SHEET
C0.2.....	GENERAL NOTES
C1.1.....	EXISTING CONDITIONS PLAN
C1.2.....	EROSION & SEDIMENT CONTROL PLAN
C2.1.....	GRADING & STORMWATER MANAGEMENT PLAN
C3.1.....	EROSION & SEDIMENT CONTROL DETAILS
C4.1.....	DRAINAGE PLAN

SITE SUMMARY

OWNER: Fluvanna County Board of Supervisors
P.O. Box 299
Palmyra, VA 22963

CONTACT: John Robins - Public Works Director
TELEPHONE: 434-591-1925
FAX: 434-291-1924

LOCATION: Rt. 53 - Pleasant Grove

JURISDICTION: Fluvanna County

PRESENT ZONING: County Park (CP)

PROPOSED USE: Public Library

LIST OF ABBREVIATIONS

A	AREA	MIN.	MINIMUM
AC	ACRE(S)	OP	OUTLET PROTECTION
AWWA	AMERICAN WATER WORKS ASSOCIATION	PB	PARCEL BOOK
CE	CONSTRUCTION ENTRANCE	PSI	POUNDS PER SQUARE INCH
CF	CUBIC FEET	PT	POINT OF TANGENCY
CG	CURB AND GUTTER	PVC	POLYVINYL CHLORIDE
CIP	CULVERT INLET PROTECTION	ROP	REINFORCED CONCRETE PIPE
CY	CUBIC YARD	R.D.	ROOF DRAIN
D.B.	DEED BOOK	R/W	RIGHT-OF-WAY
DC	DUST CONTROL	San.	SANITARY
DD	DIVERSION DIKE	S.F.	SQUARE FOOT (FEET)
D.I.	DUCTILE IRON	SF	SILT FENCE
DI	DROP INLET	SPEC.	SPECIFICATION
DIA	DIAMETER	SS	STREAM BANK STABILIZATION
DS	DOWNSPOUT	ST	STORM
EA	EACH	ST	SEDIMENT TRAP
EL	ELEVATION	STB	STRAW BALE BARRIER
EX.	EXISTING	STD.	STANDARD
FC	FACE OF CURB	SW	SIDEWALK
F.F.	FINISHED FLOOR	SY	SQUARE YARD
F.L.	FLOW LINE	TBM	TEMPORARY BENCH MARK
GS	GROUND SHOT	TC	TOP OF CURB
INV.	INVERT	TCF	TEMPORARY CONSTRUCTION FENCE
IP	INLET PROTECTION	TP	TREE PROTECTION
LAT	LATERAL	TYP.	TYPICAL
LF	LINEAR FOOT (FEET)	VDOT	VIRGINIA DEPARTMENT OF TRANSPORTATION
MAX.	MAXIMUM	VESCH	VIRGINIA EROSION AND SEDIMENT CONTROL HANDBOOK
MH	MANHOLE	VV	WATER VALVE

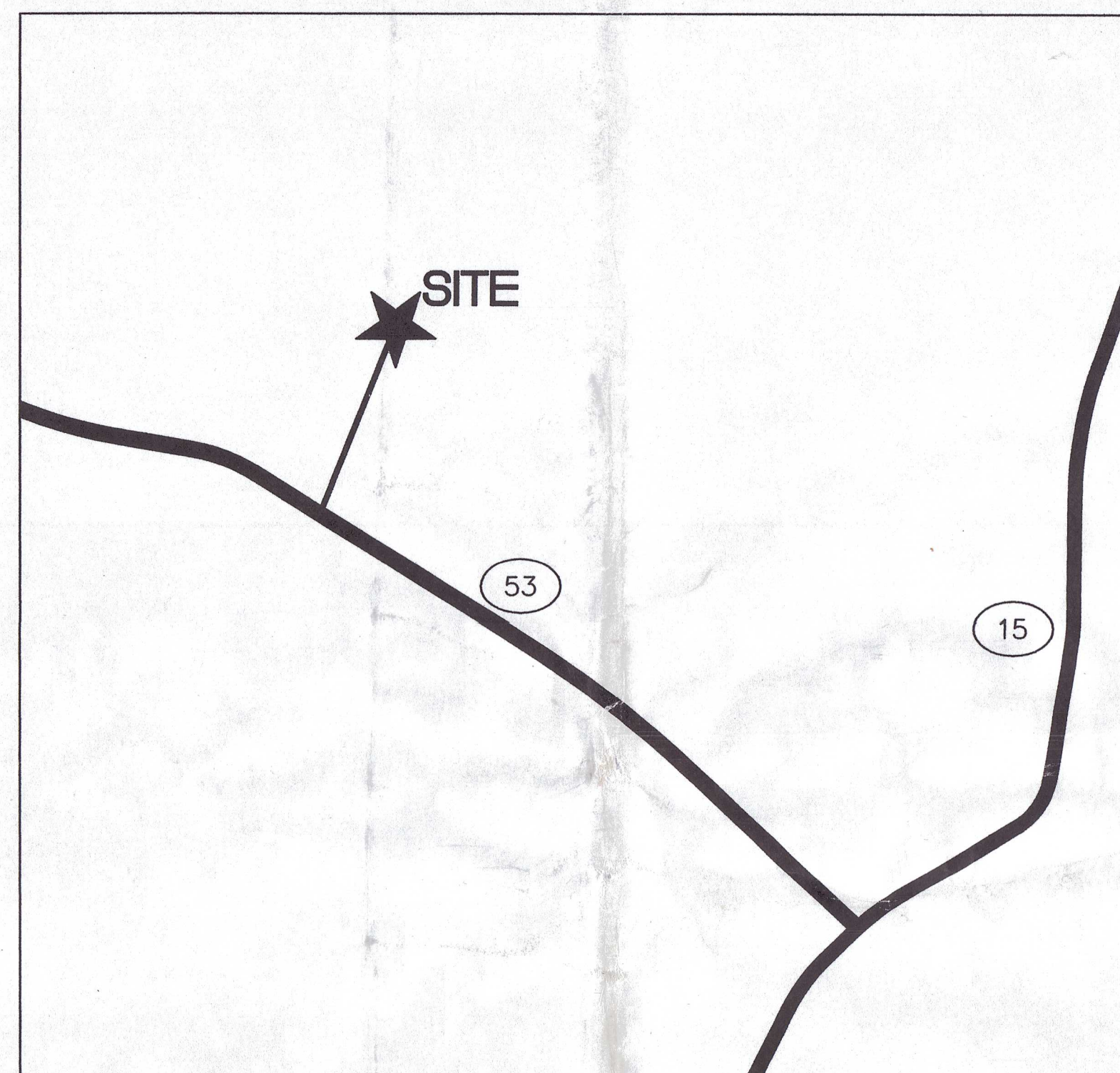

VICINITY MAP
NOT TO SCALE

GENERAL LEGEND

EXISTING FEATURES	
DECIDUOUS TREE	
EVERGREEN TREE	
FIRE HYDRANT	
WATER METER	
UNDERGROUND POWER LINE	— uge —
COMMUNICATIONS VAULT (CONCRETE)	
SANITARY SEWER MANHOLE	
SANITARY SEWER LINE (SIZE INDICATED ON PLAN)	— 8" SS —
SIGNS	
WATERLINE	— 8" W —
STORM SEWER LINE	====
STORM SEWER YARD INLETS	
STORM SEWER CURB INLETS	
STORM SEWER ENDWALL (CONCRETE)	—
RIPRAP	
BIRD HOUSE	
CONCRETE	
CURB/GUTTER	====
5' CONTOUR LINES	— 450 —
1' CONTOUR LINES	— 100 —
UNDERGROUND GAS LINE (SIZE INDICATED ON PLAN)	— 4" G —
PROPOSED FEATURES	
STORM DRAIN & MANHOLE	
STORM DRAIN END SECTION (ES-1)	
STORM DRAIN INLETS	
SANITARY SEWER & MANHOLE	— SS — O — SS —
CLEANOUT	
WATERLINE (SIZE)	— 4" W —
WATER VALVE	
FIRE HYDRANT	
CONTOUR LINE	— 100 —
ASPHALT PAVEMENT	
SIGN	

APPROVALS

DEPARTMENT OF PLANNING AND COMMUNITY DEVELOPMENT _____

DEPARTMENT OF PUBLIC WORKS _____

FIRE OFFICER _____

VIRGINIA DEPARTMENT OF HEALTH _____

BUILDING OFFICIAL _____

ORIGINAL DATE OF PLANS:
FEBRUARY 9, 2006

DAA PROJECT # CV06175-01

These documents, including drawings and specifications, were prepared by Draper Aden Associates, Consulting Engineers, pursuant to a contract by and between Draper Aden Associates and Fluvanna County with respect to the project described in said contract. Any reuse or modification of said documents (whether hard copy or electronic) without written verification or adaptation by Draper Aden Associates for the specific purpose intended will be at the sole risk of the individual or entity utilizing said documents, drawings and specifications and such use is without the authorization of Draper Aden Associates. Draper Aden Associates, Consulting Engineers, shall have no legal liability resulting from any and all claims, damages, losses, and expenses, including attorney's fees arising out of the unauthorized use of these documents, drawings, specifications, reports, and studies prepared as a result of the aforesaid contract.

NOTE: CONTRACTOR TO CONTACT MISS UTILITY (1-800-552-7001) AT LEAST 3 WORKING DAYS IN ADVANCE OF PLANNED WORK.



TITLE SHEET
FLUVANNA COUNTY PUBLIC LIBRARY
FLUVANNA COUNTY, VIRGINIA

REVISIONS
2/9/07 PRELIMINARY SUBMISSION
2/19/07 PER E&S COMMENTS

DESIGNED BY: GWC
DRAWN BY: GCJ
CHECKED BY: GWC
SCALE: NOT TO SCALE
DATE: FEBRUARY 19, 2007
PROJECT NUMBER: CV06175-01

C0.1

EROSION AND SEDIMENT CONTROL NOTES

1. **ES-1.** UNLESS OTHERWISE INDICATED, ALL VEGETATIVE AND STRUCTURAL EROSION AND SEDIMENT CONTROL PRACTICES SHALL BE CONSTRUCTED AND MAINTAINED ACCORDING TO MINIMUM STANDARDS AND SPECIFICATIONS OF THE VIRGINIA EROSION AND SEDIMENT CONTROL HANDBOOK AND VIRGINIA REGULATIONS VR 4VAC50-30 EROSION AND SEDIMENT CONTROL REGULATIONS.
2. **ES-2.** THE DIVISION OF SOIL AND WATER CONSERVATION OF THE DEPARTMENT OF CONSERVATION AND RECREATION MUST BE NOTIFIED (804-527-4206) ONE WEEK PRIOR TO THE PRE-CONSTRUCTION CONFERENCE, ONE WEEK PRIOR TO THE COMMENCEMENT OF LAND DISTURBING ACTIVITY, AND ONE WEEK PRIOR TO THE FINAL INSPECTION.
3. **ES-3.** ALL EROSION AND SEDIMENT CONTROL MEASURES SHALL BE PLACED PRIOR TO OR AS THE FIRST STEP IN CLEARING, GRADING OR LAND-DISTURBING AND SEQUENCE OF CONSTRUCTION APPROVED.
4. **ES-4.** A COPY OF THE APPROVED EROSION AND SEDIMENT CONTROL PLAN SHALL BE MAINTAINED ON THE SITE AT ALL TIMES.
5. **ES-5.** PRIOR TO LAND DISTURBING ACTIVITIES IN AREAS OTHER THAN INDICATED ON THESE PLANS OR OFF-SITE FILL ACTIVITIES, SUBMIT A SUPPLEMENTARY EROSION CONTROL PLAN TO THE OWNER FOR REVIEW AND APPROVAL BY THE DEPARTMENT OF CONSERVATION AND RECREATION/DIVISION OF SOIL AND WATER CONSERVATION.
6. **ES-6.** INSTALL ADDITIONAL EROSION CONTROL MEASURES AS NECESSARY TO PREVENT EROSION AND SEDIMENTATION AS DETERMINED BY THE DIVISION OF SOIL AND WATER CONSERVATION OF THE DEPARTMENT OF CONSERVATION AND RECREATION.
7. **ES-7.** SITE GRADING SHALL DRAIN TO THE PERIMETER CONTROLS AT ALL TIMES DURING LAND DISTURBING ACTIVITIES AND DURING CONSTRUCTION, UNTIL FINAL STABILIZATION IS ACHIEVED.
8. **ES-9.** INSPECT ALL EROSION CONTROL MEASURES PERIODICALLY (AT LEAST DAILY) AND AFTER EACH RUNOFF-PRODUCING RAINFALL EVENT. ALL NECESSARY REPAIRS OR CLEANUP TO MAINTAIN THE EFFECTIVENESS OF THE EROSION CONTROL DEVICES SHALL BE MADE IMMEDIATELY. MAINTAIN A LOG OF INSPECTIONS, MAINTENANCE PERFORMED AND REPAIRS MADE FOR INSPECTION BY THE OWNER AND THE DEPARTMENT OF CONSERVATION AND RECREATION/DIVISION OF SOIL AND WATER CONSERVATION.
1. **MS-1.** PERMANENT OR TEMPORARY SOIL STABILIZATION SHALL BE APPLIED TO DENUDED AREAS WITHIN SEVEN DAYS AFTER FINAL GRADE IS REACHED ON ANY PORTION OF THE SITE. TEMPORARY SOIL STABILIZATION SHALL BE APPLIED WITHIN SEVEN DAYS TO DENUDED AREAS THAT MAY NOT BE AT FINAL GRADE BUT WILL REMAIN DORMANT (UNDISTURBED) FOR LONGER THAN 30 DAYS. PERMANENT STABILIZATION SHALL BE APPLIED TO AREAS THAT ARE TO BE LEFT DORMANT FOR MORE THAN ONE YEAR.
2. **MS-2.** DURING CONSTRUCTION OF THE PROJECT, SOIL STOCKPILES SHALL BE STABILIZED OR PROTECTED WITH SEDIMENT TRAPPING MEASURES. COORDINATE & MAINTAIN TEMPORARY PROTECTION AND PERMANENT STABILIZATION OF ALL SOIL STOCKPILES ON SITE AS WELL AS SOIL INTENTIONALLY TRANSPORTED FROM THE PROJECT SITE.
3. **MS-3.** A PERMANENT VEGETATIVE COVER SHALL BE ESTABLISHED ON DENUDED AREAS NOT OTHERWISE PERMANENTLY STABILIZED. PERMANENT VEGETATION SHALL NOT BE CONSIDERED ESTABLISHED UNTIL A GROUND COVER IS ACHIEVED THAT, IN THE OPINION OF THE DIVISION OF SOIL AND WATER CONSERVATION OF THE DEPARTMENT OF CONSERVATION AND RECREATION, IS UNIFORM, MATURE ENOUGH TO SURVIVE AND WILL INHIBIT EROSION.
4. **MS-7.** CUT AND FILL SLOPES SHALL BE DESIGNED AND CONSTRUCTED IN A MANNER THAT WILL MINIMIZE EROSION. SLOPES THAT ARE FOUND TO BE ERODING EXCESSIVELY WITHIN ONE YEAR OF PERMANENT STABILIZATION SHALL BE PROVIDED WITH ADDITIONAL SLOPE STABILIZING MEASURES UNTIL THE PROBLEM IS CORRECTED.
5. **MS-10.** ALL STORM SEWER INLETS THAT ARE MADE OPERABLE DURING CONSTRUCTION SHALL BE PROTECTED SO THAT SEDIMENT-LADEN WATER CANNOT ENTER THE CONVEYANCE SYSTEM WITHOUT FIRST BEING FILTERED OR OTHERWISE TREATED TO REMOVE SEDIMENT.
6. **MS-16.** UNDERGROUND UTILITY LINES SHALL BE INSTALLED IN ACCORDANCE WITH THE FOLLOWING STANDARDS IN ADDITION TO OTHER APPLICABLE CRITERIA:
 - A. NO MORE THAN 500 LINEAR FEET OF TRENCH MAY BE OPENED AT ONE TIME. (SEE SHEET C1.06 FOR NOTES ON PERIMETER DRAIN.)
 - B. EXCAVATED MATERIAL SHALL BE PLACED ON THE UPHILL SIDE OF TRENCHES.
 - C. EFFLUENT FROM DEWATERING OPERATIONS SHALL BE FILTERED OR PASSED THROUGH AN APPROVED SEDIMENT TRAPPING DEVICE, OR BOTH, AND DISCHARGED IN A MANNER THAT DOES NOT ADVERSELY AFFECT OFF SITE PROPERTY.
 - D. MATERIAL USED FOR BACKFILLING TRENCHES SHALL BE PROPERLY COMPACTED IN ORDER TO MINIMIZE EROSION AND PROMOTE STABILIZATION.
 - E. RESTABILIZATION SHALL BE ACCOMPLISHED IN ACCORDANCE WITH THESE REGULATIONS.
 - F. APPLICABLE SAFETY REGULATIONS SHALL BE COMPLIED WITH.
7. **MS-17.** WHERE CONSTRUCTION VEHICLE ACCESS ROUTES INTERSECT PAVED PUBLIC ROADS, PROVISIONS SHALL BE MADE TO MINIMIZE THE TRANSPORT OF SEDIMENT BY VEHICULAR TRAFFIC ONTO THE PAVED SURFACES. WHERE SEDIMENT IS TRANSPORTED ONTO A PUBLIC ROAD SURFACE, THE ROAD SHALL BE CLEANED THOROUGHLY AT THE END OF EACH DAY. SEDIMENT SHALL BE REMOVED FROM THE ROADS BY SHOVELING OR SWEEPING AND TRANSPORTED TO A SEDIMENT CONTROL DISPOSAL AREA. STREET WASHING SHALL BE ALLOWED ONLY AFTER SEDIMENT IS REMOVED IN THIS MANNER.
8. **MS-18.** ALL TEMPORARY EROSION CONTROL MEASURES SHALL BE REMOVED WITHIN 30 DAYS AFTER FINAL SITE STABILIZATION IS ACHIEVED, AS DETERMINED BY THE DIVISION OF SOIL AND WATER CONSERVATION OF THE DEPARTMENT OF CONSERVATION AND RECREATION.

GENERAL EROSION CONTROL NOTES

9. **MS-19.** PROPERTIES AND WATERWAYS DOWNSTREAM FROM DEVELOPMENT SITES SHALL BE PROTECTED FROM SEDIMENT DEPOSITION, EROSION AND DAMAGE DUE TO INCREASES IN VOLUME, VELOCITY AND PEAK FLOW RATE OF STORMWATER RUNOFF FOR THE STATED FREQUENCY STORM OF 24-HOUR DURATION IN ACCORDANCE WITH THE FOLLOWING STANDARDS AND CRITERIA:
 - A. CONCENTRATED STORMWATER RUNOFF LEAVING A DEVELOPMENT SITE SHALL BE DISCHARGED DIRECTLY INTO AN ADEQUATE NATURAL OR MAN-MADE RECEIVING CHANNEL, PIPE OR STORM SEWER SYSTEM. FOR THOSE SITES WHERE RUNOFF IS DISCHARGED INTO A PIPE OR PIPE SYSTEM, DOWNSTREAM STABILITY ANALYSES AT THE OUTFALL OF THE PIPE OR PIPE SYSTEM SHALL BE PERFORMED.
 - B. ADEQUACY OF ALL CHANNELS AND PIPES SHALL BE VERIFIED IN THE FOLLOWING MANNER:
 - (1) THE APPLICANT SHALL DEMONSTRATE THAT THE TOTAL DRAINAGE AREA TO THE POINT OF ANALYSIS WITHIN THE CHANNEL IS ONE HUNDRED TIMES GREATER THAN THE CONTRIBUTING DRAINAGE AREA OF THE PROJECT IN QUESTION; OR
 - (2) (a) NATURAL CHANNELS SHALL BE ANALYZED BY THE USE OF A TWO-YEAR STORM TO VERIFY THAT STORMWATER WILL NOT OVERTOP CHANNEL BANKS NOR CAUSE EROSION OF CHANNEL BED OR BANKS; AND
 - (b) ALL PREVIOUSLY CONSTRUCTED MAN-MADE CHANNELS SHALL BE ANALYZED BY THE USE OF A TEN-YEAR STORM TO VERIFY THAT STORMWATER WILL NOT OVERTOP ITS BANKS AND BY THE USE OF A TWO-YEAR STORM TO DEMONSTRATE THAT STORMWATER WILL NOT CAUSE EROSION OF CHANNEL BED OR BANKS; AND
 - (c) PIPES AND STORM SEWER SYSTEMS SHALL BE ANALYZED BY THE USE OF A TEN-YEAR STORM TO VERIFY THAT STORMWATER WILL BE CONTAINED WITHIN THE PIPE OR SYSTEM.
 - C. IF EXISTING NATURAL RECEIVING CHANNELS OR PREVIOUSLY CONSTRUCTED MAN-MADE CHANNELS OR PIPES ARE NOT ADEQUATE, THE APPLICANT SHALL:
 - (1) IMPROVE THE CHANNEL TO A CONDITION WHERE A TEN-YEAR STORM WILL NOT OVERTOP THE BANKS AND A TWO-YEAR STORM WILL NOT CAUSE EROSION TO THE CHANNEL BED OR BANKS; OR
 - (2) IMPROVE THE PIPE OR PIPE SYSTEM TO A CONDITION WHERE THE TEN-YEAR STORM IS CONTAINED WITHIN THE APPURTENANCES; OR
 - (3) DEVELOP A SITE DESIGN THAT WILL NOT CAUSE THE PRE-DEVELOPMENT PEAK RUNOFF RATE FROM A TWO-YEAR STORM TO INCREASE WHEN RUNOFF OUTFALLS INTO A NATURAL CHANNEL OR WILL NOT CAUSE THE PRE-DEVELOPMENT PEAK RUNOFF RATE FROM A TEN-YEAR STORM TO INCREASE WHEN RUNOFF OUTFALLS INTO A MAN-MADE CHANNEL; OR
 - (4) PROVIDE A COMBINATION OF CHANNEL IMPROVEMENT, STORMWATER DETENTION OR OTHER MEASURES WHICH IS SATISFACTORY TO THE PLAN-APPROVING AUTHORITY TO PREVENT DOWNSTREAM EROSION.
 - D. THE APPLICANT SHALL PROVIDE EVIDENCE OF PERMISSION TO MAKE THE IMPROVEMENTS.
 - E. ALL HYDROLOGIC ANALYSES SHALL BE BASED ON THE EXISTING WATERSHED CHARACTERISTICS AND THE ULTIMATE DEVELOPMENT OF THE SUBJECT PROJECT.
 - F. THE APPLICANT CHOOSES AN OPTION THAT INCLUDES STORMWATER DETENTION, HE SHALL OBTAIN APPROVAL FROM THE LOCALITY OF A PLAN FOR MAINTENANCE OF THE DETENTION FACILITIES. THE PLAN SHALL SET FORTH THE MAINTENANCE REQUIREMENTS OF THE FACILITY AND THE PERSON RESPONSIBLE FOR PERFORMING THE MAINTENANCE.
 - G. OUTFALL FROM A DETENTION FACILITY SHALL BE DISCHARGED TO A RECEIVING CHANNEL, AND ENERGY DISSIPATORS SHALL BE PLACED AT THE OUTFALL OF ALL DETENTION FACILITIES AS NECESSARY TO PROVIDE A STABILIZED TRANSITION FROM THE FACILITY TO THE RECEIVING CHANNEL.
 - H. ALL ON-SITE CHANNELS MUST BE VERIFIED TO BE ADEQUATE. INCREASED VOLUMES OF SHEET FLOWS THAT MAY CAUSE EROSION OR SEDIMENTATION ON ADJACENT PROPERTY SHALL BE DIVERTED TO A STABLE OUTLET, ADEQUATE CHANNEL, PIPE OR PIPE SYSTEM, OR TO A DETENTION FACILITY.
 - J. IN APPLYING THESE STORMWATER RUNOFF CRITERIA, INDIVIDUAL LOTS OR PARCELS IN A RESIDENTIAL, COMMERCIAL OR INDUSTRIAL DEVELOPMENT SHALL NOT BE CONSIDERED TO BE SEPARATE DEVELOPMENT PROJECTS. INSTEAD, THE DEVELOPMENT, AS A WHOLE, SHALL BE CONSIDERED TO BE A SINGLE DEVELOPMENT PROJECT. HYDROLOGIC PARAMETERS THAT REFLECT THE ULTIMATE DEVELOPMENT CONDITION SHALL BE USED IN ALL ENGINEERING CALCULATIONS.
 - K. ALL MEASURES USED TO PROTECT PROPERTIES AND WATERWAYS SHALL BE EMPLOYED IN A MANNER WHICH MINIMIZES IMPACTS ON THE PHYSICAL, CHEMICAL AND BIOLOGICAL INTEGRITY OF RIVERS, STREAMS AND OTHER WATERS OF THE STATE.

MAINTENANCE NOTE

ALL EROSION CONTROL DEVICES SHALL BE MAINTAINED PER THE VESCH STANDARDS AND SPECIFICATIONS.

1. RETAIN A COPY OF THE VIRGINIA EROSION AND SEDIMENT CONTROL HANDBOOK, 3RD EDITION ON SITE AT ALL TIMES.
2. ADHERE TO THE STANDARDS LISTED IN THE VIRGINIA EROSION AND SEDIMENT CONTROL HANDBOOK, 3RD EDITION.

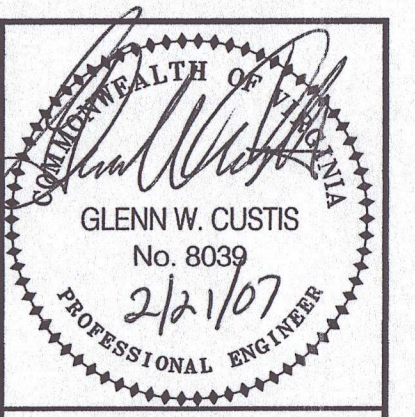

Draper Aden Associates
 Engineering • Surveying • Environmental Services
 Charlottesville, VA
 700 Harris Street, Suite E-103
 434-295-0700 Fax: 434-295-5105
 www.daa.com

Blackburg, VA
 Richmond, VA
 Hampton Roads, VA

GENERAL NOTES
FLUVANNA COUNTY PUBLIC LIBRARY
 FLUVANNA COUNTY, VIRGINIA

REVISIONS	
2/9/07	PRELIMINARY SUBMISSION
2/19/07	PER E&S COMMENTS
DESIGNED BY:	GWC
DRAWN BY:	GCJ
CHECKED BY:	GWC
SCALE:	NOT TO SCALE
DATE:	FEBRUARY 19, 2007
PROJECT NUMBER:	CV06175-01
C0.2	

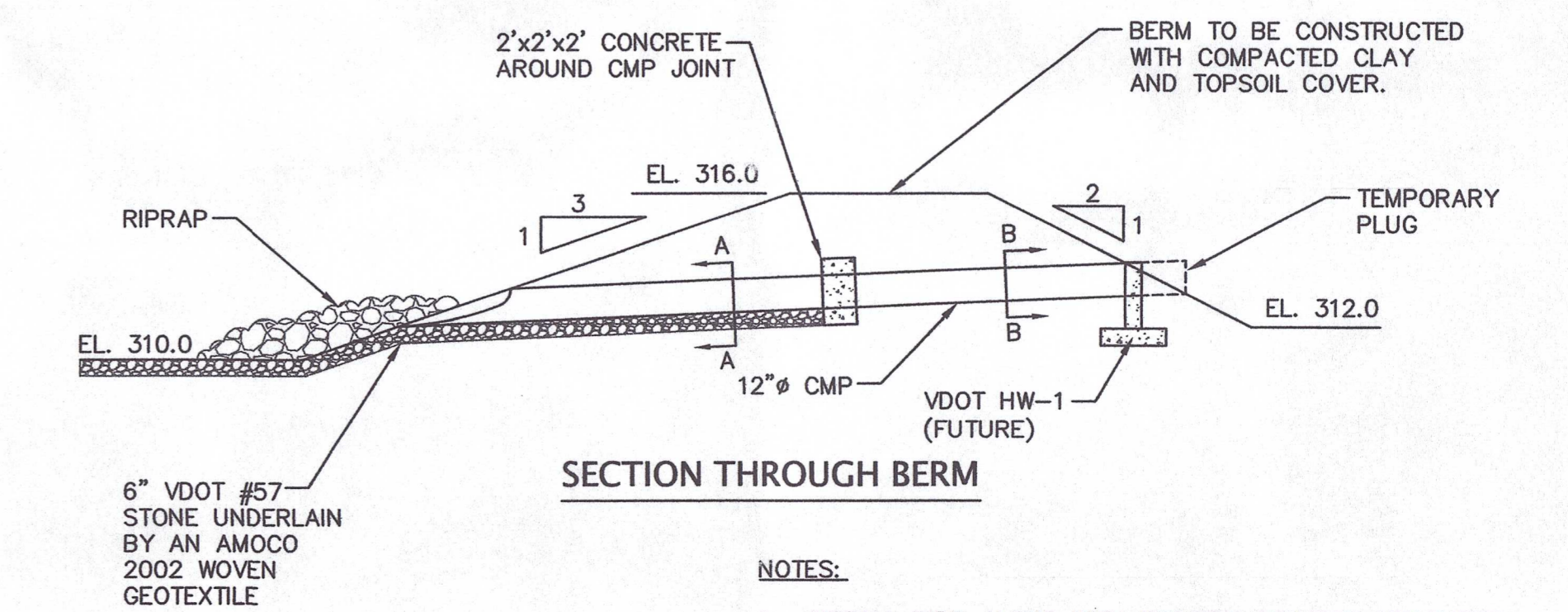
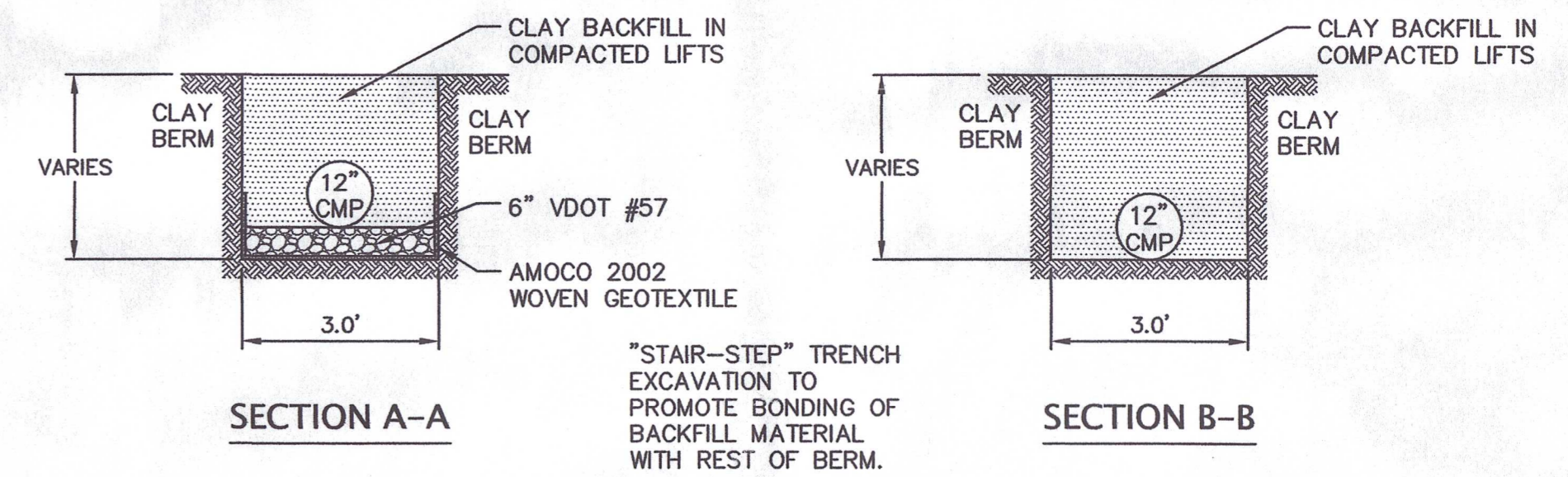

- NOTES:**
1. INSTALL PIPE ALONG WITH EROSION CONTROL MEASURES.
 2. PLUG END OF PIPE INTO SEDIMENT TRAP.
 3. UPON CONVERSION OF SEDIMENT TRAP TO STORMWATER MANAGEMENT FACILITY, TRIM PLUGGED END OF PIPE AND INSTALL HEADWALL.

1
C0.2
STORMWATER POND OUTLET PIPE DETAIL

P:\C06175\00\06175 Fluvanna County Library\C06175-01\DWG\06175-01.dwg (2/19/07) 2:19:40 PM

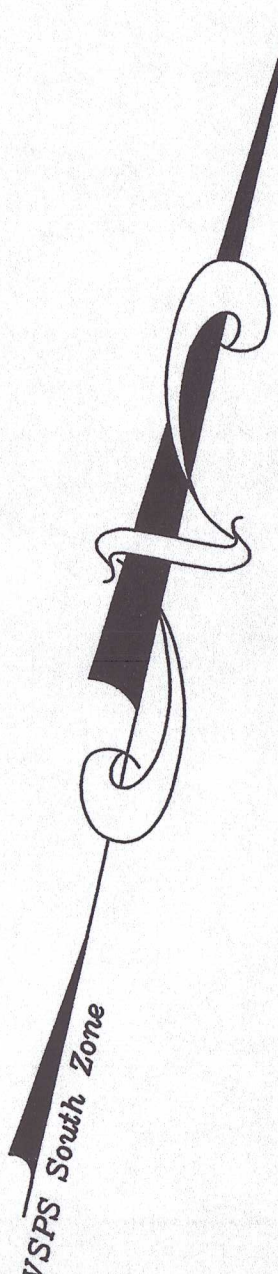

SURVEY LIMITS

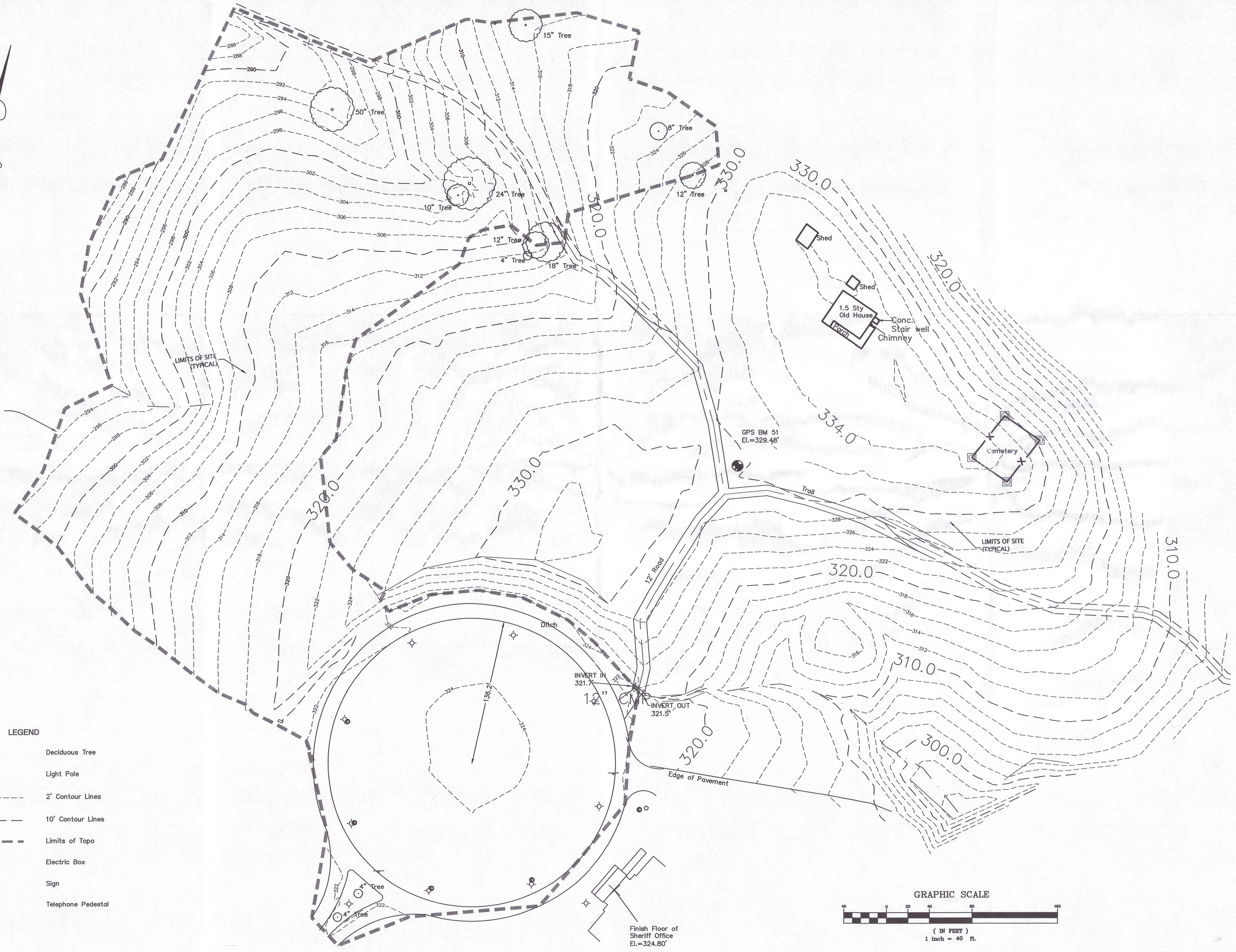

LEGEND

- Deciduous Tree
- Light Pole
- 2' Contour Lines
- 10' Contour Lines
- Limits of Topo
- Electric Box
- Sign
- Telephone Pedestal

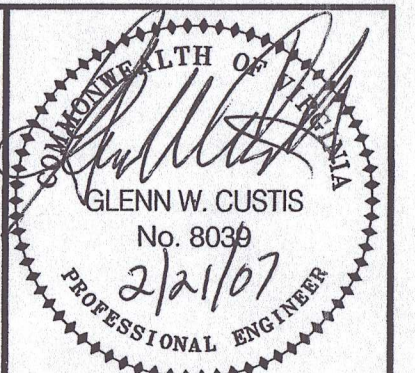
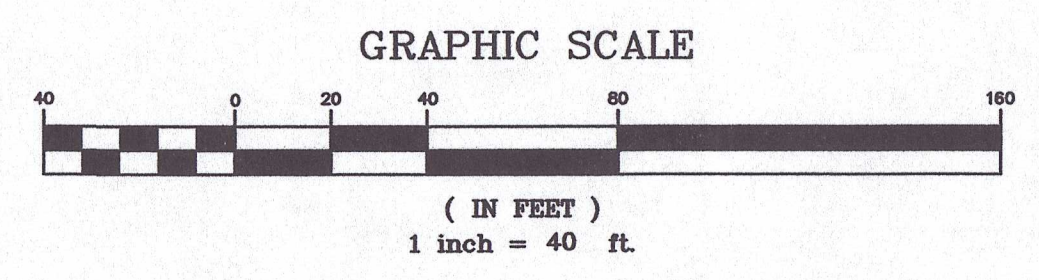

Draper Aden Associates
 Engineering • Surveying • Environmental Services
 Charlottesville, VA
 700 Harris Street, Suite E
 Charlottesville, VA 22905
 434-258-0700
 www.daa.com

Blackburg, VA
 Richmond, VA
 Hampton Roads, VA



EXISTING CONDITIONS PLAN
FLUVANNA COUNTY PUBLIC LIBRARY
 FLUVANNA COUNTY, VIRGINIA

REVISIONS	
2/9/07	PRELIMINARY SUBMISSION
2/19/07	PER E&S COMMENTS
DESIGNED BY:	DAA
DRAWN BY:	GCJ
CHECKED BY:	GWC
SCALE:	1" = 40'
DATE:	FEBRUARY 19, 2007
PROJECT NUMBER:	CV06175-01

C1.1

EROSION & SEDIMENT CONTROL LEGEND

No.	TITLE	KEY	SYMBOL
3.02	TEMPORARY STONE CONSTRUCTION ENTRANCE	CE	
3.05	SILT FENCE	SF	
3.07	STORM DRAIN INLET PROTECTION	IP	
3.08	CULVERT INLET PROTECTION	CIP	
3.09	TEMPORARY DIVERSION DIKE	DD	
3.10	TEMPORARY FILL DIVERSION	FD	
3.13	SEDIMENT TRAP	ST	
3.15	TEMPORARY SLOPE DRAIN	TSD	
3.18	OUTLET PROTECTION	OP	
3.31	TEMPORARY SEEDING	TS	
3.32	PERMANENT SEEDING	PS	
3.36	SOIL STABILIZATION BLANKETS & MATTING	B/M	
3.38	TREE PRESERVATION AND PROTECTION	TP	

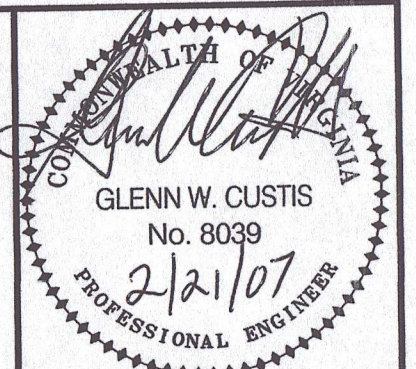

Draper Aden Associates
 Engineering + Surveying + Environmental Services
 Blacksburg, VA
 Richmond, VA
 Hampton Roads, VA

Charlottesville, VA
 700 Harris Street, Suite 200
 434-295-0700 Fax: 434-295-2105
 www.daa.com

**EROSION AND SEDIMENT CONTROL PLAN
 FLUVANNA COUNTY PUBLIC LIBRARY
 FLUVANNA COUNTY, VIRGINIA**

REVISIONS

2/9/07	PRELIMINARY SUBMISSION
2/19/07	PER E&S COMMENTS

DESIGNED BY:	DAA
DRAWN BY:	JAC
CHECKED BY:	GWC
SCALE:	1" = 40'
DATE:	FEBRUARY 19, 2007
PROJECT NUMBER:	CV06175-01

C1.2

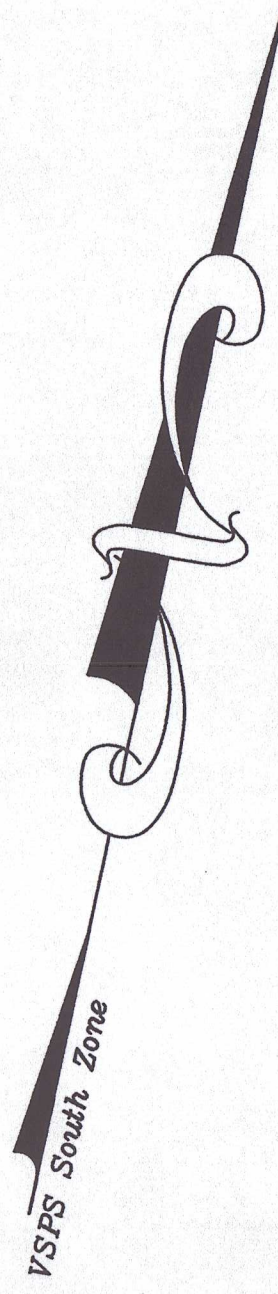

SURVEY LIMITS

LEGEND

- Deciduous Tree
- Light Pole
- 2' Contour Lines
- 10' Contour Lines
- Limits of Topo
- Electric Box
- Sign
- Telephone Pedestal

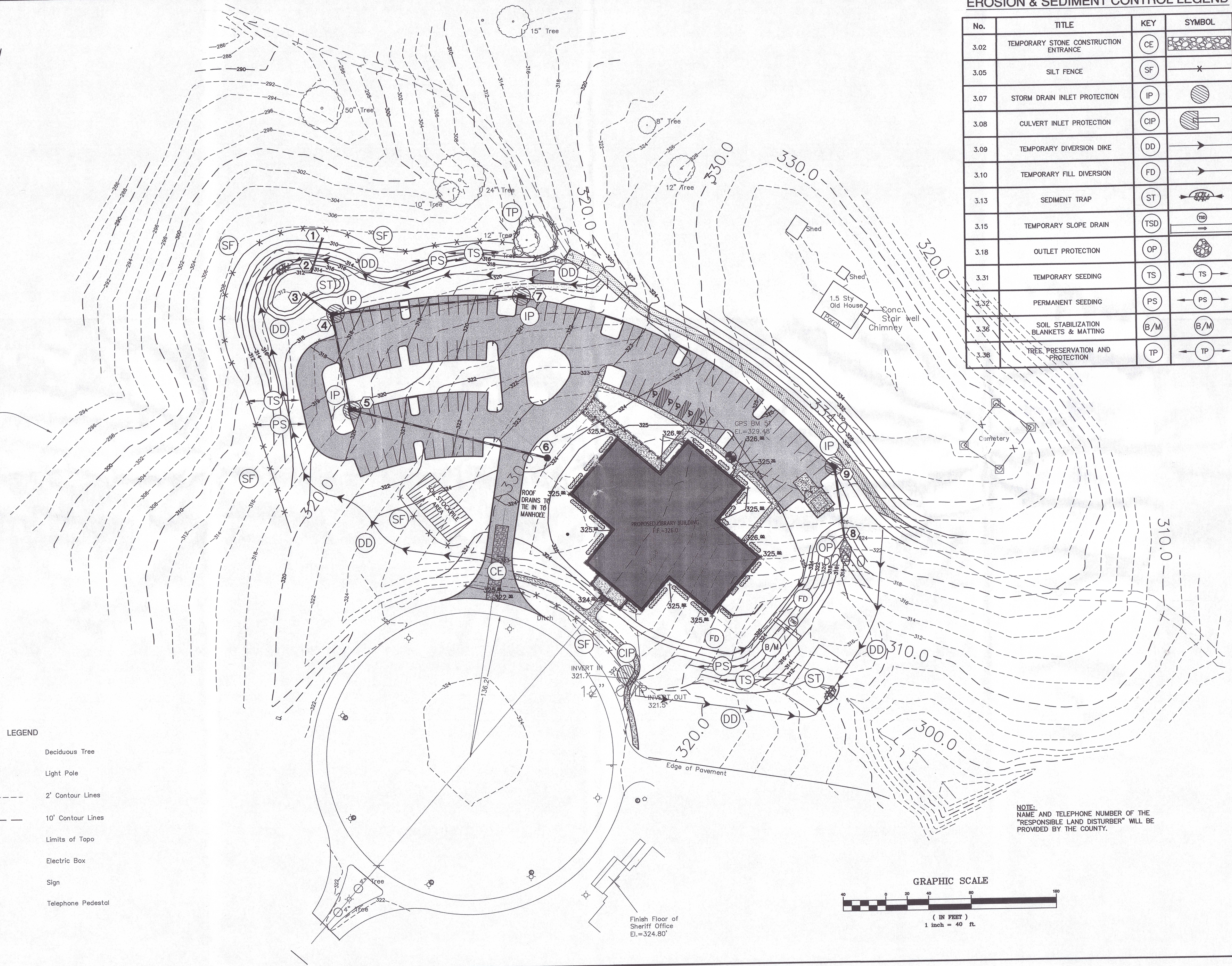

NOTE:
 NAME AND TELEPHONE NUMBER OF THE
 "RESPONSIBLE LAND DISTURBER" WILL BE
 PROVIDED BY THE COUNTY.

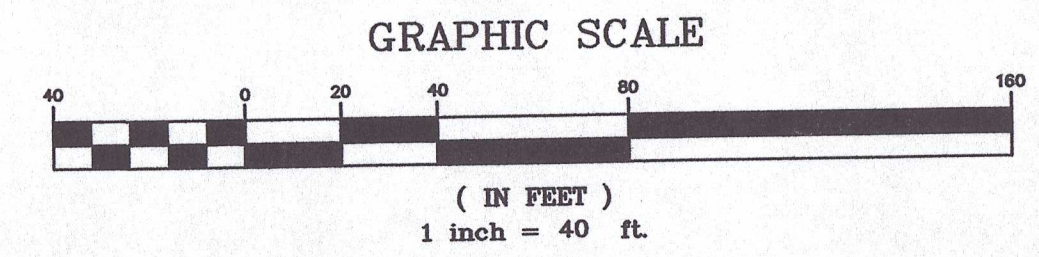

P:\CV06175-01\CV06175-01.dwg February 21, 2007 10:44:18 AM

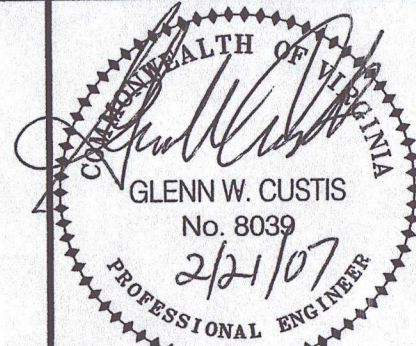

Draper Aden Associates
 Engineering + Surveying + Environmental Services
 Blacksburg, VA
 Richmond, VA
 Hampton Roads, VA
 Charlottesville, VA
 700 S. Second Street E
 Charlottesville, VA 22903
 434-294-0700 Fax: 434-294-2105
 www.daa.com



GRADING & STORMWATER MANAGEMENT PLAN
FLUVANNA COUNTY PUBLIC LIBRARY
 FLUVANNA COUNTY, VIRGINIA

REVISIONS

2/9/07	PRELIMINARY SUBMISSION
2/19/07	PER E&S COMMENTS

DESIGNED BY:	DAA
DRAWN BY:	JAC
CHECKED BY:	GWC
SCALE:	1" = 40'
DATE:	FEBRUARY 19, 2007
PROJECT NUMBER:	CV06175-01

C2.1

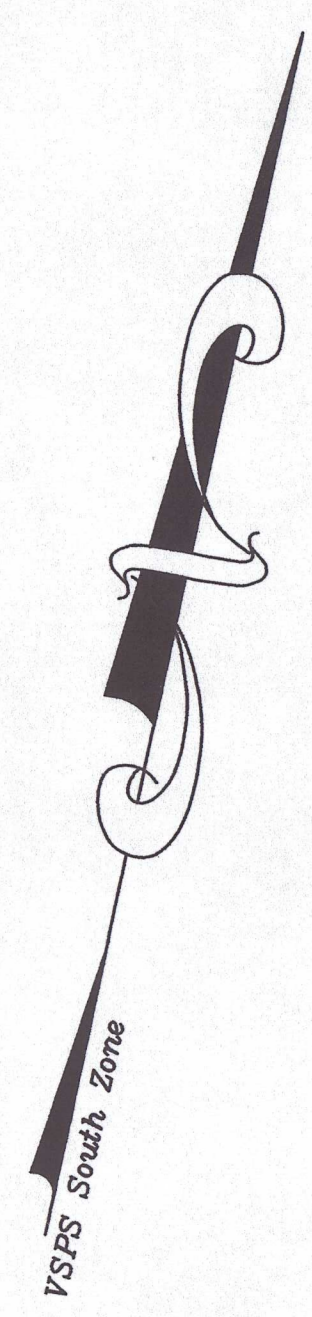

SURVEY LIMITS

LEGEND

	Deciduous Tree
	Light Pole
	2' Contour Lines
	10' Contour Lines
	Limits of Topo
	Electric Box
	Sign
	Telephone Pedestal

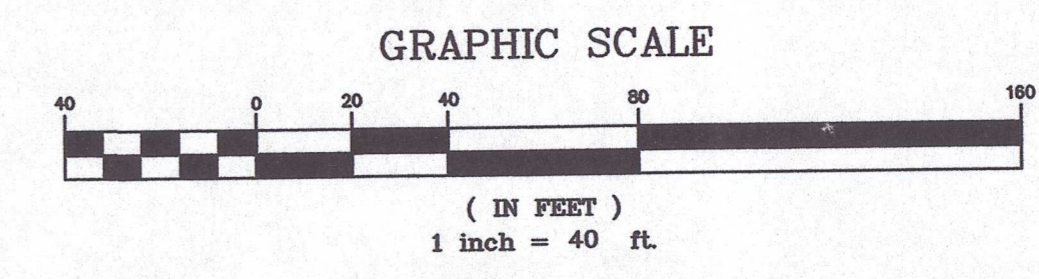
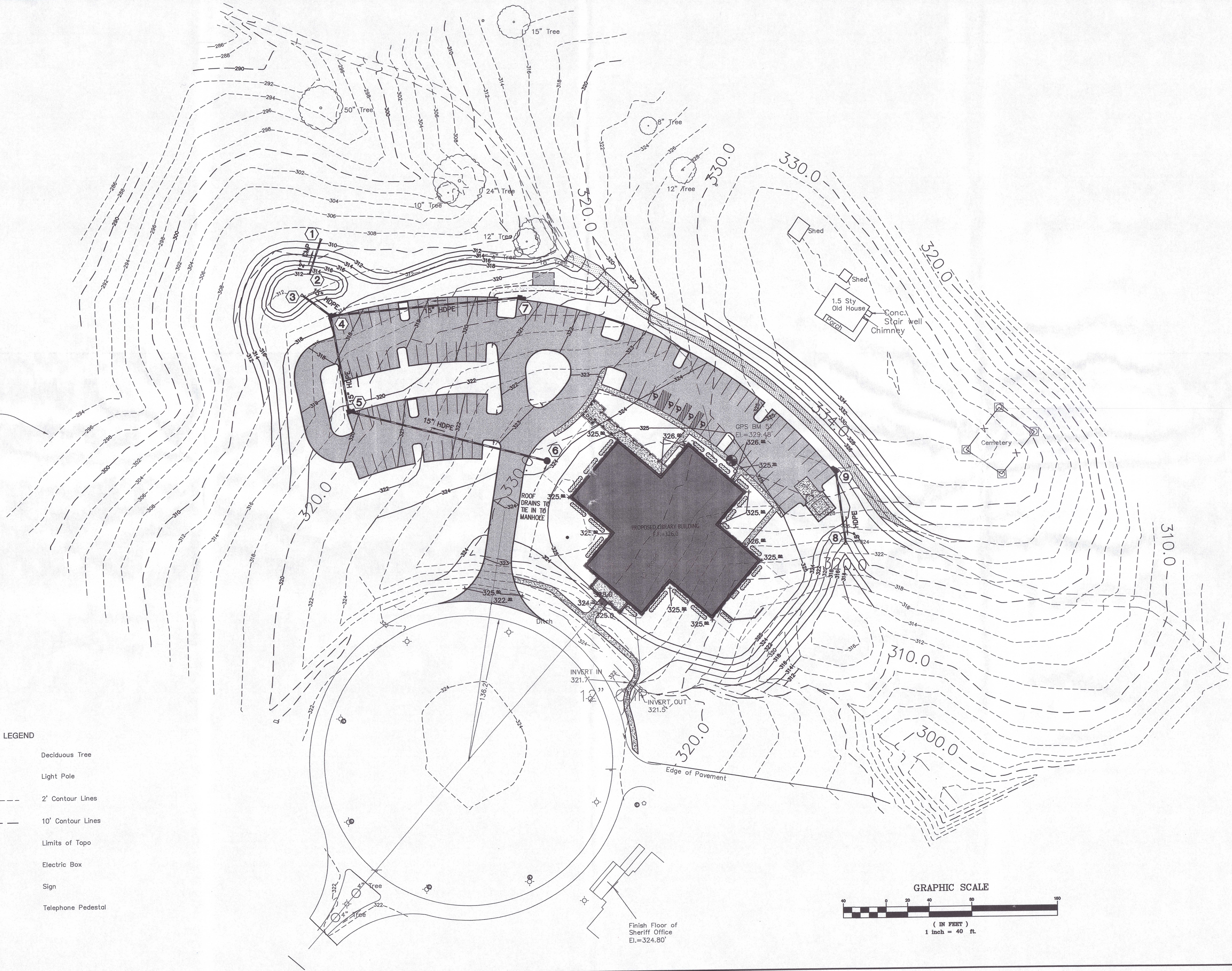

P:\06175\06175 Fluvanna County Library\CV06175-01\CV06175-01.dwg 2/19/07 10:02:42 AM

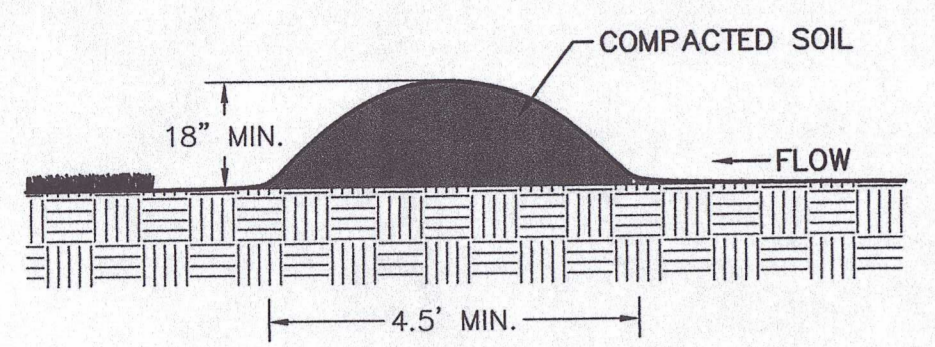

1 C3.1 TEMPORARY DIVERSION DIKE (DD)

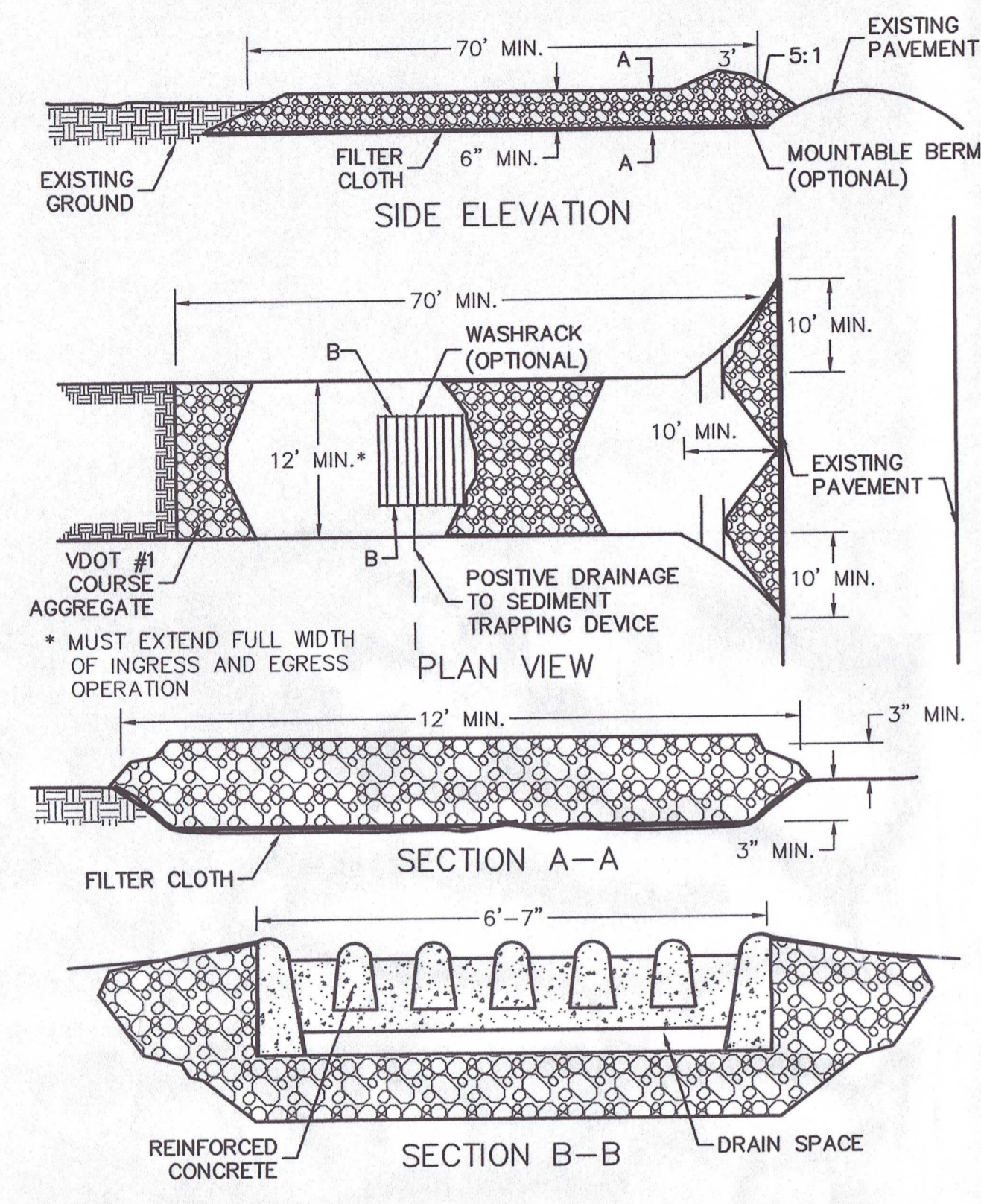

2 C3.1 STONE CONSTRUCTION ENTRANCE (CE)

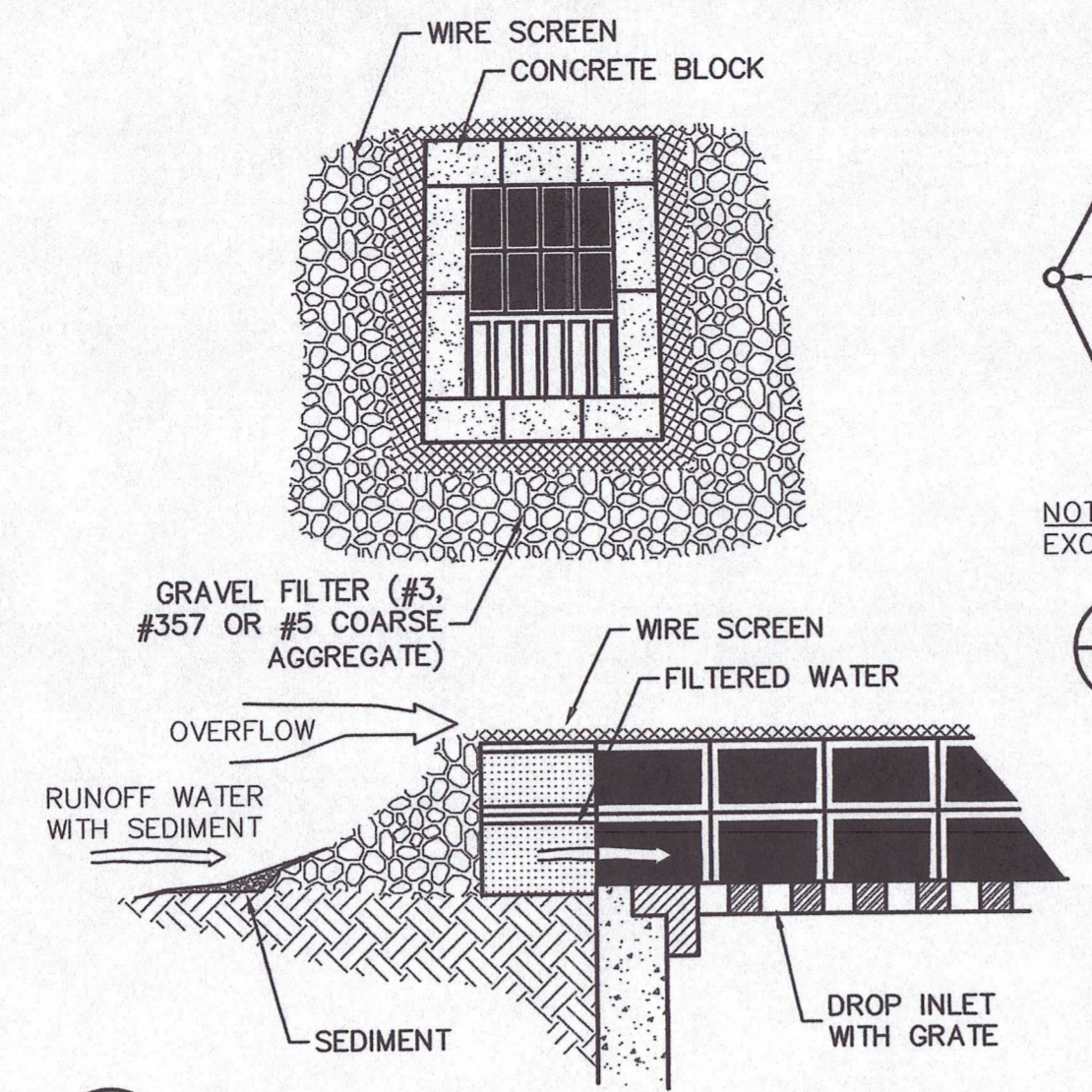

4 C3.1 INLET PROTECTION (GRATE INLET) (IP)

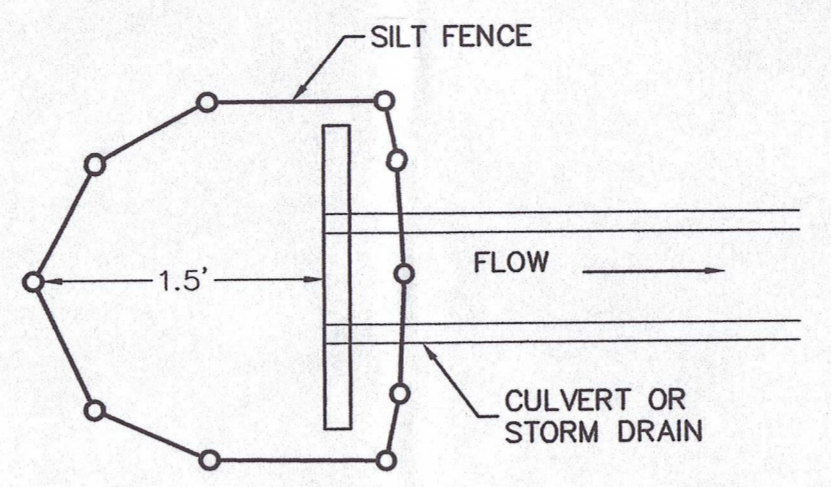
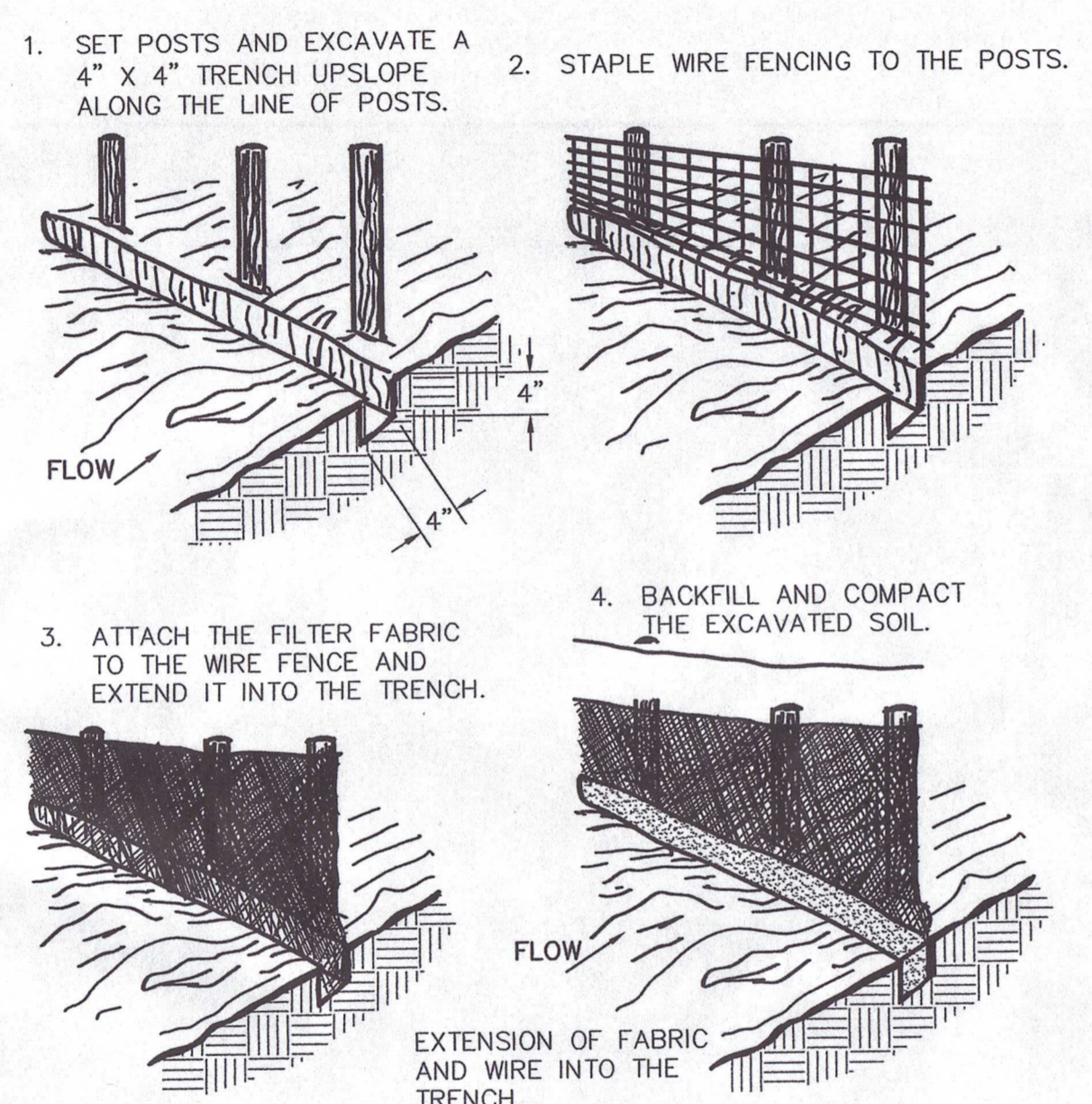

NOTE: SILT FENCE SHALL MEET THE REQUIREMENTS OF 3/C7 EXCEPT THE STAKE SPACING SHALL BE 3 FEET.

6 C3.1 CULVERT INLET PROTECTION (CIP)

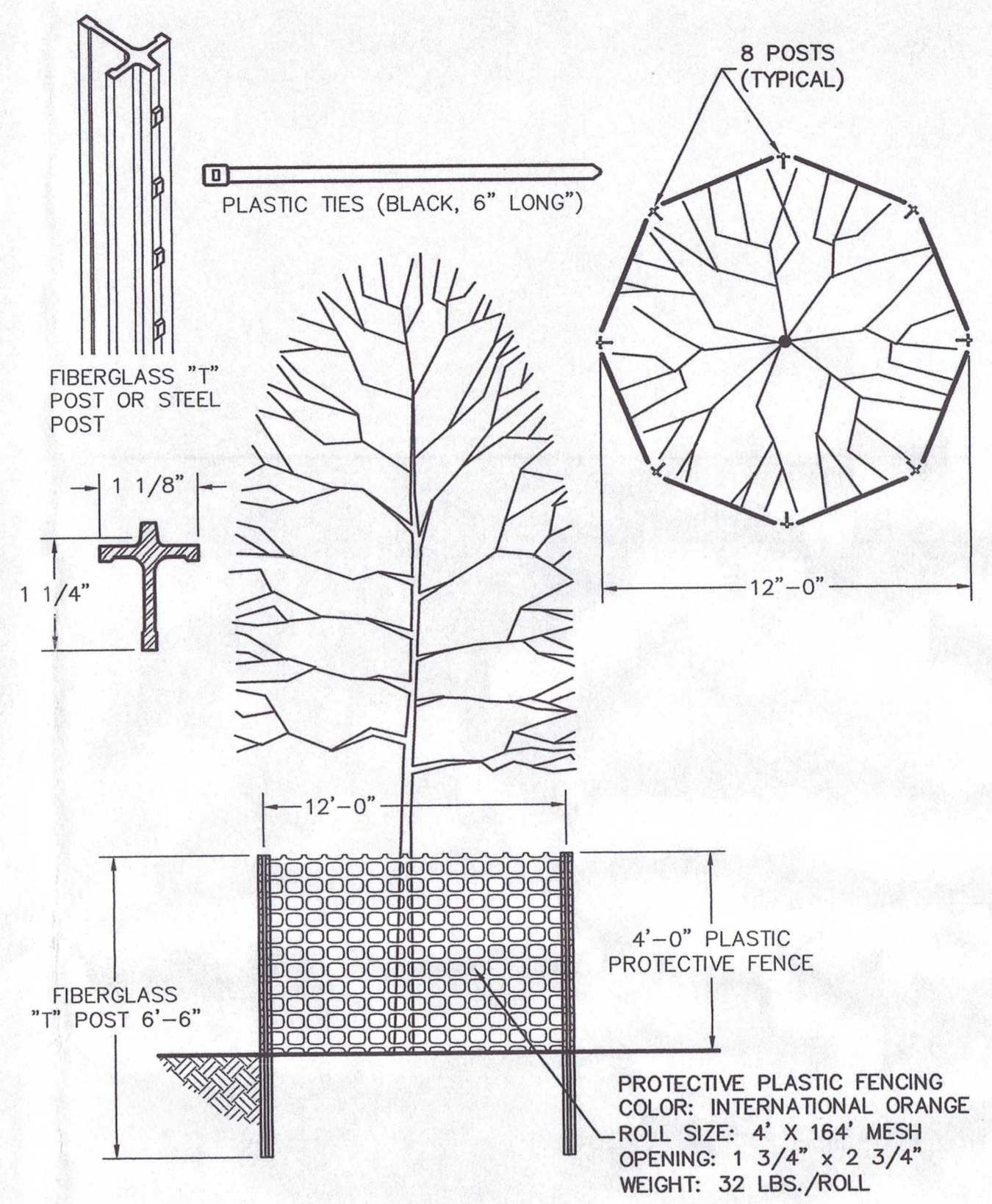

7 C3.1 PROTECTIVE PLASTIC FENCING TREE PROTECTION (TP)

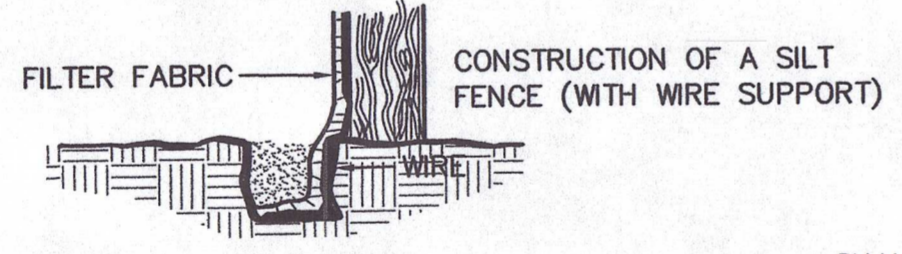

5 C3.1 SILT FENCE (SF)

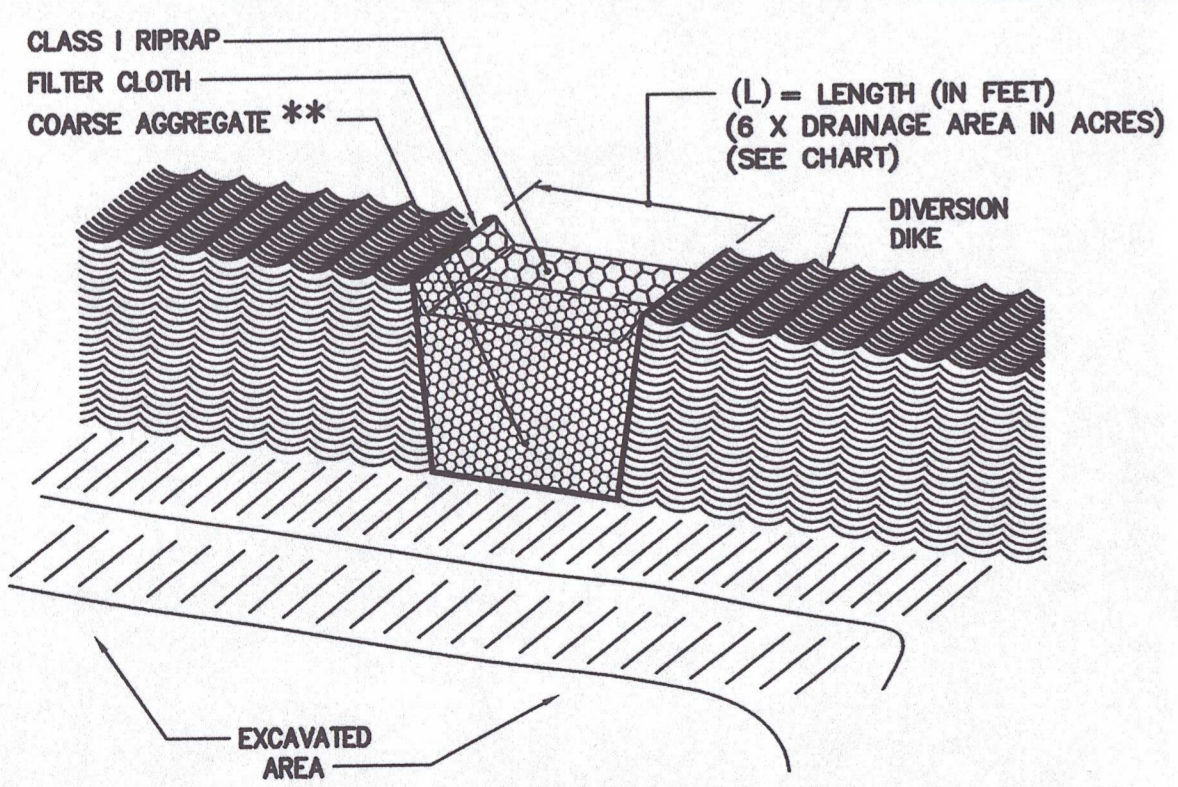
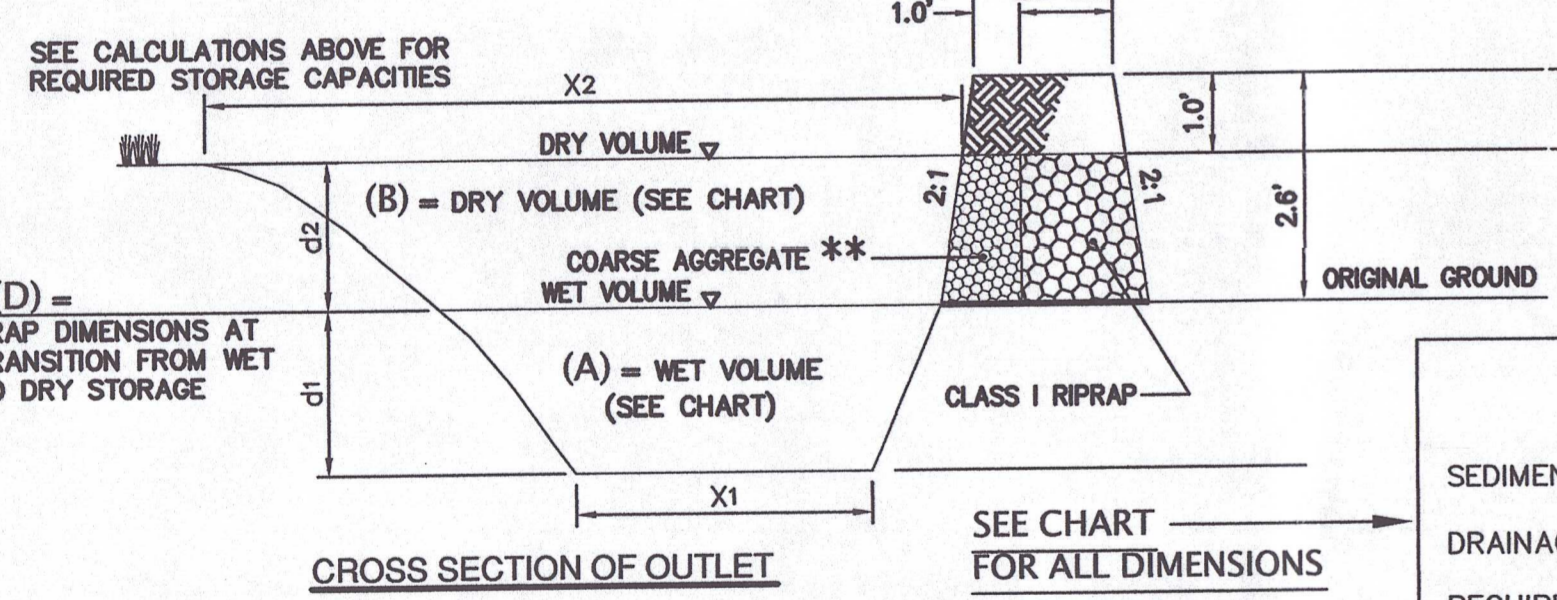

3 C3.1 TEMPORARY SEDIMENT TRAP (ST)

SEDIMENT TRAP CALCULATIONS		
SEDIMENT TRAP #	1	2
DRAINAGE AREA	2.31 ACRES	1.36 ACRES
REQUIRED TOTAL STORAGE	310 CU. YD.	182 CU. YD.
TOTAL STORAGE PROVIDED	312 CU. YD.	188 CU. YD.
REQUIRED WET STORAGE	155 CU. YD.	91 CU. YD.
(A) WET STORAGE PROVIDED	156 CU. YD.	92 CU. YD.
REQUIRED DRY STORAGE	155 CU. YD.	91 CU. YD.
(B) DRY STORAGE PROVIDED	156 CU. YD.	96 CU. YD.
(L) TRAP OUTLET LENGTH	13.9 L.F.	8.2 L.F.
(d1) DEPTH OF WET STORAGE	2.4'	2.4'
(d2) DEPTH OF DRY STORAGE	1.6'	1.6'
CLEANOUT HEIGHT	1.2'	1.2'
(D) TRAP DIMENSIONS AT WET/DRY STORAGE TRANSITION	34'W x 76'L (NOT RECT.)	28'W x 50'L
(x1) STORAGE BOTTOM LENGTH	65 L.F.	40 L.F.
(x2) STORAGE TOP LENGTH	83 L.F.	56 L.F.

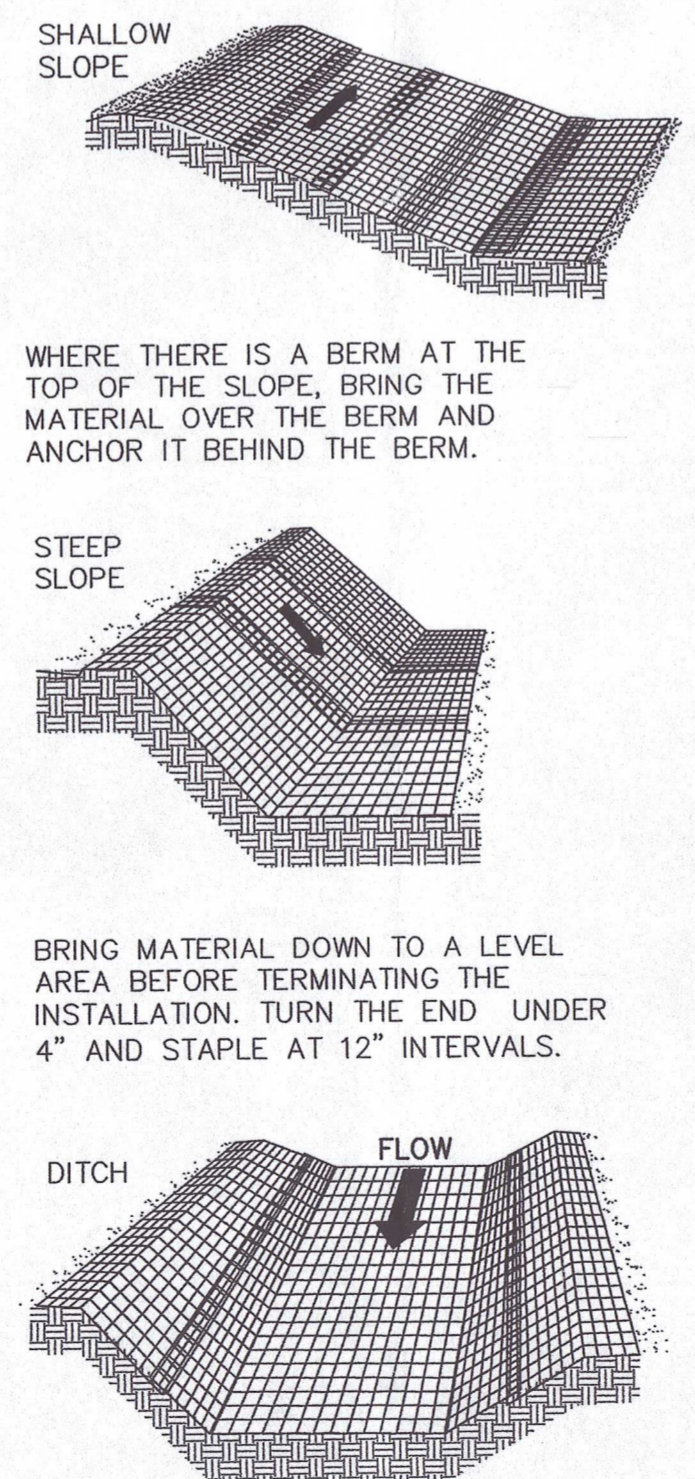

10 C3.1 TYPICAL ORIENTATION OF TREATMENT - 1 (SOIL STABILIZATION BLANKET)

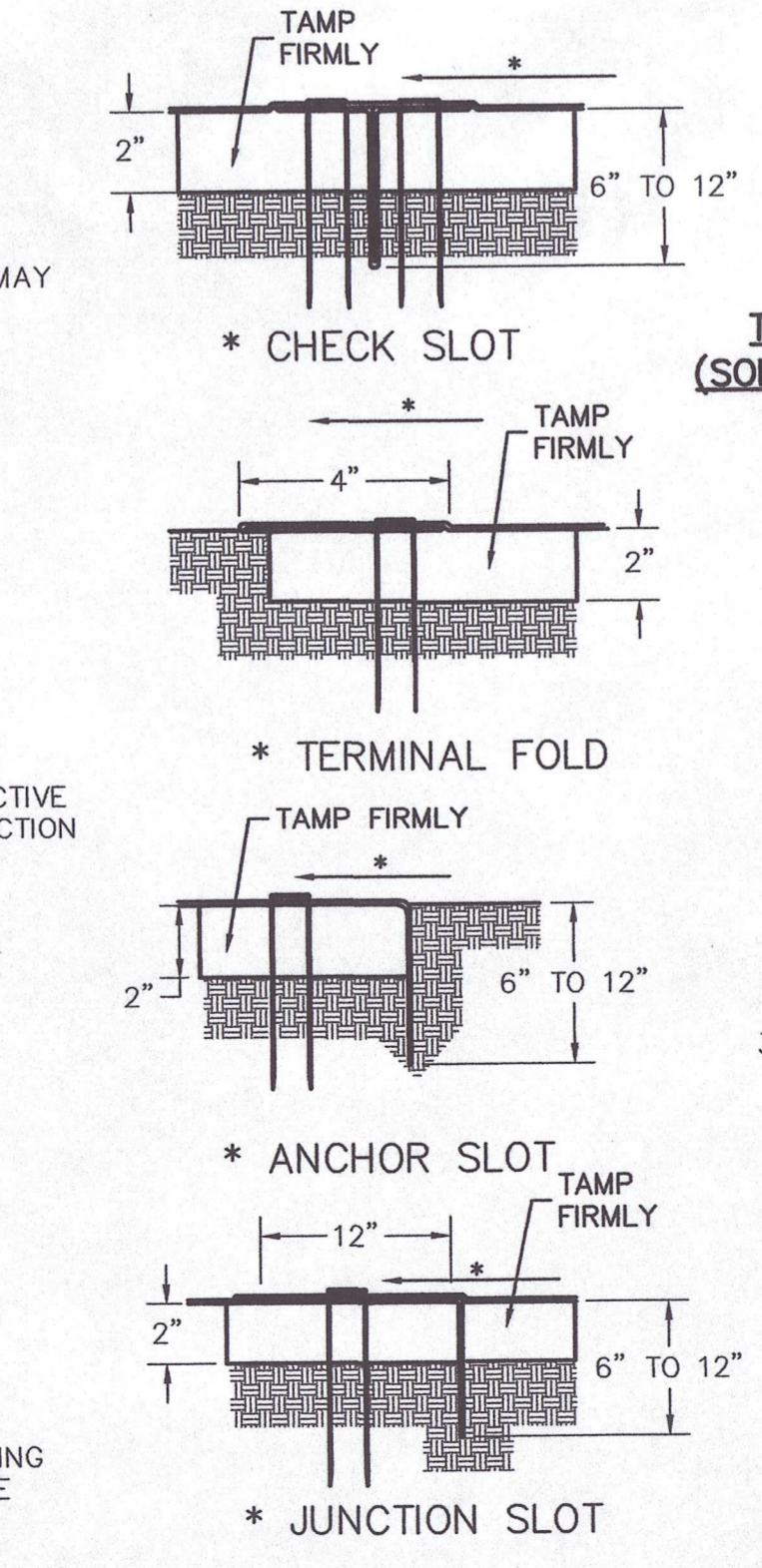

TYPICAL TREATMENT - 1 (SOIL STABILIZATION BLANKET) INSTALLATION CRITERIA

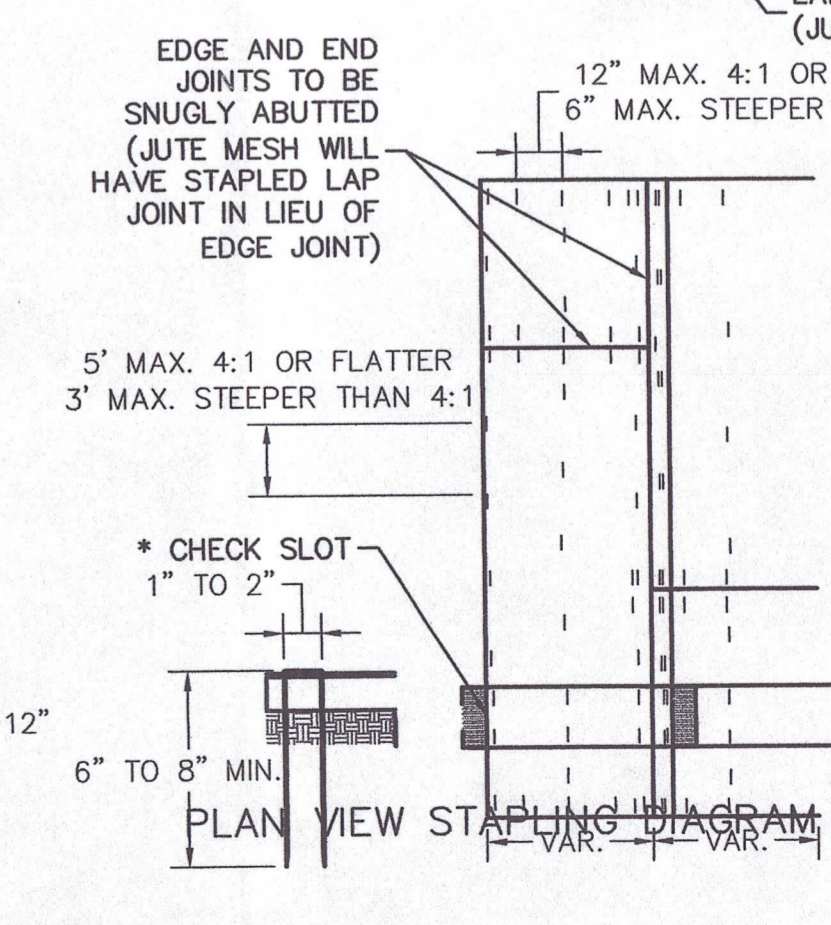

- NOTES:
- APPROXIMATELY 200 STAPLES REQUIRED PER 100 SQ. YDS. OF MATERIAL ROLL. ANCHOR SLOTS, JUNCTION SLOTS & CHECK SLOTS TO BE BURIED 6" TO 12".
 - STAPLE FORMED FROM NO.11 STEEL WIRE. 8" STAPLE MIN. LENGTH FOR SANDY SOIL. 6" STAPLE MIN. LENGTH FOR OTHER SOIL.

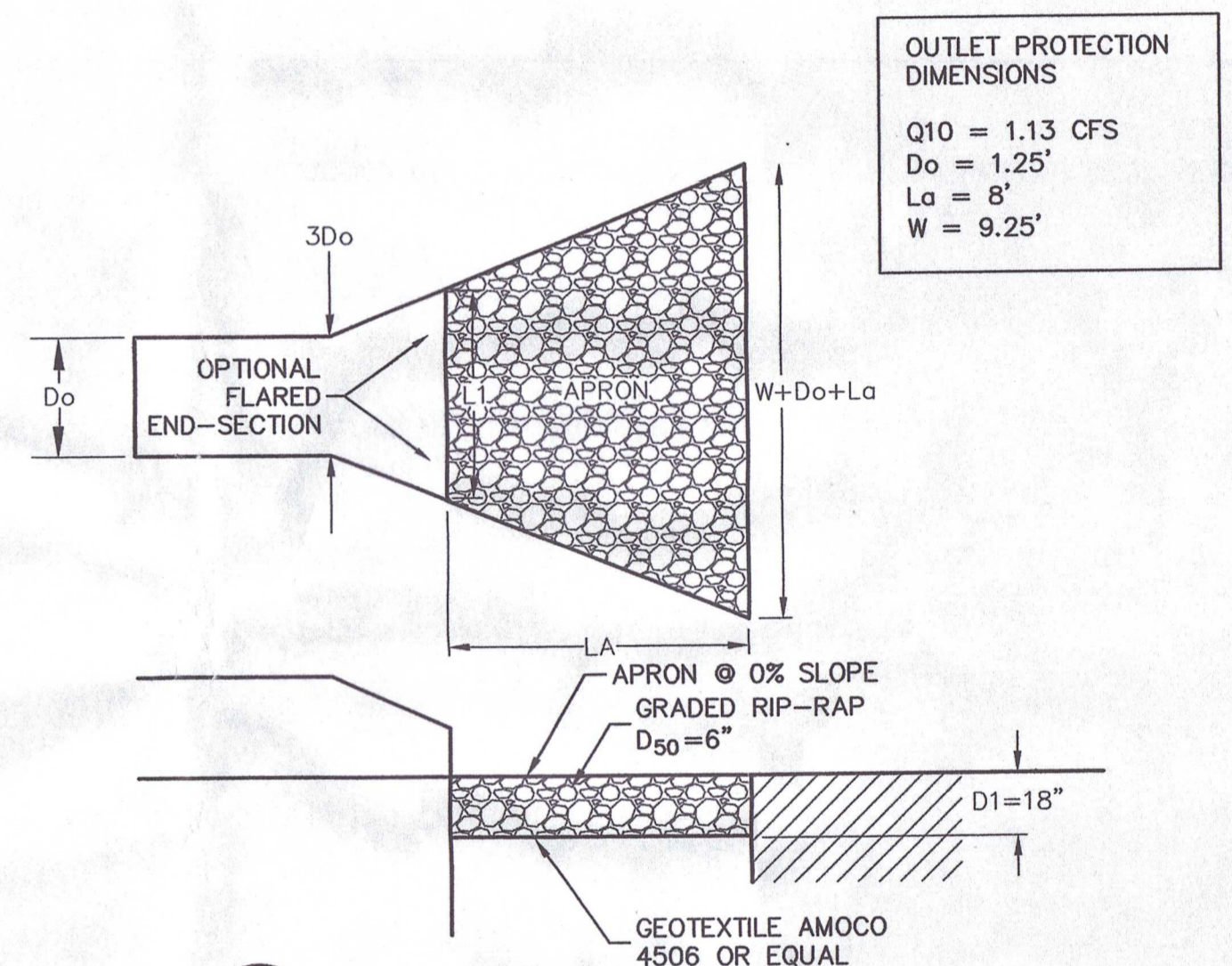

9 C3.1 OUTLET PROTECTION (OP)

ACCEPTABLE TEMPORARY SEEDING PLANT MATERIALS		
PLANTING DATES	SPECIES	RATE (LBS./ACRE)
SEPT 1-FEB 15	50/50 MIX OF ANNUAL RYEGRASS (LOLIUM MULTI-FLORUM) & CEREAL (WINTER) RYE (SECALE CEREALE)	50-100
FEB 16-APR 20	ANNUAL RYEGRASS (LOLIUM MULTI-FLORUM)	60-100
MAY 1-AUG 31	GERMAN MILLET (SETARIA ITALICA)	50

SEEDINGS MADE IN FALL FOR WINTER COVER AND DURING HOT AND DRY SUMMER MONTHS SHALL BE MULCHED IMMEDIATELY UPON COMPLETION OF SEED APPLICATION WITH TACKIFIED STRAW, IN ACCORDANCE WITH VA E&S STD 3.35.

TS TEMPORARY SEEDING SCHEDULE SPECIFICATION 02710

GENERAL SLOPE (3:1 OR LESS)		TOTAL LBS PER ACRE
KENTUCKY 31 FESCUE	200 LBS.	
KENTUCKY BLUEGRASS	10 LBS.	
RED TOP GRASS	10 LBS.	
SEASONAL NURSE CROP	30 LBS.	
WHITE CLOVER	2 LBS.	
	252 LBS.	

PS PERMANENT SEEDING SCHEDULE SPECIFICATION 02710

8 C3.1 SEEDING SCHEDULES

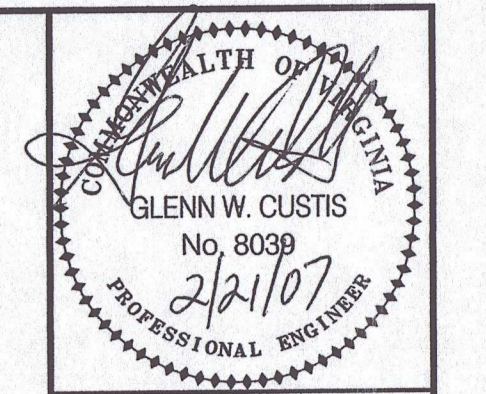

Draper Aden Associates
 Engineering + Surveying + Environmental Services
 Charlottesville, VA
 Blacksburg, VA
 Richmond, VA
 Hampton Roads, VA
 701 H St. Suite E
 Charlottesville, VA 22903
 434-295-0700 Fax: 434-295-2105
 www.daa.com

EROSION AND SEDIMENT CONTROL DETAILS
FLUVANNA COUNTY PUBLIC LIBRARY
 FLUVANNA COUNTY, VIRGINIA

REVISIONS	
2/9/07	PRELIMINARY SUBMISSION
2/19/07	PER E&S COMMENTS

DESIGNED BY:	DAA
DRAWN BY:	JAC
CHECKED BY:	GWG
SCALE:	NOT TO SCALE
DATE:	FEBRUARY 19, 2007
PROJECT NUMBER:	CV06175-01

C3.1

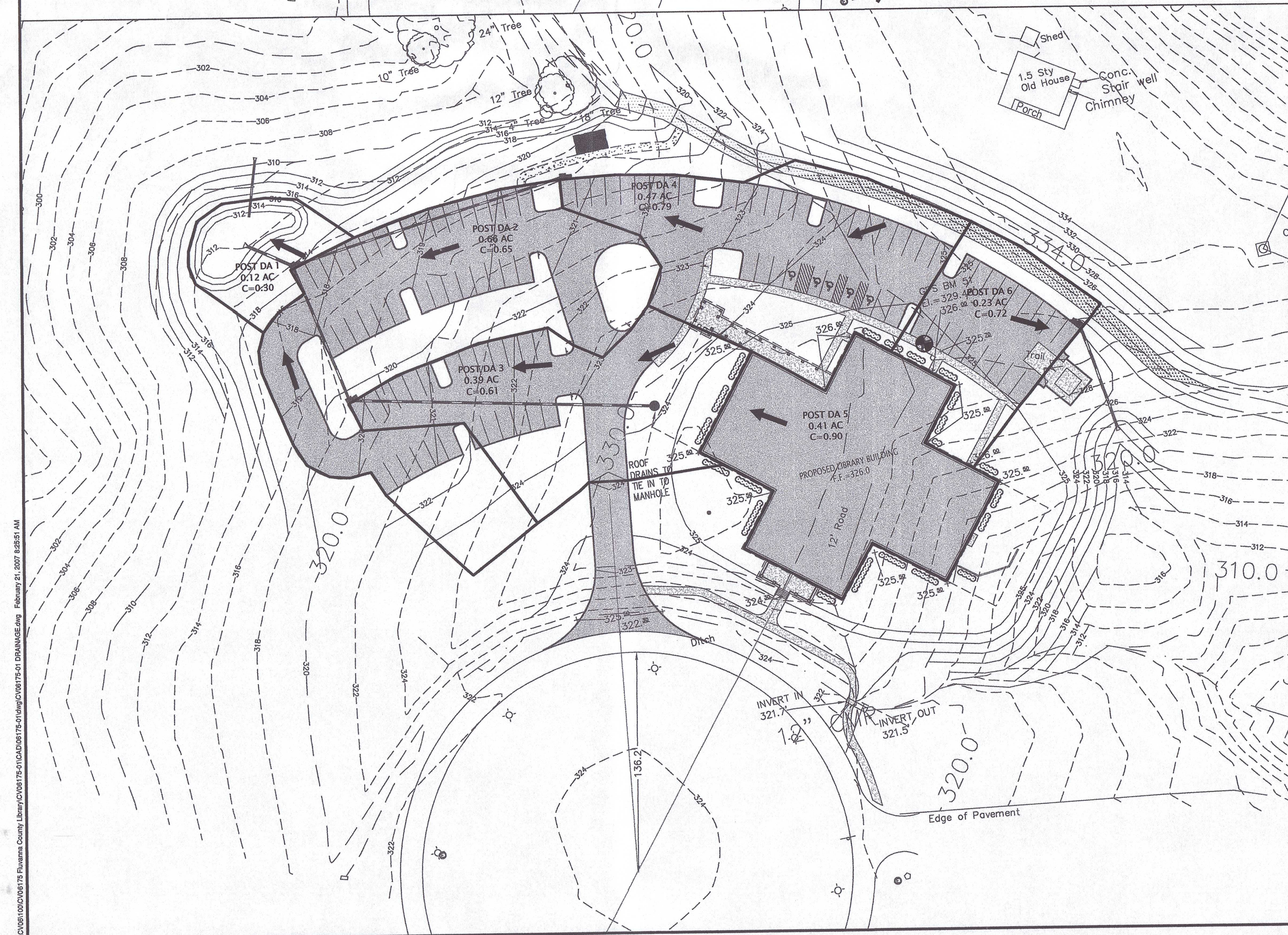
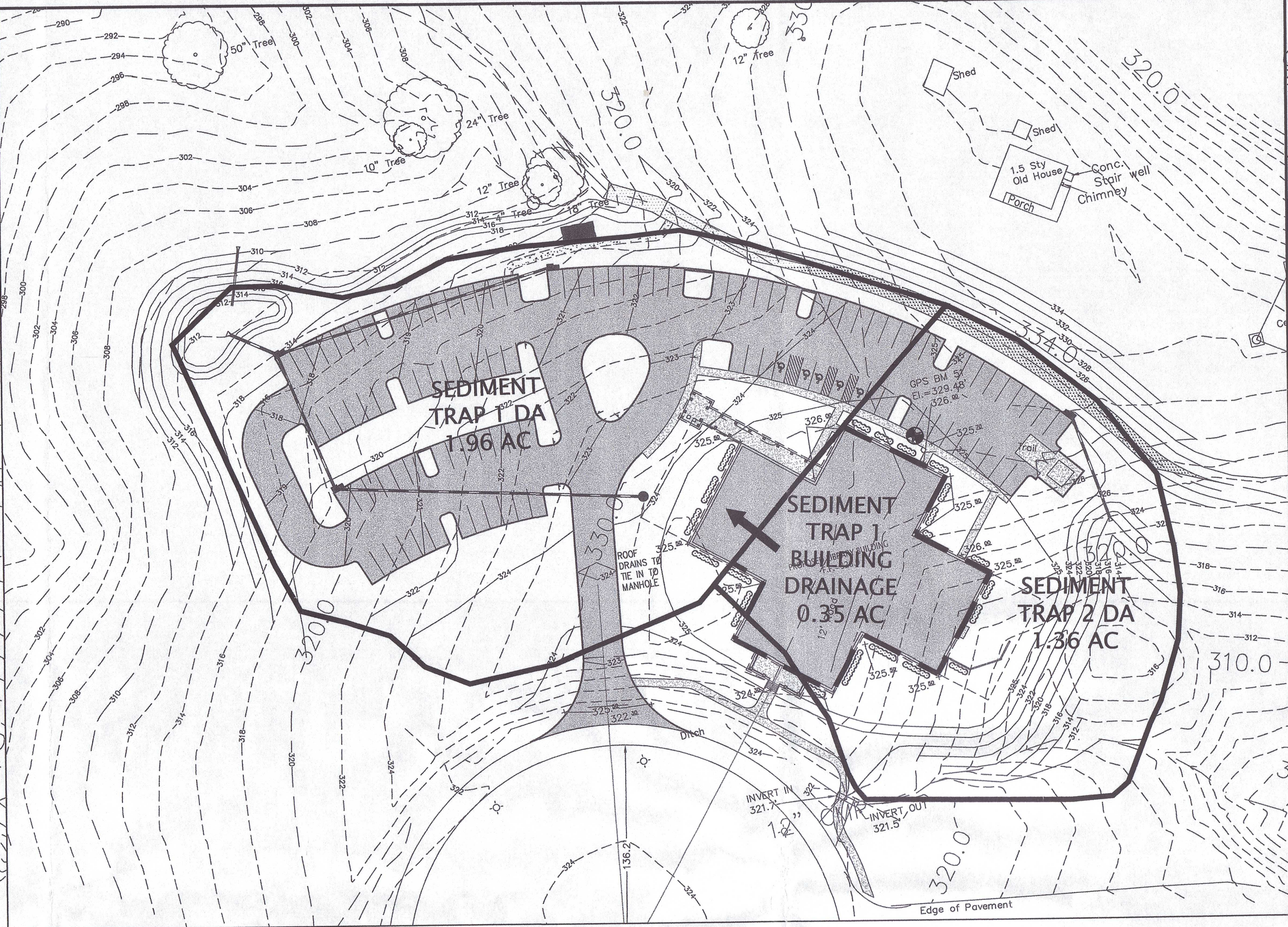
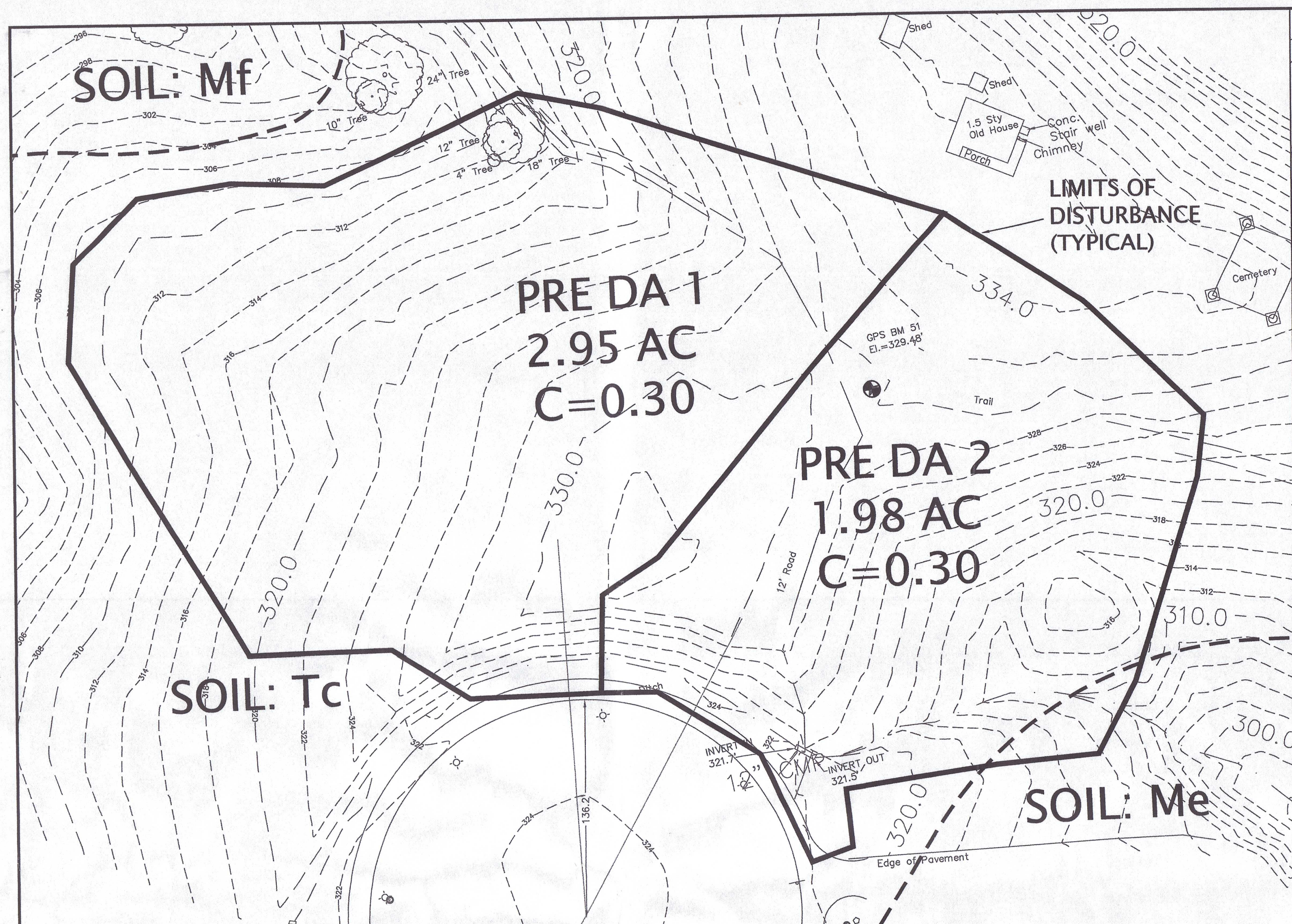

SEDIMENT TRAP DRAINAGE AREAS:

ST 1

PRE-DEVELOPED: 1.96 AC
POST-DEVELOPED: 2.31 AC

ST 2

PRE-DEVELOPED: 1.36 AC
POST-DEVELOPED: 1.01 AC

*NOTE: SEDIMENT TRAPS SIZED BASED ON LARGEST DISTURBED AREA. SEE DETAILS FOR SEDIMENT TRAP CALCULATIONS.

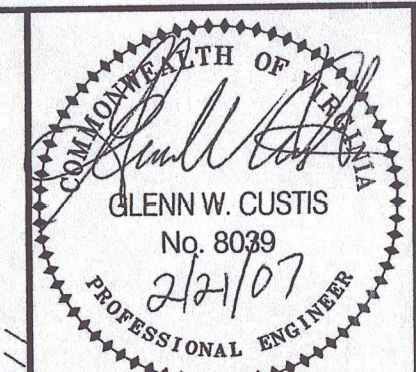
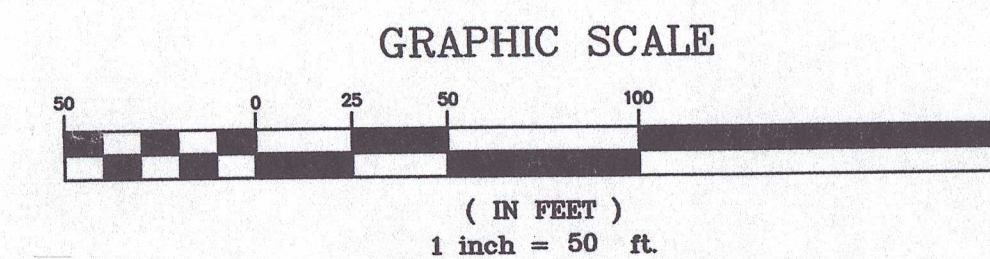

Draper Aden Associates
Engineering • Surveying • Environmental Services

Blacksburg, VA
Richmond, VA
Hampton Roads, VA

Charlottesville, VA
700 Harris Street, Suite E
Charlottesville, VA 22903
434-295-5000
www.daa.com

DRAINAGE PLAN
FLUVANNA COUNTY PUBLIC LIBRARY
FLUVANNA COUNTY, VIRGINIA

REVISIONS

2/9/07
PRELIMINARY SUBMISSION

2/19/07
PER E&S COMMENTS

DESIGNED BY: DAA
DRAWN BY: ASK
CHECKED BY: GWC
SCALE: 1" = 50'
DATE: FEBRUARY 19, 2007
PROJECT NUMBER: CV06175-01
C4.1

P:\CV06175-01\Drawings\CV06175-01\DWG\CV06175-01.dwg February 21, 2007 8:55:51 AM