

FLUVANNA COUNTY PUBLIC LIBRARY

FLUVANNA COUNTY, VIRGINIA

NO. REVISIONS

SET NO. **7**

FLUVANNA COUNTY PUBLIC LIBRARY
FLUVANNA COUNTY, VIRGINIA

TITLE SHEET

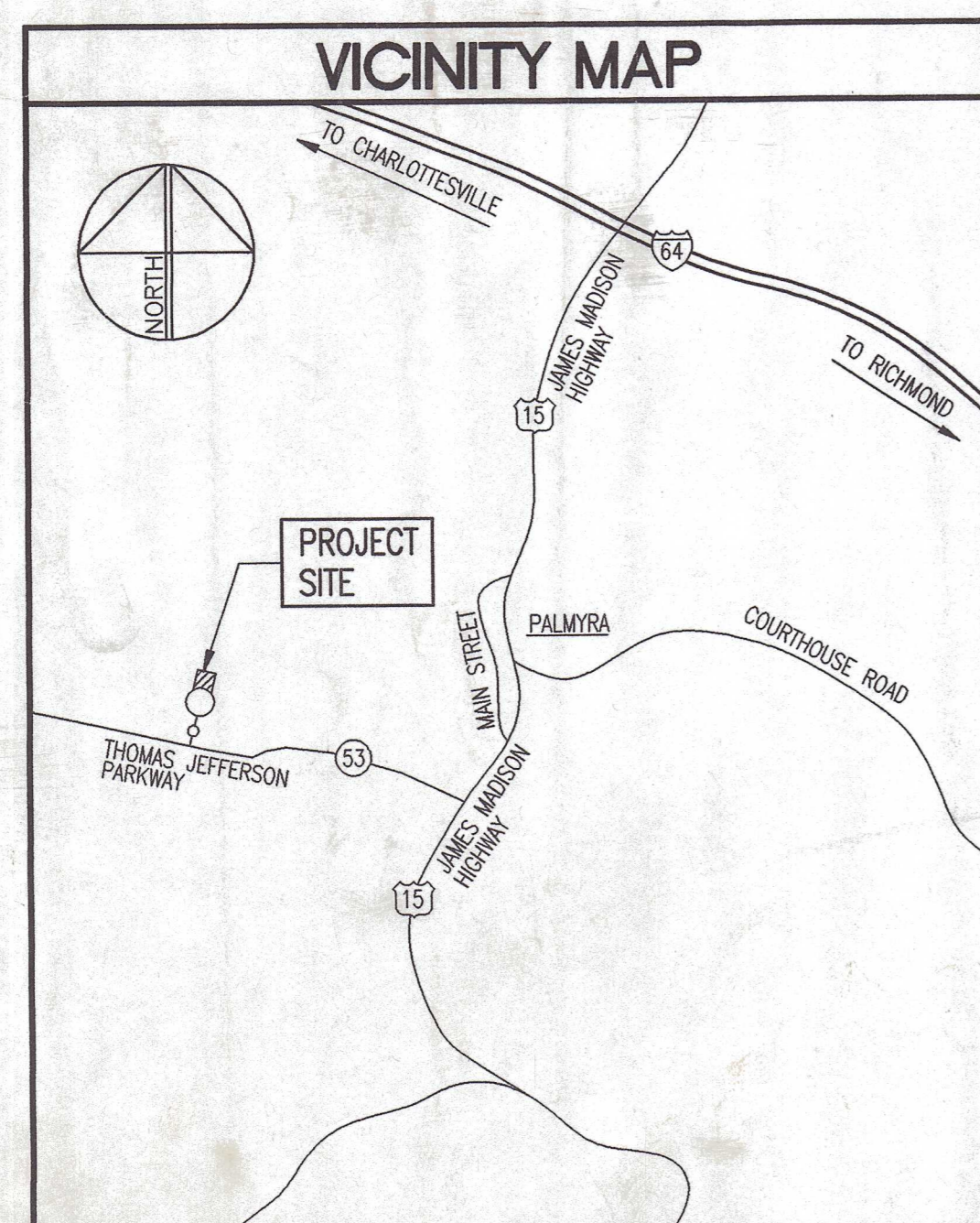

| ABBREVIATIONS | | | |
|---------------|---------------------------------------|----------|---|
| ABV. | ABOVE | FIN. | FINISH |
| A.B. | ANCHOR BOLT | FLR. | FLOOR |
| A.F.F. | ABOVE FINISHED FLOOR | FRAM'G. | FRAMING |
| ALUM. | ALUMINUM | FT. | FEET |
| APPROX. | APPROXIMATE | FTG. | FOOTING |
| ASPH. | ASPHALT | GA. | GAGE OR GAUGE |
| A.S.C. | ACOUSTICAL SUSPENDED CEILING | GALV. | GALVANIZED |
| BD. | BOARD | GR. | GRADE |
| BEL. | BELOW | GYP. | GYPSUM |
| BLDG. | BUILDING | G.W.B. | GYPSUM WALL BOARD |
| BLKG. | BLOCKING | H. | HEIGHT |
| BM. | BEAM | H.M. | HOLLOW METAL |
| BRG. | BEARING | HORIZ. | HORIZONTAL |
| BRK. | BRICK | H.W.H. | HOT WATER HEATER |
| B/T | BETWEEN | IN. | INCHES |
| CLG. | CEILING | INSUL. | INSULATION |
| CLR. | CLEARANCE | INT. | INTERIOR |
| C.M.U. | CONCRETE MASONRY UNIT | JST. | JOIST |
| COL. | COLUMN | JT. | JOINT |
| CONC. | CONCRETE | LAM. | LAMINATED |
| CONT. | CONTINUOUS | LB. | POUNDS |
| C.T. | CERAMIC TILE | LOC. | LOCATION |
| CTR. | CENTER | L.L.V. | LONG LEG VERTICAL |
| DIA. | DIAMETER | L.V.L. | LAMINATED VENEER LUMBER |
| DTL. | DETAIL | MAT'L. | MATERIAL |
| DWGS. | DRAWINGS | MAX. | MAXIMUM |
| EA. | EACH | MECH. | MECHANICAL |
| E.I.F.S. | EXTERIOR INSULATION AND FINISH SYSTEM | MFR. | MANUFACTURER |
| ELEC. | ELECTRICAL | MIN. | MINIMUM |
| ELEV. | ELEVATION | M.O. | MASONRY OPENING |
| EQ. | EQUAL | M.R. | MOISTURE RESISTANT |
| EXIST. | EXISTING | MTD. | MOUNTED |
| EXP. | EXPANSION | MTL. | METAL |
| EXT. | EXTERIOR | N.I.C. | NOT IN CONTRACT |
| F.E. | FIRE EXTINGUISHER | NO. | NUMBER |
| FDN. | FOUNDATION | O.C. | ON CENTER |
| | | O.F.C.I. | OWNER FURNISHED CONTRACTOR INSTALLED |
| | | PERIM. | PERIMETER |
| | | PLYWD. | PLYWOOD |
| | | P.T. | PRESSURE TREATED |
| | | R. | RISER |
| | | REINF. | REINFORCING |
| | | REQD. | REQUIRED |
| | | RM. | ROOM |
| | | R.O. | ROUGH OPENING |
| | | R.O.W. | RIGHT-OF-WAY |
| | | R.S. | ROUGH-SAWN |
| | | SCH. | SCHEDULE |
| | | SHEATH'G | SHEATHING |
| | | SHT. | SHEET |
| | | SIM. | SIMILAR |
| | | SP. | SPACING |
| | | SPEC. | SPECIFICATION |
| | | SQ. | SQUARE |
| | | STL. | STEEL |
| | | STOR. | STORAGE |
| | | STRUCT. | STRUCTURE |
| | | S.B.O. | SUPPLIED BY OWNER |
| | | SUSP. | SUSPENDED |
| | | T. | TREAD |
| | | T.C.P. | THIN-COAT PLASTER |
| | | THK. | THICK |
| | | TYP. | TYPICAL |
| | | V.C.T. | VINYL COMPOSITION TILE |
| | | V.B. | VAPOR BARRIER |
| | | VERT. | VERTICAL |
| | | V.W.F. | VINYL WALL FABRIC |
| | | W. | WIDTH |
| | | W/ | WITH |
| | | WD. | WOOD |
| | | W.W.F. | WELDED WIRE FABRIC |
| | | WTRPRF. | WATERPROOF(ING) |
| | | | SEE CIVIL, MECHANICAL AND ELECTRICAL DRAWINGS FOR ADDITIONAL ABBREVIATIONS. |

| INDEX OF DRAWINGS | |
|-------------------|---|
| T1 | TITLE SHEET |
| C0.1 | TITLE SHEET |
| C1.1 | EXISTING CONDITIONS PLAN |
| C2.1 | SITE DIMENSIONAL PLAN |
| C2.2 | GRADING & STORMWATER MANAGEMENT PLAN |
| C3.1 | CONSTRUCTION DETAILS |
| L1.1 | PLANTING PLAN |
| L1.2 | LANDSCAPE DETAILS & NOTES |
| A1 | FLOOR PLAN, WALL TYPES AND NOTES |
| A2 | EXTERIOR ELEVATIONS AND WINDOW SCHEDULE |
| A3 | PARTIAL FLOOR PLANS, INTERIOR ELEVATIONS AND SECTION |
| A4 | SECTIONS |
| A5 | SECTIONS AND DETAILS |
| A6 | SECTIONS |
| A7 | FINISH SCHEDULE, DOOR SCHEDULE, ELEVATIONS, SECTION AND DETAILS |
| S1 | GENERAL STRUCTURAL NOTES, SCHEDULES, SECTIONS AND DETAILS |
| S2 | FOUNDATION PLAN AND NOTES |
| S3 | ROOF FRAMING PLAN AND NOTES |
| M1 | FLOOR PLAN - MECHANICAL |
| M2 | PARTIAL MECHANICAL ROOM PLANS, LEGEND, DETAILS AND NOTES |
| P1 | FLOOR PLAN - PLUMBING, LEGEND, DETAIL AND NOTES |
| P2 | PARTIAL PLANS - PLUMBING, SCHEDULE AND DETAILS |
| E1 | ELECTRICAL LEGEND, SCHEDULE & DETAILS |
| E2 | ELECTRICAL SITE PLAN, DIAGRAMS, DETAILS & NOTES |
| E3 | FLOOR PLAN - LIGHTING, DIAGRAMS, SCHEDULE & NOTES |
| E4 | FLOOR PLAN - POWER & NOTES |
| E5 | PANELBOARD SCHEDULES & POWER RISER DIAGRAM |

| CODE INFORMATION | |
|---|----------------|
| 2003 INTERNATIONAL BUILDING CODE (IBC) | |
| 2003 VIRGINIA UNIFORM STATEWIDE BUILDING CODE (VUSBC) | |
| CONSTRUCTION CLASSIFICATION: | IIIB |
| USE GROUP: | ASSEMBLY (A-3) |
| SQUARE FOOTAGE: | 17,780 S.F. |

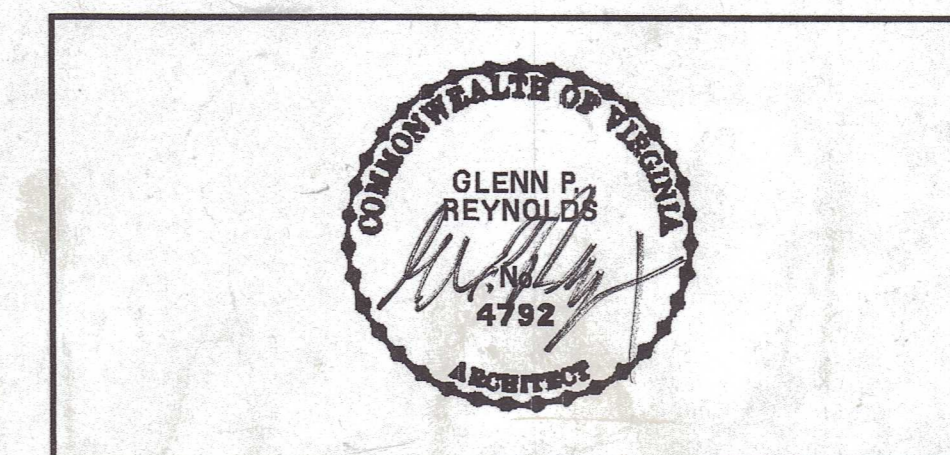

REYNOLDS ARCHITECTS INCORPORATED
BLACKSBURG, VIRGINIA

| | | | |
|----------|---------|----------|-----|
| DESIGNED | RA | DRAWN | DKW |
| CHECKED | GPR | APPROVED | GPR |
| PROJECT | 0422 | | |
| DATE | 9-12-07 | | |

T1

SITE PLAN

FLUVANNA COUNTY PUBLIC LIBRARY

FLUVANNA COUNTY, VIRGINIA

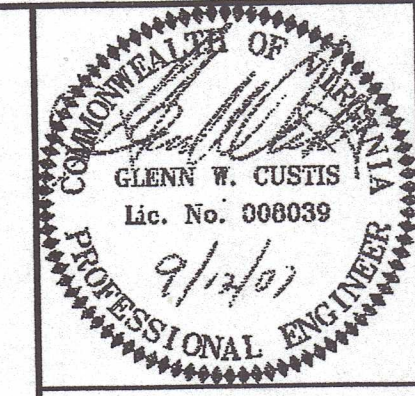

Draper Aden Associates
 Engineering + Surveying + Environmental Services
 Blacksburg, VA
 Richmond, VA
 Hampton Roads, VA
 Charlottesville, VA
 700 Harris Street, Suite E
 Charlottesville, VA 22903
 434-295-0700 Fax: 434-295-2105
 www.daa.com



TITLE SHEET
FLUVANNA COUNTY PUBLIC LIBRARY
 FLUVANNA COUNTY, VIRGINIA

DRAWING LIST

| SHT. NO. | DESCRIPTION |
|-----------|--------------------------------------|
| C0.1..... | TITLE SHEET |
| C1.1..... | EXISTING CONDITIONS PLAN |
| C2.1..... | SITE DIMENSIONAL PLAN |
| C2.2..... | GRADING & STORMWATER MANAGEMENT PLAN |
| C3.1..... | CONSTRUCTION DETAILS |

SITE SUMMARY

OWNER: Fluvanna County Board of Supervisors
 P.O. Box 299
 Palmyra, VA 22963

CONTACT: John Robins - Public Works Director
TELEPHONE: 434-591-1925
FAX: 434-291-1924

LOCATION: Rt. 53 - Pleasant Grove

JURISDICTION: Fluvanna County

PRESENT ZONING: County Park (CP)

PROPOSED USE: Public Library

LIST OF ABBREVIATIONS

| | | | |
|------|----------------------------------|-------|--|
| A | AREA | MIN. | MINIMUM |
| AC | ACRE(S) | OP | OUTLET PROTECTION |
| AWWA | AMERICAN WATER WORKS ASSOCIATION | PB | PARCEL BOOK |
| CE | CONSTRUCTION ENTRANCE | PSI | POUNDS PER SQUARE INCH |
| CF | CUBIC FEET | PT | POINT OF TANGENCY |
| CG | CURB AND GUTTER | PVC | POLYVINYL CHLORIDE |
| CY | CUBIC YARD | RCP | REINFORCED CONCRETE PIPE |
| D.B. | DEED BOOK | R.D. | ROOF DRAIN |
| DC | DUST CONTROL | R/W | RIGHT-OF-WAY |
| DD | DIVERSION DIKE | SAN. | SANITARY |
| D.I. | DUCTILE IRON | S.F. | SQUARE FOOT (FEET) |
| DI | DROP INLET | S.F. | SILT FENCE |
| DIA | DIAMETER | SPEC. | SPECIFICATION |
| DS | DOWNSPOUT | SS | STREAM BANK STABILIZATION |
| EA | EACH | ST | STORM |
| EL | ELEVATION | ST | SEDIMENT TRAP |
| EX. | EXISTING | STB | STRAW BALE BARRIER |
| FC | FACE OF CURB | STD. | STANDARD |
| F.F. | FINISHED FLOOR | SW | SIDEWALK |
| F.L. | FLOW LINE | SY | SQUARE YARD |
| GS | GROUND SHOT | TBM | TEMPORARY BENCH MARK |
| INV. | INVERT | TC | TOP OF CURB |
| IP | INLET PROTECTION | TCF | TEMPORARY CONSTRUCTION FENCE |
| LAT | LATERAL | TP | TREE PROTECTION |
| LF | LINEAR FOOT (FEET) | TYP. | TYPICAL |
| MAX. | MAXIMUM | VDOT | VIRGINIA DEPARTMENT OF TRANSPORTATION |
| MH | MANHOLE | VESCH | VIRGINIA EROSION AND SEDIMENT CONTROL HANDBOOK |
| | | WW | WATER VALVE |

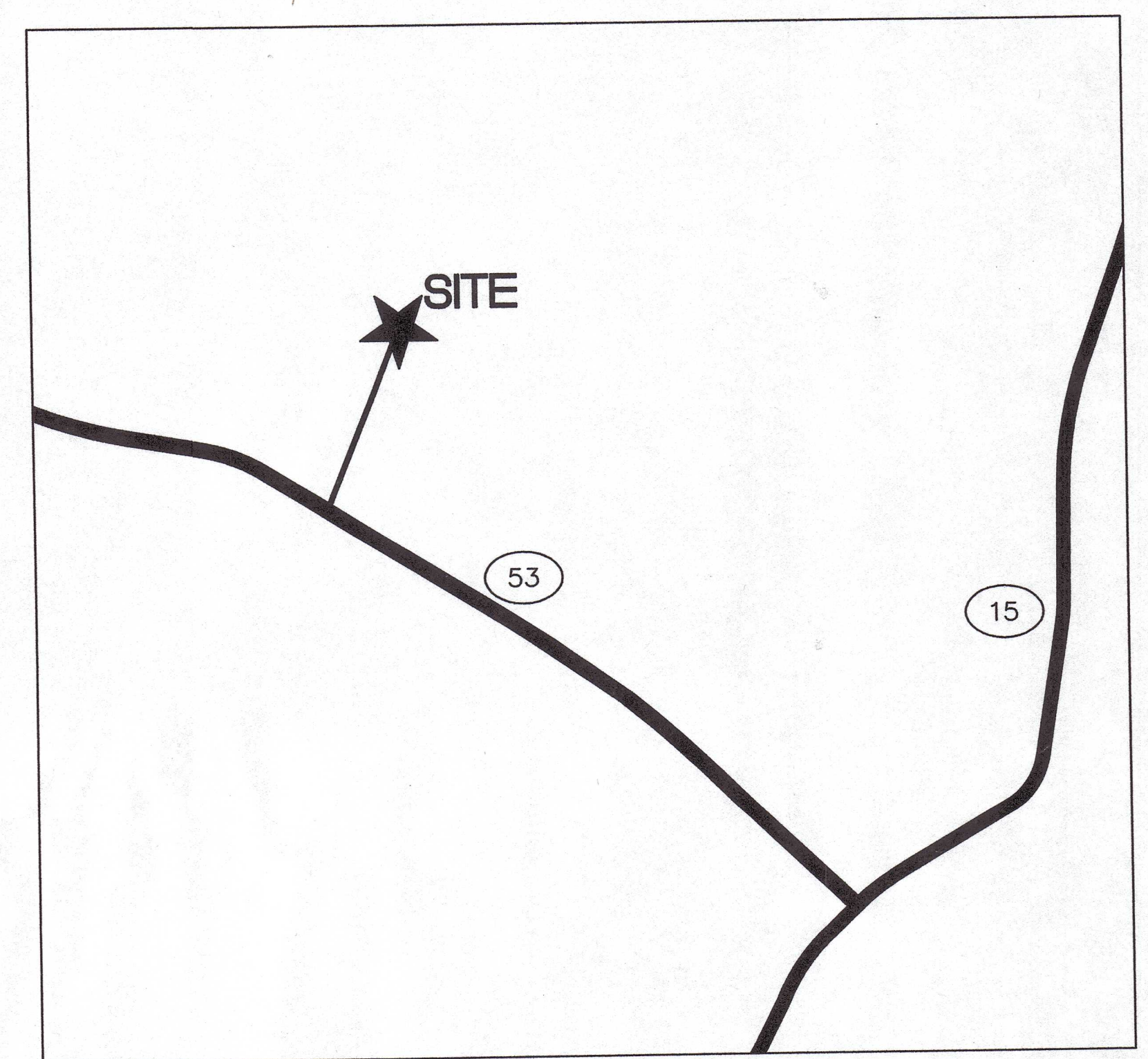

VICINITY MAP
NOT TO SCALE

GENERAL LEGEND

| | |
|---|--|
| EXISTING FEATURES | |
| DECIDUOUS TREE | |
| EVERGREEN TREE | |
| FIRE HYDRANT | |
| WATER METER | |
| UNDERGROUND POWER LINE | |
| COMMUNICATIONS VAULT (CONCRETE) | |
| SANITARY SEWER MANHOLE | |
| SANITARY SEWER LINE (SIZE INDICATED ON PLAN) | |
| SIGNS | |
| WATERLINE | |
| STORM SEWER LINE | |
| STORM SEWER YARD INLETS | |
| STORM SEWER CURB INLETS | |
| STORM SEWER ENDWALL (CONCRETE) | |
| RIPRAP | |
| BIRD HOUSE | |
| CONCRETE | |
| CURB/GUTTER | |
| 5' CONTOUR LINES | |
| 1' CONTOUR LINES | |
| UNDERGROUND GAS LINE (SIZE INDICATED ON PLAN) | |
| PROPOSED FEATURES | |
| STORM DRAIN & MANHOLE | |
| STORM DRAIN END SECTION (ES-1) | |
| STORM DRAIN INLETS | |
| SANITARY SEWER & MANHOLE | |
| CLEANOUT | |
| WATERLINE (SIZE) | |
| WATER VALVE | |
| FIRE HYDRANT | |
| CONTOUR LINE | |
| ASPHALT PAVEMENT | |
| SIGN | |

APPROVALS

DESIGNED BY: _____
 DEPARTMENT OF PLANNING AND COMMUNITY DEVELOPMENT

DRAWN BY: _____
 DEPARTMENT OF PUBLIC WORKS

CHECKED BY: _____
 FIRE OFFICER

DATE: _____
 VIRGINIA DEPARTMENT OF HEALTH

APPROVED BY: _____
 BUILDING OFFICIAL

SEPTEMBER 12, 2007
 DAA PROJECT # CV06175-01

These documents, including drawings and specifications, were prepared by Draper Aden Associates, Consulting Engineers, pursuant to a contract by and between Draper Aden Associates and Fluvanna County with respect to the project described in said contract. Any reuse or modification of said documents (whether hard copy or electronic) without written verification or adaptation by Draper Aden Associates for the specific purpose intended will be at the sole risk of the individual or entity utilizing said documents, drawings and specifications and such use is without the authorization of Draper Aden Associates. Draper Aden Associates, Consulting Engineers, shall have no legal liability resulting from any and all claims, damages, losses, and expenses, including attorney's fees arising out of the unauthorized use of these documents, drawings, specifications, reports, and studies prepared as a result of the aforesaid contract.

NOTE: CONTRACTOR TO CONTACT MISS UTILITY (1-800-552-7001) AT LEAST 3 WORKING DAYS IN ADVANCE OF PLANNED WORK.



| REVISIONS |
|----------------------------|
| DESIGNED BY: GWC |
| DRAWN BY: GCJ |
| CHECKED BY: GWC |
| SCALE: NOT TO SCALE |
| DATE: SEPTEMBER 12, 2007 |
| PROJECT NUMBER: CV06175-01 |
| C0.1 |

LOCAL: \\p0601001\CV06175-01\CV06175-01\DWG\C00175-01.DWG DATE: 9/12/07 10:28:24 AM

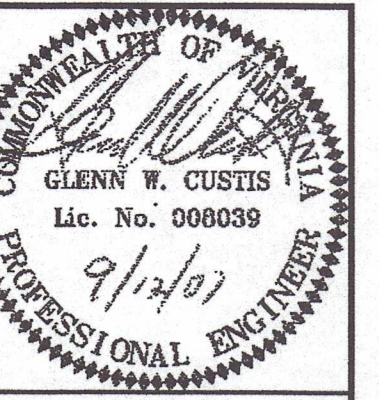

Draper Aden Associates
 Engineering • Surveying • Environmental Services
 Charlottesville, VA
 700 Harris Street, Suite E
 Charlottesville, VA 22903
 434-262-0700 Fax: 434-262-2105
 www.daa.com

Blacksburg, VA
 Richmond, VA
 Hampton Roads, VA

EXISTING CONDITIONS PLAN
FLUVANNA COUNTY PUBLIC LIBRARY
 FLUVANNA COUNTY, VIRGINIA

| REVISIONS | |
|-----------------|--------------------|
| DESIGNED BY: | DAA |
| DRAWN BY: | GCJ |
| CHECKED BY: | GWC |
| SCALE: | 1" = 40' |
| DATE: | SEPTEMBER 12, 2007 |
| PROJECT NUMBER: | CV06175-01 |
| C1.1 | |

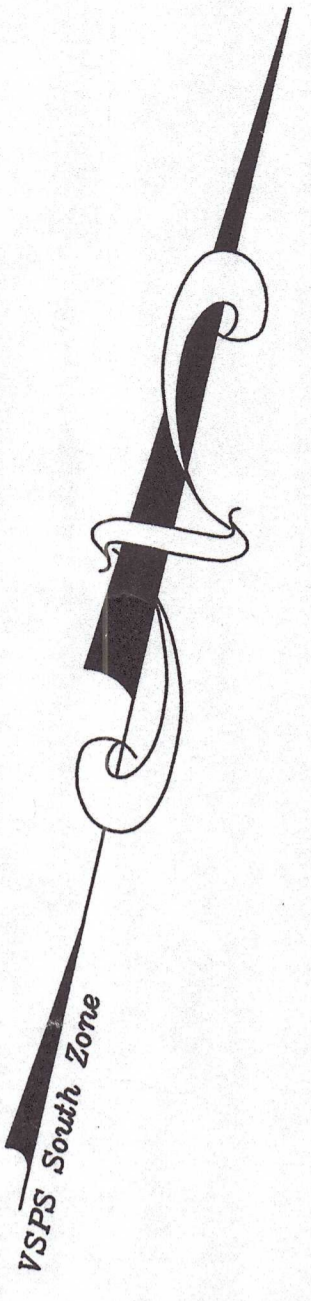

SURVEY LIMITS

- LEGEND**
- Deciduous Tree
 - Light Pole
 - 2' Contour Lines
 - 10' Contour Lines
 - Limits of Topo
 - Electric Box
 - Sign
 - Telephone Pedestal

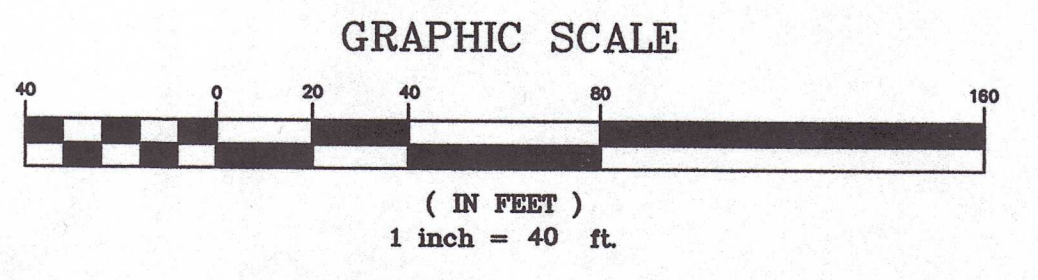
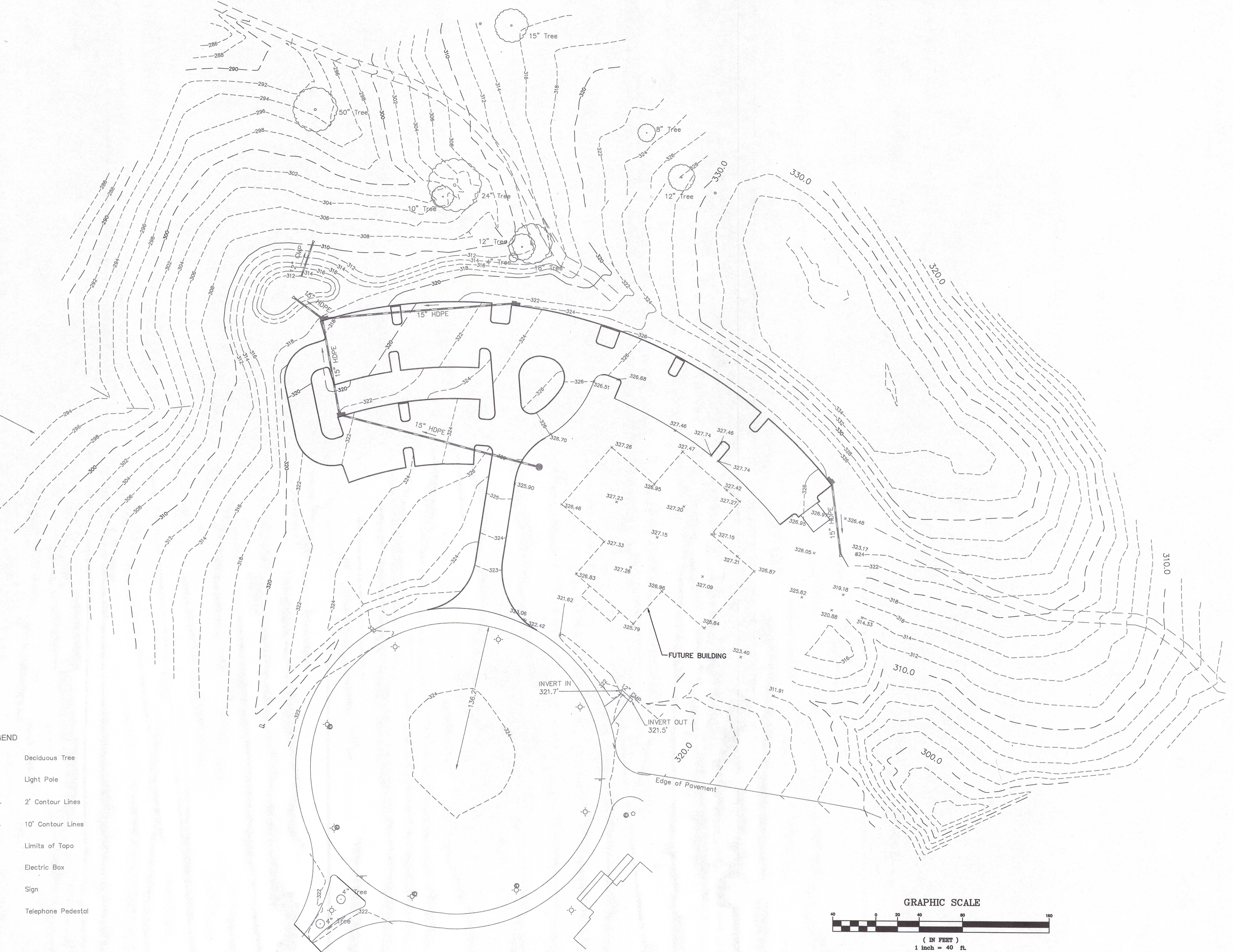

I:\Projects\CV06175-01\Drawings\CV06175-01-C1.1.dwg September 18, 2007 10:27:27 AM

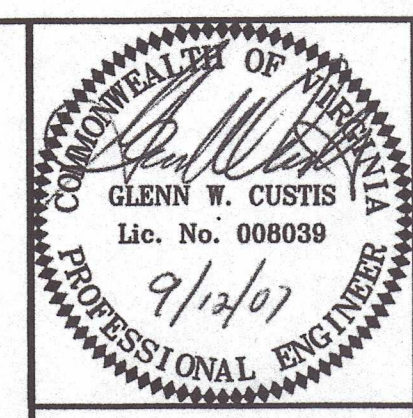

Draper Aden Associates
 Engineering • Surveying • Environmental Services
 Charlottesville, VA
 700 Harris Street, Suite E
 Charlottesville, VA 22902
 434-255-4400
 www.daa.com



SITE DIMENSIONAL PLAN
FLUVANNA COUNTY PUBLIC LIBRARY
 FLUVANNA COUNTY, VIRGINIA

| | |
|-----------------|--------------------|
| DESIGNED BY: | DAA |
| DRAWN BY: | JAC |
| CHECKED BY: | GWC |
| SCALE: | 1" = 40' |
| DATE: | SEPTEMBER 12, 2007 |
| PROJECT NUMBER: | CV06175-01 |
| C2.1 | |

- NOTES:**
1. ASPHALT PAVING IS NOT INCLUDED IN THIS CONTRACT.(N.I.C)
 2. STANDARD PARKING SPACES SHALL BE 9.0' WIDE x 18.0' LONG. HANDICAPPED ACCESSIBLE PARKING SPACES SHALL BE 8.0' WIDE x 18.0' LONG, PAINTED AS SHOWN.(N.I.C.)
 3. PARKING: 102 SPACES + 5 H.C. SPACES = 107 TOTAL SPACES
 4. RADII ARE TO FACE OF CURB AND ARE 3.0', UNLESS NOTED OTHERWISE.

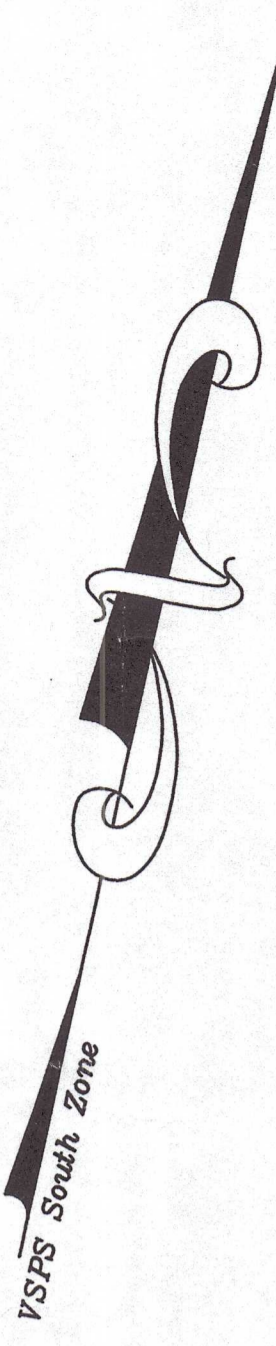

SURVEY LIMITS

- LEGEND**
- Deciduous Tree
 - Light Pole
 - 2' Contour Lines
 - 10' Contour Lines
 - Limits of Topo
 - Electric Box
 - Sign
 - Telephone Pedestal

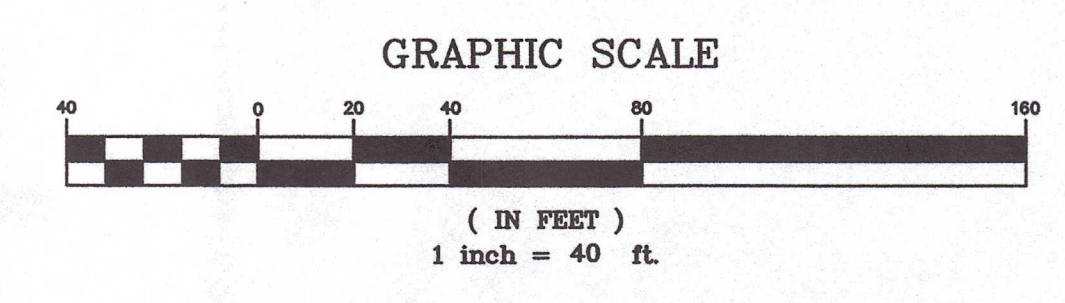
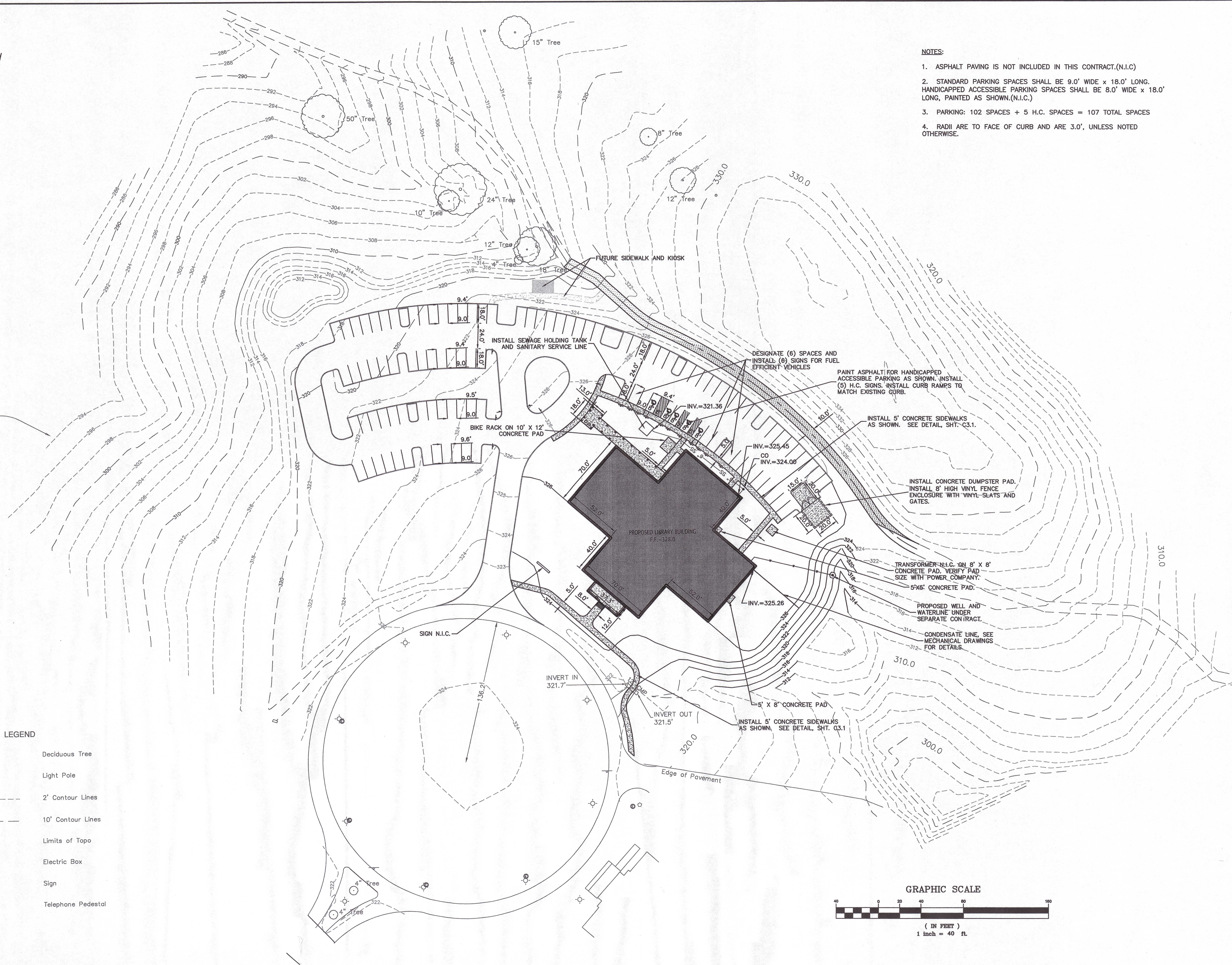

C:\msd\projects\CV06175-01\CV06175-01.dwg (CV06175-01) BETA.JAMling September 12, 2007 10:54:52 AM

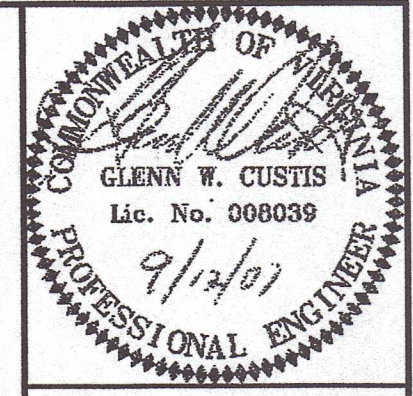

Draper Aden Associates
 Engineering • Surveying • Environmental Services
 Charlottesville, VA
 700 Harris Street, Suite 2003
 434-295-0700 Fax: 434-295-2105
 www.daa.com

Blackburg, VA
 Richmond, VA
 Hampton Roads, VA

GRADING & STORMWATER MANAGEMENT PLAN
FLUVANNA COUNTY PUBLIC LIBRARY
 FLUVANNA COUNTY, VIRGINIA

| | |
|-----------------|--------------------|
| DESIGNED BY: | DAA |
| DRAWN BY: | JAC |
| CHECKED BY: | GWC |
| SCALE: | 1" = 40' |
| DATE: | SEPTEMBER 12, 2007 |
| PROJECT NUMBER: | CV06175-01 |
| G2.2 | |

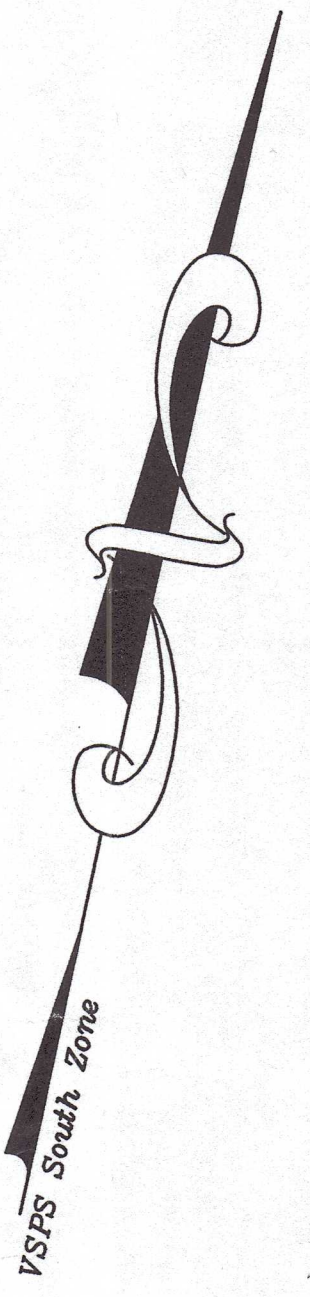

SURVEY LIMITS

- LEGEND**
- Deciduous Tree
 - Light Pole
 - 2' Contour Lines
 - 10' Contour Lines
 - Limits of Topo
 - Electric Box
 - Sign
 - Telephone Pedestal

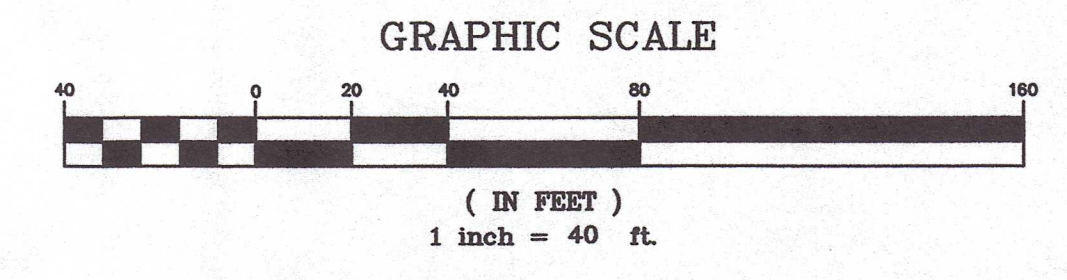
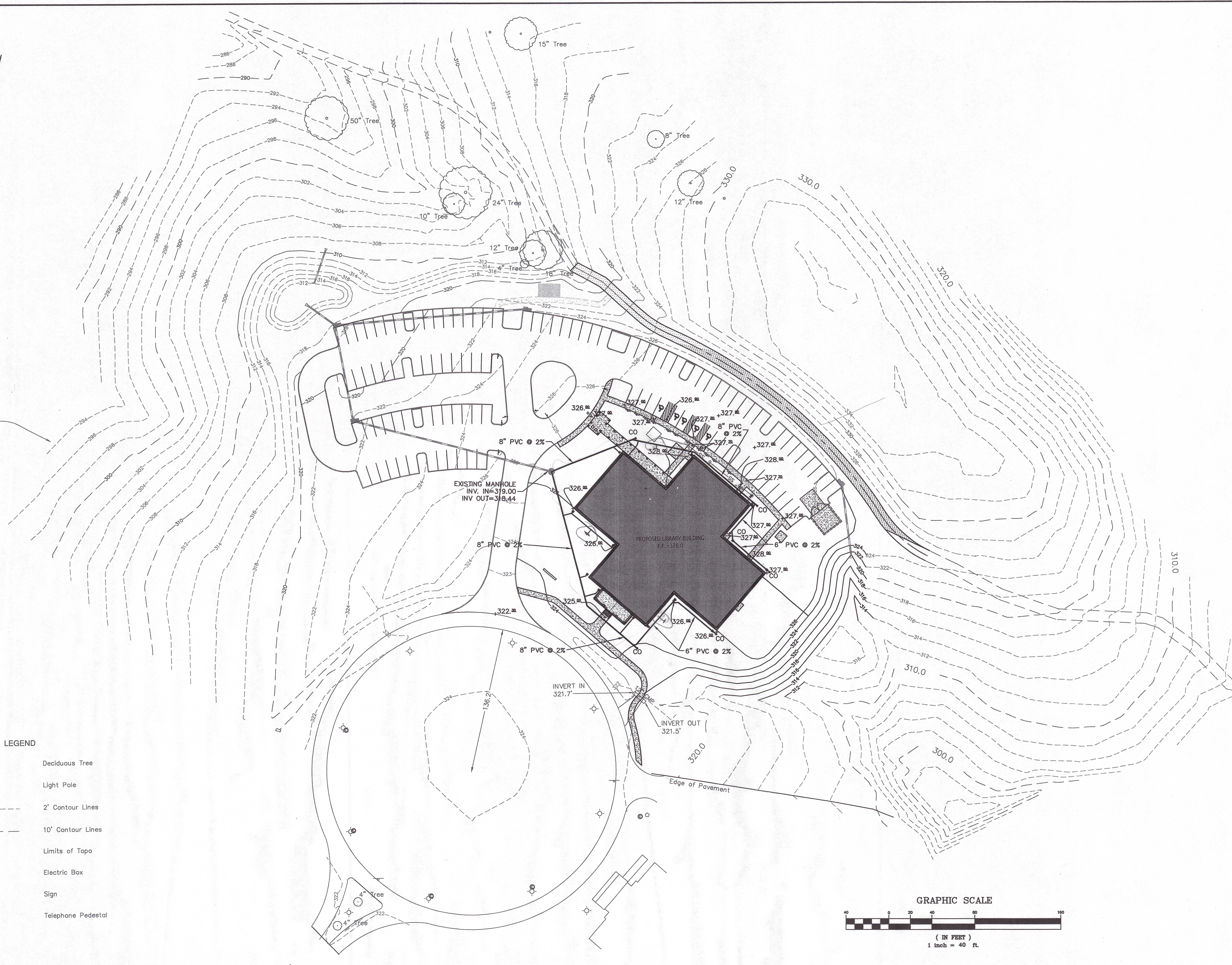

I:\Projects\CV06175-01\Drawings\CV06175-01-GM\G2.2.dwg September 18, 2007 10:51:11 AM

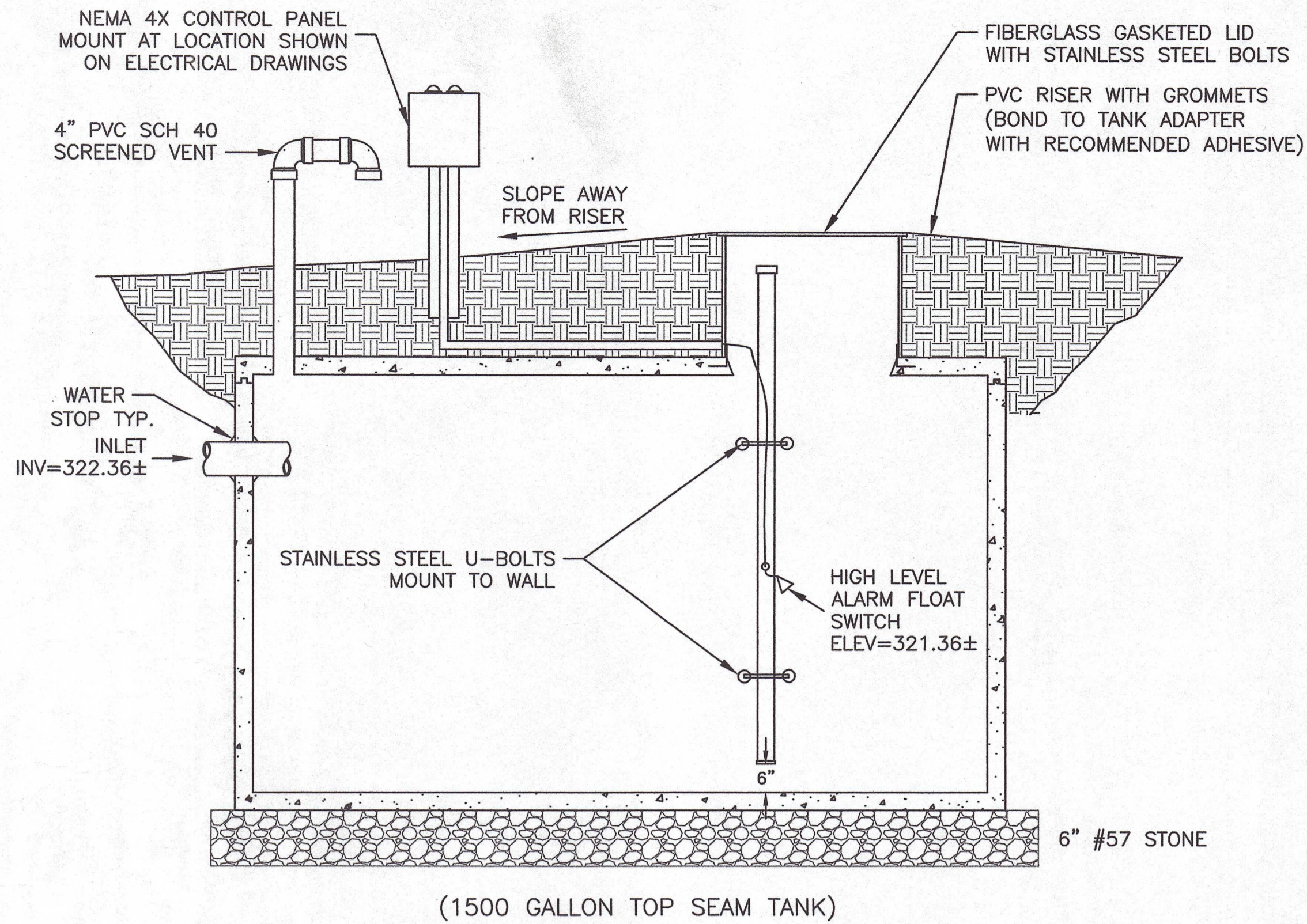

(1500 GALLON TOP SEAM TANK)

1
C3.1 HOLDING TANK DETAIL

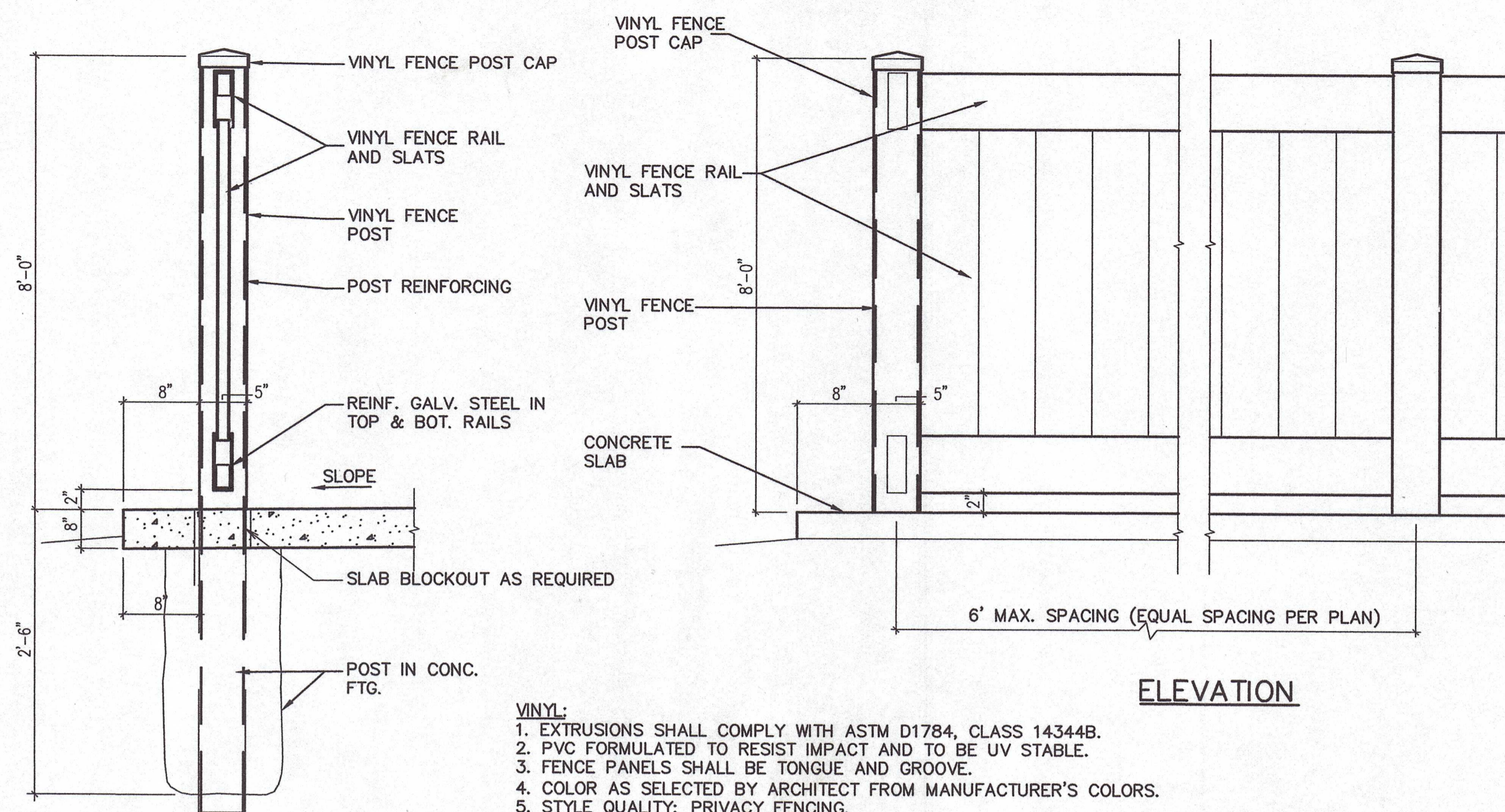

SECTION

ELEVATION

3
C3.1 DUMPSTER PAD ENCLOSURE

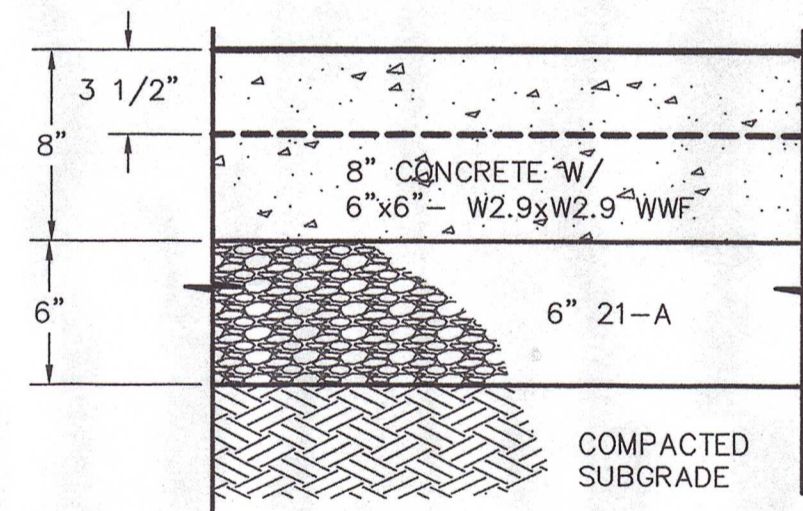

NOTE:
PLACE CONTRACTION JOINTS AT 15' O.C.

4
C3.1 DUMPSTER PAD SLAB SECTION

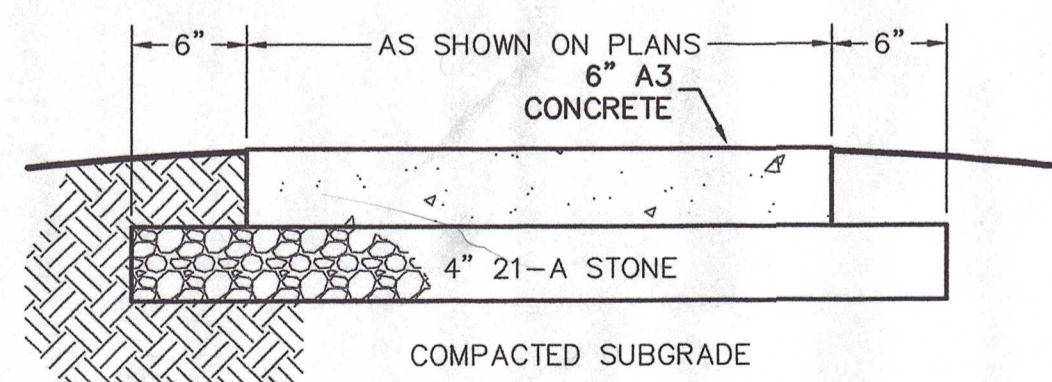

- NOTES:
1. TRANSVERSE EXPANSION JOINTS ARE TO BE PLACED A MAXIMUM OF 30' ON CENTER.
 2. TRANSVERSE CONTROL JOINTS ARE TO BE PLACED AT 5' ON CENTER BETWEEN EXPANSION JOINTS.
 3. LONGITUDINAL JOINTS ARE REQUIRED FOR SIDEWALKS WITH WIDTHS GREATER THAN 10'. LONGITUDINAL JOINTS SHALL BE PLACED AT EQUAL INTERVALS NOT TO EXCEED 10' IN WIDTH.

TYPICAL SIDEWALK SECTION

2
C3.1 SIDEWALK AND PAVEMENT DETAILS

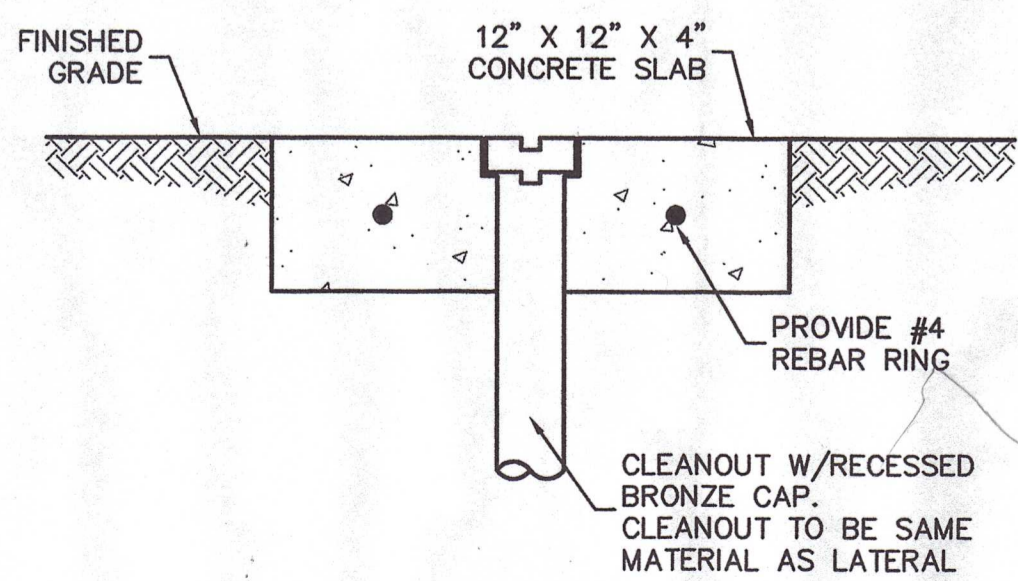

5
C3.1 CLEANOUT IN GRASSED AREA

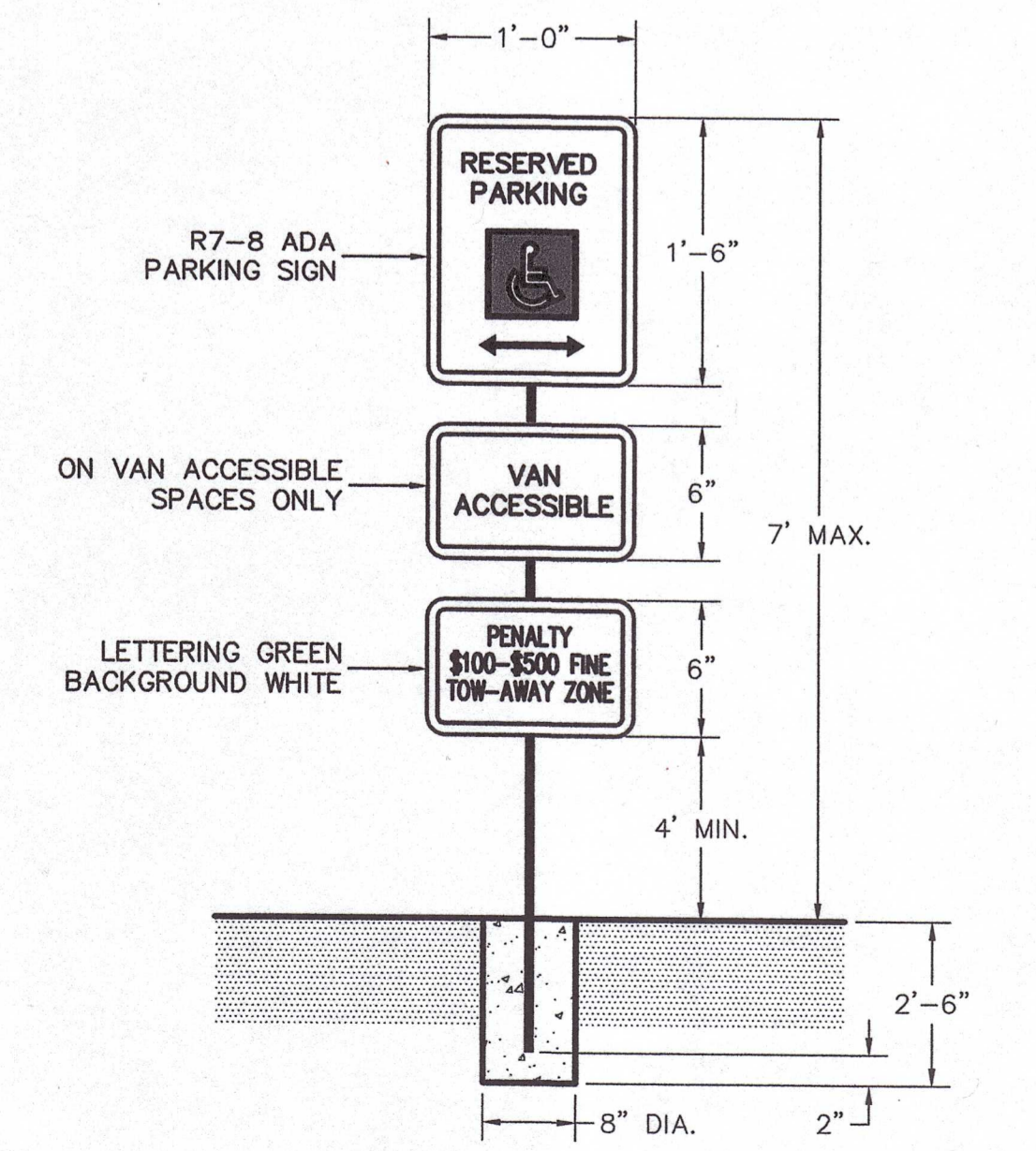

6
C3.1 HANDICAPPED VAN ACCESSIBLE SIGN

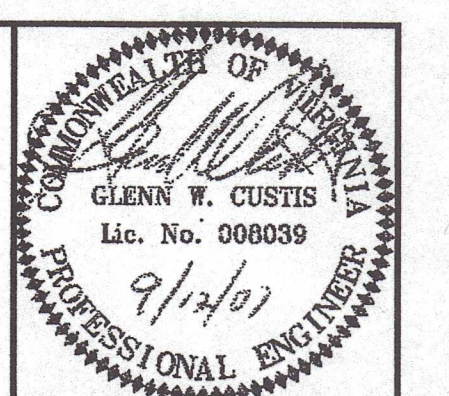

Draper Aden Associates
 Engineering • Surveying • Environmental Services
 Charlottesville, VA
 700 Harris Street, Suite E
 Charlottesville, VA 22903
 434-295-0700 Fax: 434-295-2105
 www.daa.com



CONSTRUCTION DETAILS
FLUVANNA COUNTY PUBLIC LIBRARY
 FLUVANNA COUNTY, VIRGINIA

| REVISIONS | |
|-----------------|--------------------|
| DESIGNED BY: | DAA |
| DRAWN BY: | JAC |
| CHECKED BY: | GWG |
| SCALE: | NOT TO SCALE |
| DATE: | SEPTEMBER 12, 2007 |
| PROJECT NUMBER: | CV06175-01 |

C3.1

C:\Users\jacob\Documents\CV06175-01\Drawings\CV06175-01\DWG\C3.1\DETAILS.dwg September 13, 2007 10:59 AM

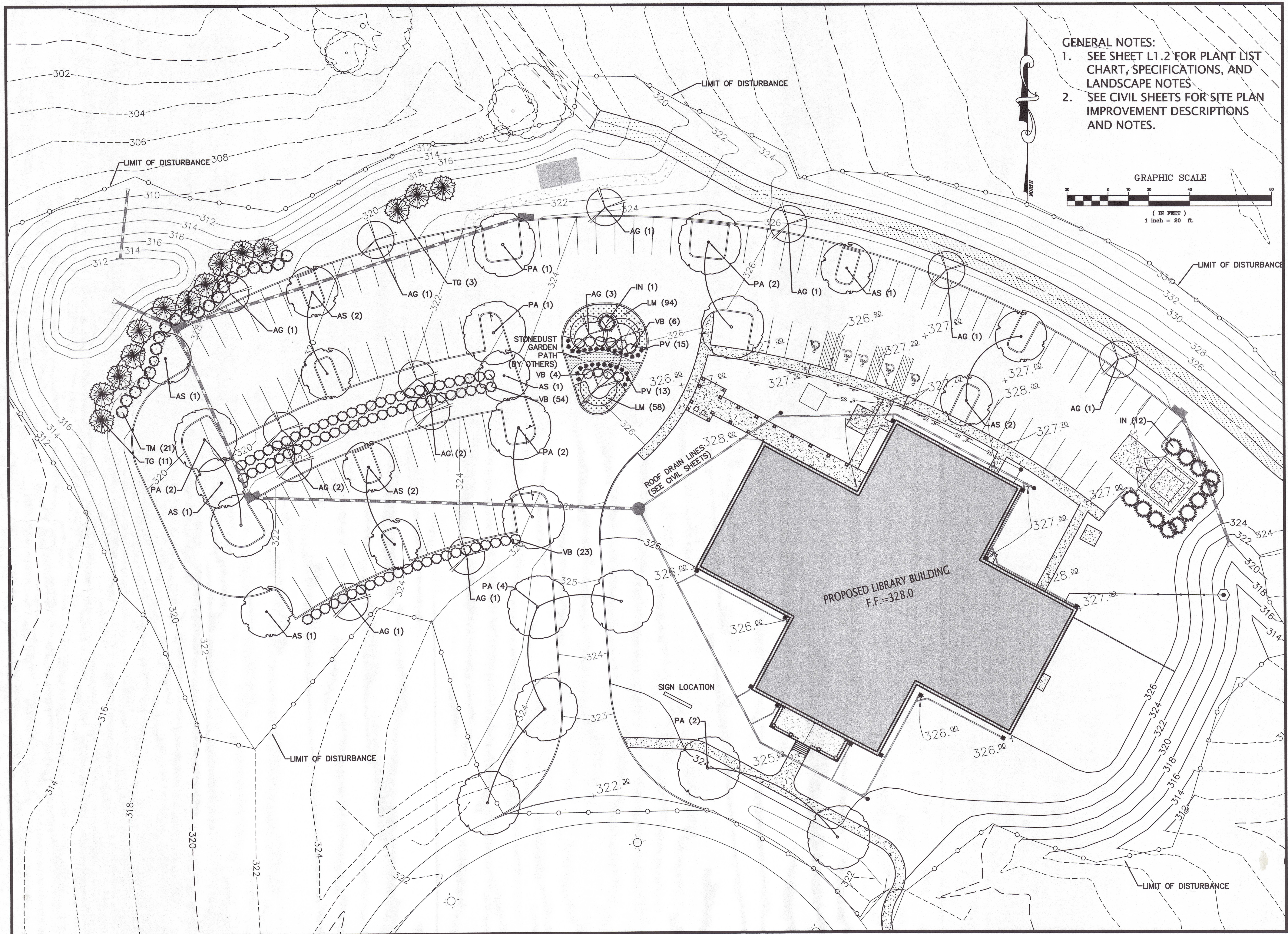

GENERAL NOTES:
 1. SEE SHEET L1.2 FOR PLANT LIST CHART, SPECIFICATIONS, AND LANDSCAPE NOTES
 2. SEE CIVIL SHEETS FOR SITE PLAN IMPROVEMENT DESCRIPTIONS AND NOTES.

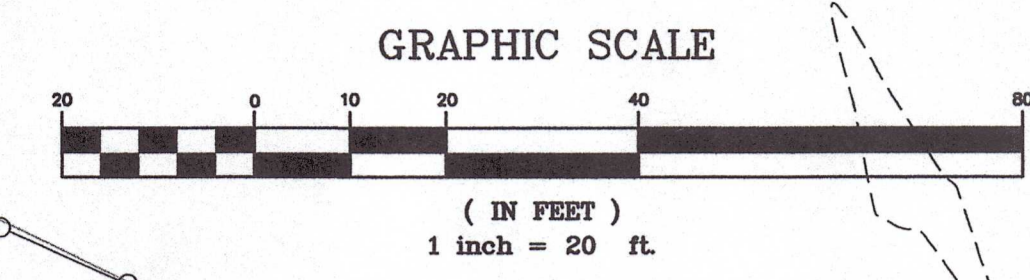

NO. REVISIONS DATE

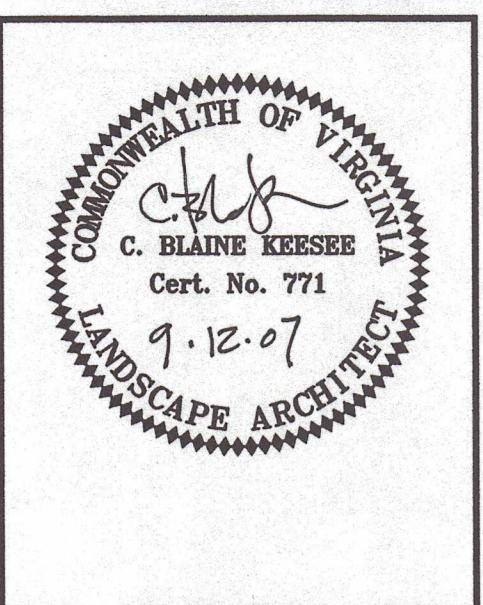

Draper Aden Associates
 Engineering • Surveying • Environmental Services
 700 Harris Street, Suite E
 Blacksburg, VA 22603
 Charlottesville, VA 22903
 434-295-0700 Fax: 434-295-5105

FLUVANNA COUNTY PUBLIC LIBRARY
 FLUVANNA COUNTY, VIRGINIA
 PLANTING PLAN

REYNOLDS ARCHITECTS INCORPORATED
 BLACKSBURG, VIRGINIA

| | | | |
|----------|---------|-------------|-----|
| DESIGNED | MSL | DRAWN | MSL |
| CHECKED | CBK | APPROVED | CBK |
| PROJECT | 0422 | L1.1 | |
| DATE | 9-12-07 | | |

TREE PLANTING SPECIFICATIONS:

- ALL TREES SHALL BE PLANTED IN GOOD CONDITION AND MEET 'AMERICAN STANDARD FOR NURSERY STOCK' (1990), ANSI Z60.1-1990, AS MAY BE AMENDED.
- THE PLANTING OF TREES SHALL BE DONE IN ACCORDANCE WITH THE STANDARDIZED LANDSCAPE SPECIFICATION JOINTLY ADOPTED BY THE NURSERYMAN'S ASSOCIATION, THE VA SOCIETY OF LANDSCAPE DESIGNERS AND THE VA CHAPTER OF THE AMERICAN SOCIETY OF LANDSCAPE ARCHITECTS.
- PRIOR TO ARRIVAL OF PLANT MATERIALS TO SITE NOTIFY OWNER'S REPRESENTATIVE 48 HOURS BEFORE ARRIVAL TO SITE. ALL PLANT MATERIALS MUST BE APPROVED AND INSPECTED BY OWNER'S REPRESENTATIVE AND ACCEPTED PRIOR TO INSTALLATION.
- PLANTING TIMING: UNLESS OTHERWISE SHOWN ON THE PLANS OR DIRECTED BY THE OWNER'S REPRESENTATIVE, THE PLANTING SHALL BE DONE DURING THE FOLLOWING SEASONS FOR ALL TREES, SHRUBS, AND GROUNDCOVERS:
 - SEPTEMBER 1 TO DECEMBER 15 OR
 - FEBRUARY 15 TO MAY 15.
 - PLANTING AT OTHER DATES WILL BE SUBJECT TO APPROVAL BY THE OWNER'S REPRESENTATIVE AND MAY REQUIRE SPECIAL PROCEDURES.
- REFER TO DRAWINGS FOR VARIETIES, LAYOUT, AND SPACING OF PLANT MATERIALS. QUANTITIES SHOWN ON DRAWINGS SHALL TAKE PRECEDENCE OVER QUANTITIES SHOWN ON THE PLANT LIST.
- ALL DISTURBED AREAS NOT OTHERWISE HARDCAPED, ARE TO BE SOD OR SEEDED AS SPECIFIED.
- EVERGREEN VEGETATION REQUIRED FOR SCREENING SHALL BE MAINTAINED IN GOOD CONDITION AND ALLOWED TO GROW AT LEAST 6 FEET IN HEIGHT FOR SMALL TREES, AND 10 FEET FOR LARGE EVERGREEN TREES.
- MOVE AND LIFT TREES, SHRUBS, AND PLANTS BY THE ROOTBALL ONLY AND NEVER BY THE TRUNK OR STALK.
- IF SYNTHETIC OR METAL WRAPPING IS USED ON ANY ROOTBALL, REMOVE IT ENTIRELY BEFORE PLANTING. METAL CAGES MUST ALSO BE REMOVED ENTIRELY FROM THE ROOTBALL.
- CUT, TRIM AND REMOVE THE TOP 6"-9" OF NATURAL BURLAP WRAPPING FROM ROOTBALL PRIOR TO FINAL PLANTING SOIL BACKFILLING.
- WATERING OF PLANTS: WATERING IS TO PROVIDE VIGOROUS PLANT GROWTH AND SHALL BE SUFFICIENT TO MAINTAIN MOISTURE IN THE ENTIRE ROOT ZONE.
 - WATERING OF PLANT MATERIAL SHALL OCCUR IMMEDIATELY AFTER PLANTING AND WITHIN IN 24 HOURS OF INSTALLATION. THE FIRST WATERING SHALL FLOOD THE PLANTING HOLE TO REMOVE AIR POCKETS AND SATURATE THE SOIL.
 - WATERING SHALL CONTINUE EACH DAY FOR ONE WEEK FROM INSTALLATION AT A RATE OF 2 GALLONS PER INCH TREE CALIPER.
 - AFTER THE FIRST WEEK OF WATERING, WATERING SHALL CONTINUE ON A WEEKLY BASIS UNTIL PLANTS ARE FULLY ESTABLISHED. WEEKLY WATERING SHALL BE AT A RATE OF 2 GALLONS PER INCH OF TREE CALIPER.
- ALL PLANTS SHALL BE GUARANTEED TO REMAIN ALIVE AND HEALTHY FOR A PERIOD OF ONE YEAR BEGINNING FROM THE DATE OF INSPECTION BY THE OWNER'S REPRESENTATIVE AND A WRITTEN FIELD REPORT STATING OWNER ACCEPTANCE FOR PLANTS THAT MEET QUALITY STANDARDS, PLANTING SPECIFICATIONS, PROPER LAYOUT PLACEMENT, AND EXHIBIT A HEALTHY VIGOROUS GROWTH.
 - PLANTS THAT ARE EXHIBITING 25 PERCENT OR MORE DEAD GROWTH OR DO NOT MEET THE PLANT MATERIAL QUALITY SPECIFICATIONS SHALL BE REPLACED IMMEDIATELY OR UPON THE NEXT PLANTING SEASON WHICHEVER IS SOONER.
 - NEW PLANTS, REQUIREMENTS, ETC. AND METHOD OF PLACING SHALL COMPLY WITH THESE SPECIFICATIONS AND DRAWINGS. PLANTS REPLACING DEAD PLANTS SHALL ALSO BE GUARANTEED TO REMAIN ALIVE AND HEALTHY FOR ONE FULL YEAR AND RECEIVE THE SAME CARE AND MEET SPECIFICATIONS.
 - WARRANTY SHALL BE LIMITED TO ONE REPLACEMENT PER PLANT.
 - CONFORMANCE OF PLANTING LAYOUT TO PLANTING PLAN MUST BE APPROVED BY THE OWNER'S REPRESENTATIVE PRIOR TO INSTALLATION. PLANTS NOT PROPERLY LOCATED AS SHOWN ON THE PLANTING PLAN SHALL BE REPLANTED TO THE PROPER LOCATION AT THE EXPENSE OF THE CONTRACTOR.
- PLANTING HOLE SHALL BE 3 TIMES LARGER THAN THE SIZE OF THE ROOT BALL DIAMETER. SCARIFY BOTTOM AND EDGES OF PLANTING PIT SUFFICIENTLY TO ALLOW BONDING OF THE PLANTING SOIL AND EXISTING SOIL.
- ALL PLANTS SHALL BE MULCHED WITH A 3" MULCH LAYER WITHIN 24 HOURS OF PLANTING. MULCH SHALL BE DOUBLE-SHREDDED HARDWOOD BARK MULCH AND SHALL COVER THE PLANTING BED ENTIRELY, EXCEPT FOR A ONE INCH CLEAR SPACE AROUND THE TRUNK SHALL REMAIN FREE FROM MULCH.
- WATERING BERM: CONSTRUCT A 4" MIN. SOIL BERM AROUND EVERY TREE PLANTING, SAUCERS WILL BE ESTABLISHED AT PLANTING TO HOLD WATERING, SAUCERS ARE TO BE MAINTAINED UNTIL PLANTS ARE FULLY ESTABLISHED, 2 YEARS.
- TREE STAKING SHALL BE REQUIRED FOR PLANTS TALLER THAN 6 FEET AND WITH A TREE CALIPER GREATER THAN 1". USE TWO 3" DIA. OR 2"x2" WOOD STAKES 6'-0" LENGTH. STAKES SHALL BE PLACED A MIN. OF 18" INTO ADJACENT GROUND. TREE GUYS SHALL BE "ARBORTIE", A UV DEGRADABLE NYLON WEBBING AND INSTALLED PER MANUFACTURERS RECOMMENDATIONS.
- TREE PLANTING SOIL: SOIL EXCAVATED FROM THE TREE PLANTING PIT SHALL BE USED PRIMARILY. THE UPPER TOP 6" OF PLANTING SOIL AROUND EACH TREE SHALL BE A 8 PARTS EXCAVATED SOIL FROM PIT AND 2 PARTS AMENDED SOILS. AMENDMENT SOIL SHALL BE A FERTILE AND FRIABLE TOPSOIL MIXED WITH SAND, PEAT, WELL-COMPOSTED ORGANIC MATTER OR AN APPROVED MANUFACTURED ORGANIC COMPOST MEDIA. THOROUGHLY MIX THE EXCAVATED SOILS WITH THE AMENDED SOILS PRIOR TO PLACEMENT AROUND THE TREE ROOTBALL. SOILS SHALL BE LIGHTLY COMPACTED SUFFICIENT TO REMOVE AIR POCKETS. WATERING SHALL BE USED TO REMOVE AIR POCKETS DURING INSTALLATION WATERING BY MEANS OF FLOODING THE PLANTING PIT.
- NO STRUCTURES OR PLANTING OF TREES SHALL BE PERMITTED WITHIN 5' OF UTILITIES.
- ALL TREES SHALL BE CHOSEN FROM THE LIST OF RECOMMENDED TREE SPECIES AS IN THE COUNTIES ZONING ORDINANCE, OR AS APPROVED BY THE ZONING ADMINISTRATOR.

Fluvanna County Public Library

Landscape Plant List

DAA Project Number: CV06175-04BB

| Sym | ID | Qty | Botanical Name | Common Name | Size | Spacing | Remarks |
|--------------|----|-----|---|--------------------------------|----------|---------|--|
| Trees | | | | | | | |
| AG | | 15 | Amelanchier X grandiflora 'Autumn Brilliance' | Autumn Brilliance Serviceberry | 6' HT. | | Small Flowering Tree (20x16) |
| AS | | 11 | Acer saccharum 'Green Mountain' | Green Mountain Sugar Maple | 2" Cal. | | Large Deciduous Tree (50x40) |
| IN | | 13 | Ilex x 'Nellie R. Stevens' | 'Nellie R. Stevens' Holly | 6' HT. | 8' OC | Columnar Evergreen Tree (25x10) |
| LM | | 152 | Liriope Muscari 'Big Blue' | 'Big Blue' Liriope | #1 Cont. | 24" OC | Groundcover: 1'x2' spread Ornamental Grass, vibrant violet-blue flowers |
| PA | | 14 | Platanus X acerfolia 'Bloodgood' | London Plane Tree | 2" Cal. | | Large Deciduous Tree (50x40) |
| PV | | 28 | Panicum virgatum 'Shenandoah' | Shenandoah Switch Grass | #1 Cont. | 36" OC | 36" to 48" Height warm season native to VA prairie grass, red-leaved, compact form |
| TG | | 14 | Thuja x 'Gigantoides' | Green Giant Arborvitae | 6' HT. | 12' OC | Large Evergreen Tree (35x12) |
| TM | | 21 | Taxus X media 'Meyeri' | Myer's Yew | 3' HT. | 6' OC | Columnar Evergreen Tree (15x8) |
| VB | | 87 | Viburnum X burkwoodii 'Mohawk' | 'Mohawk' Viburnum | 24" HT. | 5' OC | Semi-Evergreen Shrub (6x6) |

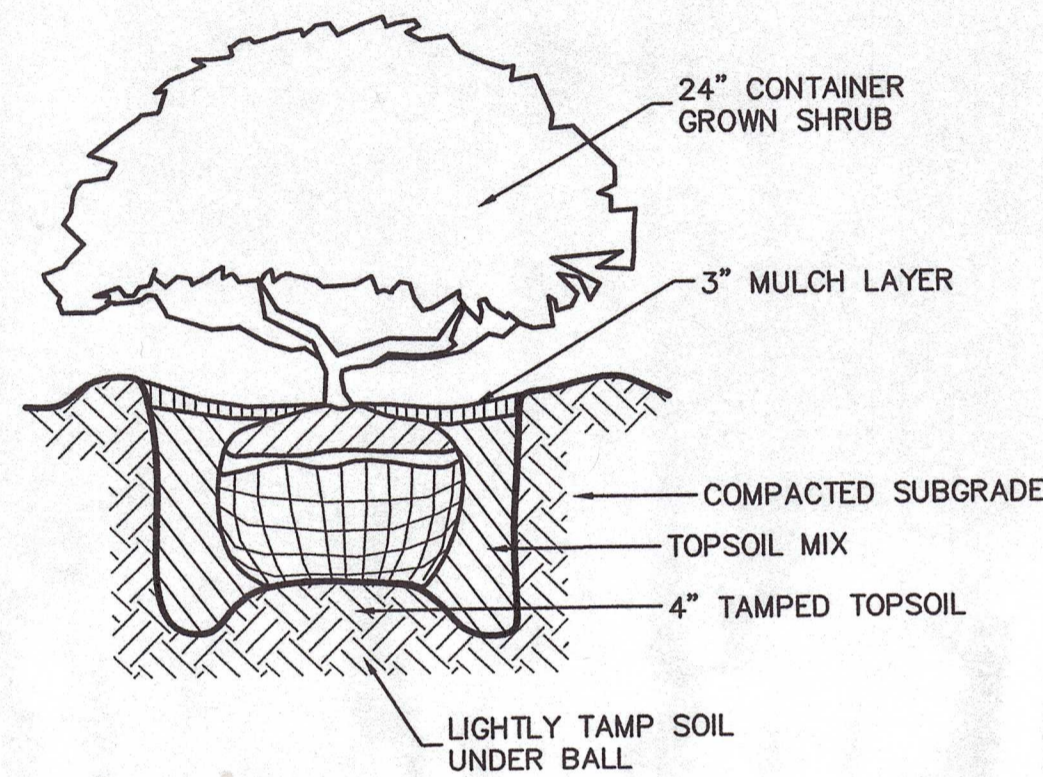

SHRUB PLANTING DETAIL

NO SCALE

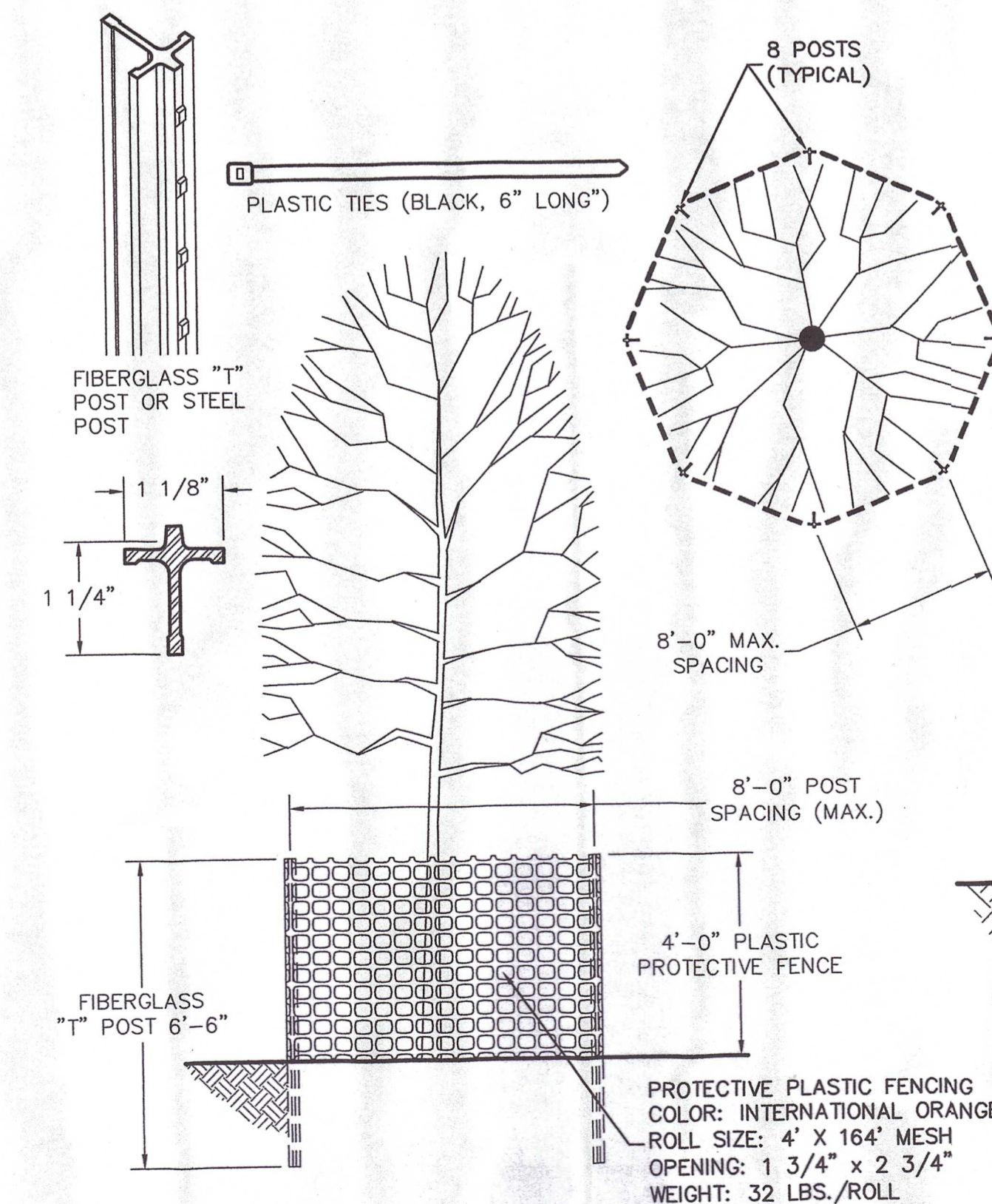

PROTECTIVE PLASTIC FENCING TREE PROTECTION

SEEDING NOTES:

- ALL SEEDING SHALL BE DONE BETWEEN AUGUST 15 AND OCTOBER 15, OR ALTERNATIVELY BETWEEN MARCH 15 AND MAY 1. SEEDING AT OTHER DATES WILL BE SUBJECT TO APPROVAL BY THE OWNER'S REPRESENTATIVE AND MAY REQUIRE SPECIAL PROCEDURES.
- GRASS AREAS SHALL BE SEEDED WITH A SEEDING MIXTURE CONSISTING OF 90% TALL FESCUES (IMPROVED VARIETIES) AND 10% PERENNIAL RYE GRASS (IMPROVED VARIETIES) AS RECOMMENDED ON THE MOST CURRENT VIRGINIA CROP IMPROVEMENT ASSOCIATION (VCIA) TURF GRASS LIST. CERTIFIED SEED WILL BE USED FOR ALL PERMANENT SEEDING. SEEDING AREAS SHALL BE PREPARED IN ACCORDANCE WITH THE ABOVE CITED SPECIFICATION INCLUDING NECESSARY SOIL AMENDMENTS. THE RATE OF COVERAGE FOR BOTH SEED AND AMENDMENTS SHALL BE AS RECOMMENDED BY VCIA.

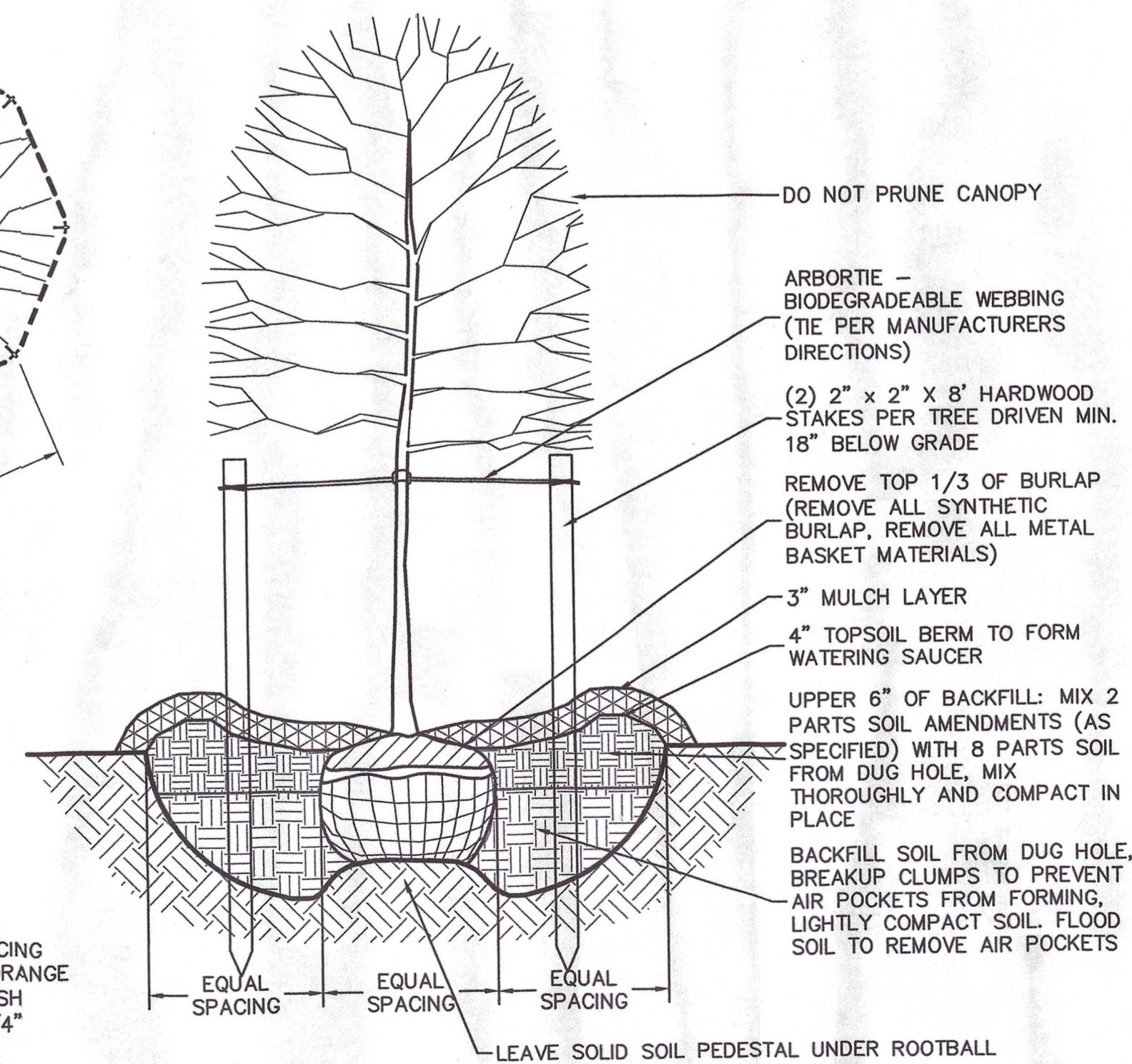

LESS THAN 2.5" CAL. AND LESS THAN 8' HT. SMALL TREE PLANTING DETAIL

NO SCALE

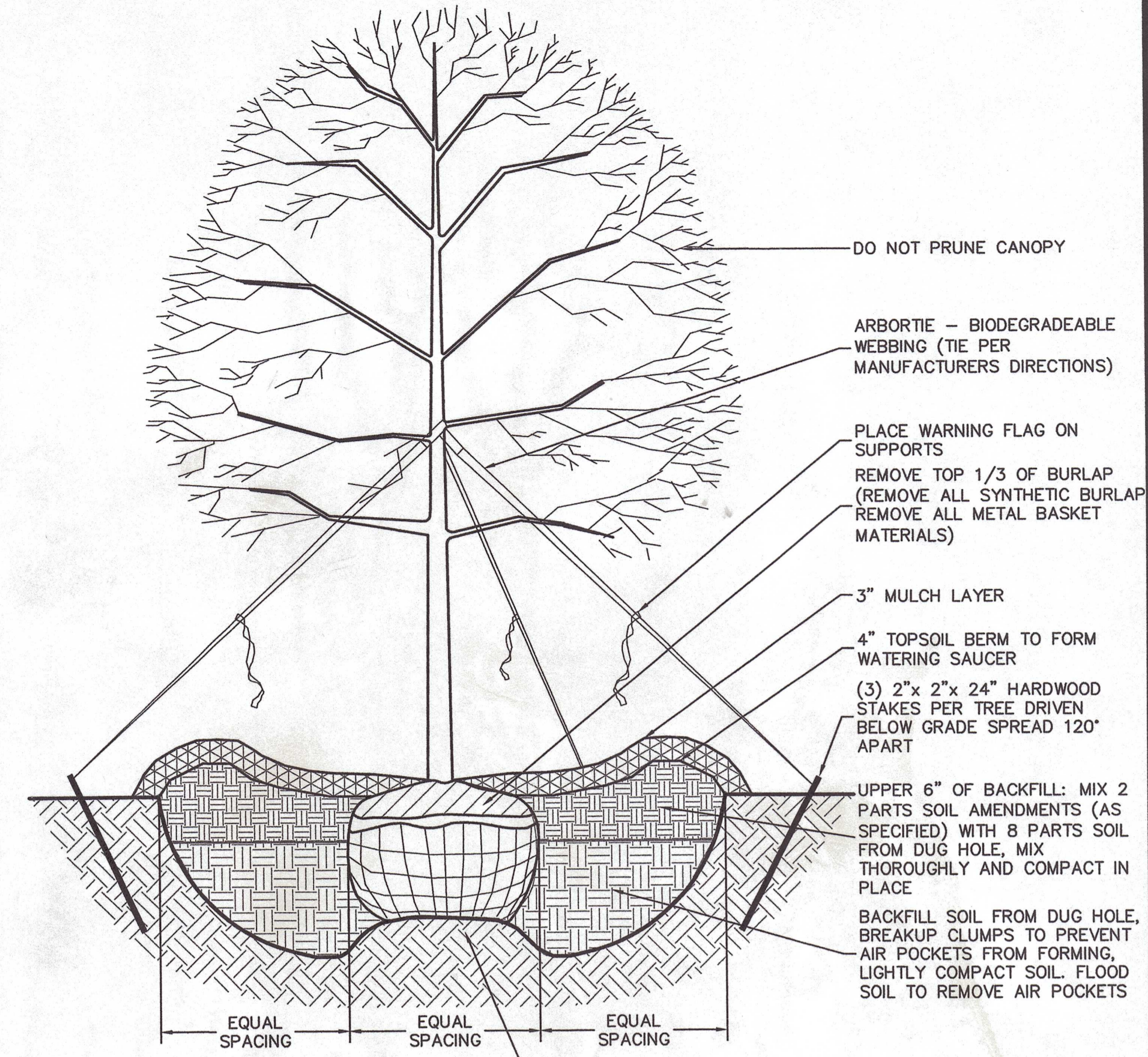

2.5" OR GREATER CAL. TREE PLANTING DETAIL

NO SCALE

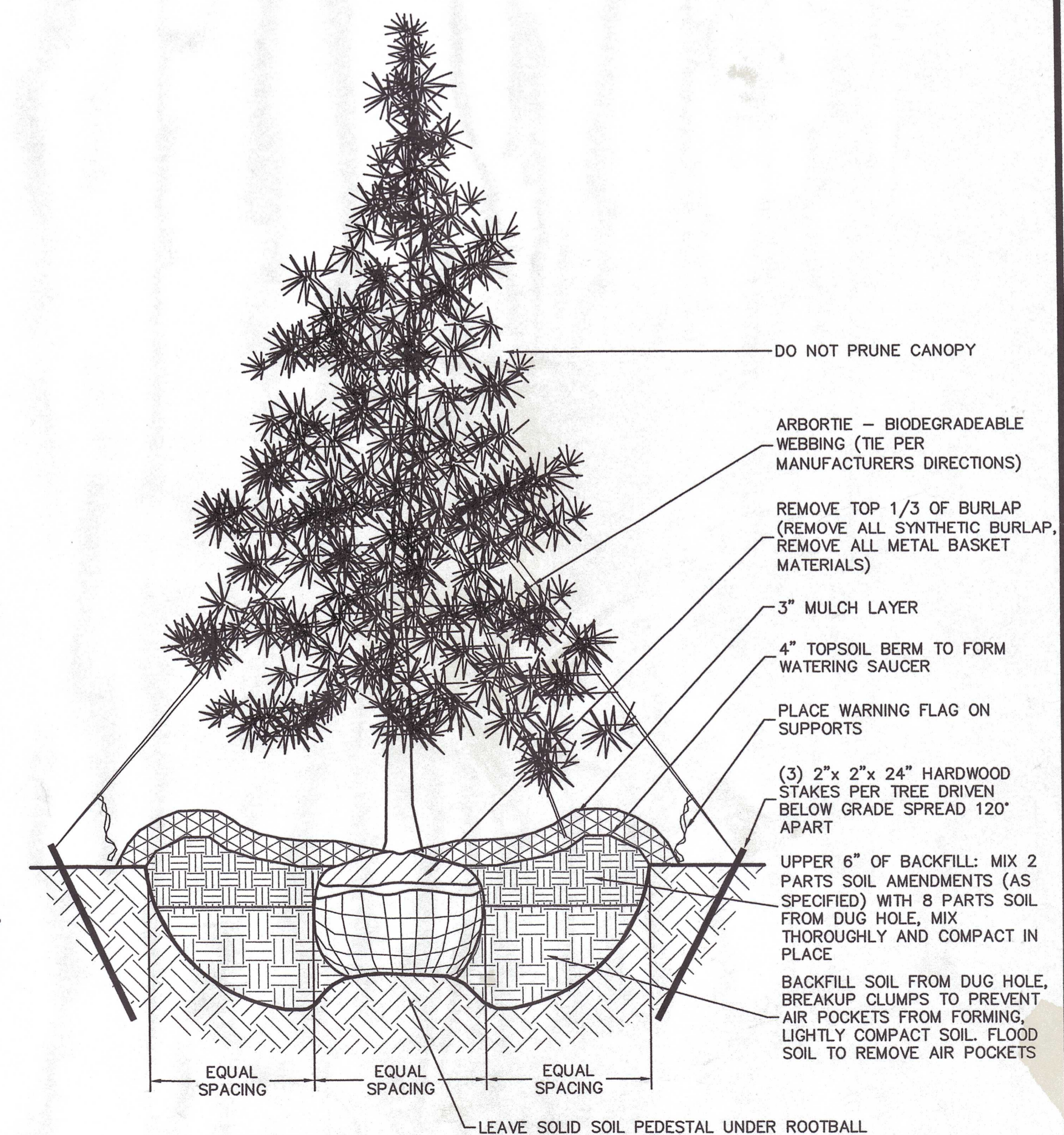

8' OR GREATER HT. EVERGREEN PLANTING DETAIL

NO SCALE

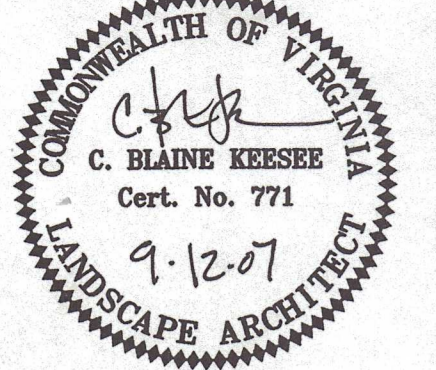

Draper Aden Associates
 Engineering • Surveying • Environmental Services
 700 Harris Street, Suite E
 Blacksburg, VA 24060
 424-268-0700 Fax: 424-295-2105

FLUVANNA COUNTY PUBLIC LIBRARY
 FLUVANNA COUNTY, VIRGINIA

LANDSCAPE DETAILS & NOTES

REYNOLDS ARCHITECTS INCORPORATED
 BLACKSBURG, VIRGINIA

| | | | |
|----------|------|----------|-------------|
| DESIGNED | MSL | DRAWN | MSL |
| CHECKED | CBK | APPROVED | CBK |
| PROJECT | 0422 | DATE | 9-12-07 |
| | | | L1.2 |

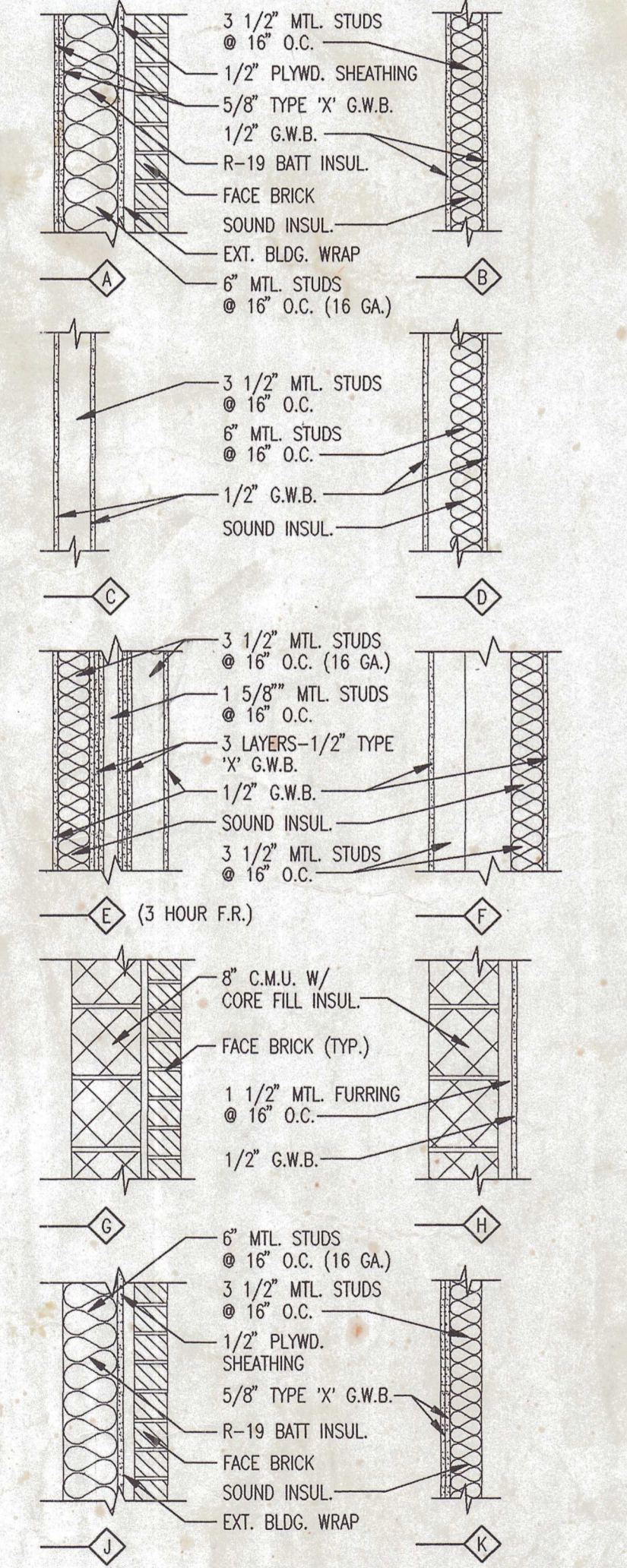
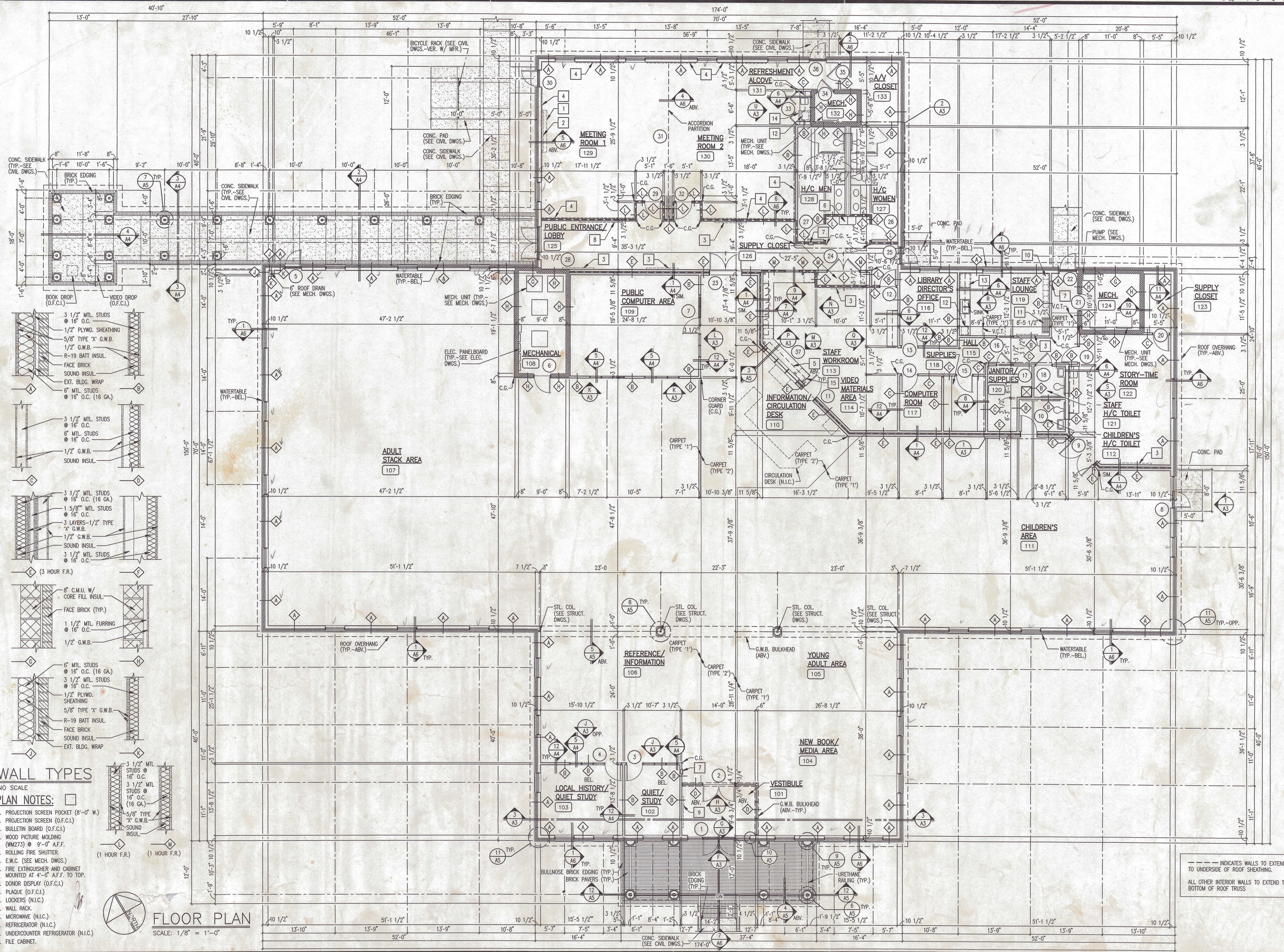

WALL TYPES

NO SCALE

PLAN NOTES:

1. PROJECTION SCREEN POCKET (8'-0" W.)
2. PROJECTION SCREEN (O.F.C.I.)
3. BULLETIN BOARD (O.F.C.I.)
4. WOOD PICTURE MOLDING (WM23) @ 9'-0" A.F.F.
5. ROLLING FIRE SHUTTER.
6. E.W.C. (SEE MECH. DWGS.)
7. FIRE EXTINGUISHER AND CABINET MOUNTED AT 4'-8" A.F.F. TO TOP.
8. DONOR DISPLAY (O.F.C.I.)
9. PLAQUE (O.F.C.I.)
10. LOCKERS (N.I.C.)
11. WALL RACK.
12. MICROWAVE (N.I.C.)
13. REFRIGERATOR (N.I.C.)
14. UNDERCOUNTER REFRIGERATOR (N.I.C.)
15. FILE CABINET.

FLOOR PLAN

SCALE: 1/8" = 1'-0"



FLUVANNA COUNTY PUBLIC LIBRARY
FLUVANNA COUNTY, VIRGINIA

FLOOR PLAN, WALL TYPES AND NOTES



| | |
|--------------|--------------|
| DESIGNED RA | DRAWN DKW |
| CHECKED GPR | APPROVED GPR |
| PROJECT 0422 | A1 |
| DATE 9-12-07 | |

--- INDICATES WALLS TO EXTEND TO UNDERSIDE OF ROOF SHEATHING.
ALL OTHER INTERIOR WALLS TO EXTEND TO BOTTOM OF ROOF TRUSS